

# **A+ MEASUREMENT SERVICES** *and photography*

## **Residential Measurement Report**

April 17, 2021

Our File #: 199RM21



### **Property Civic Address:**

10913 92A Street, Grande Prairie, AB

### **Intended User: Taj Johnson**

Grassroots Realty Group, Grande Prairie, AB

Phone: (780) 897-4621

Email: [taj@grassrootsrealtygroup.ca](mailto:taj@grassrootsrealtygroup.ca)

**Intended Use:** To provide LFA measurements in accordance with the RMS (Residential Measurement Standard) implemented by RECA (Real Estate Council of Alberta)

### **Prepared by:**

**Teresa Anderson, AIC Candidate Member**

Direct: (780) 512-6271

All measurements completed by A+ Measurement Service using the Residential Measurement Standard (RMS) guidelines as set forth by the Real Estate Council of Alberta (RECA). Pursuant to RMS guidelines, the total area is based on the area inside the allowable perimeter of the house or condominium, not by adding up the room areas; and DOES NOT include garages, decks, porches, patios, "open to below" areas, cantilevers with non-walkable space, plant ledge windows, or any area with a ceiling height less than 5'-0". For more information on the RMS guide, please visit [www.reca.ca](http://www.reca.ca)

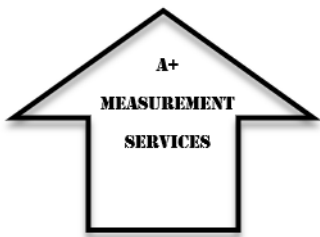

# A+ MEASUREMENT SERVICES

*and photography*

## Measurements

10913 92A Street

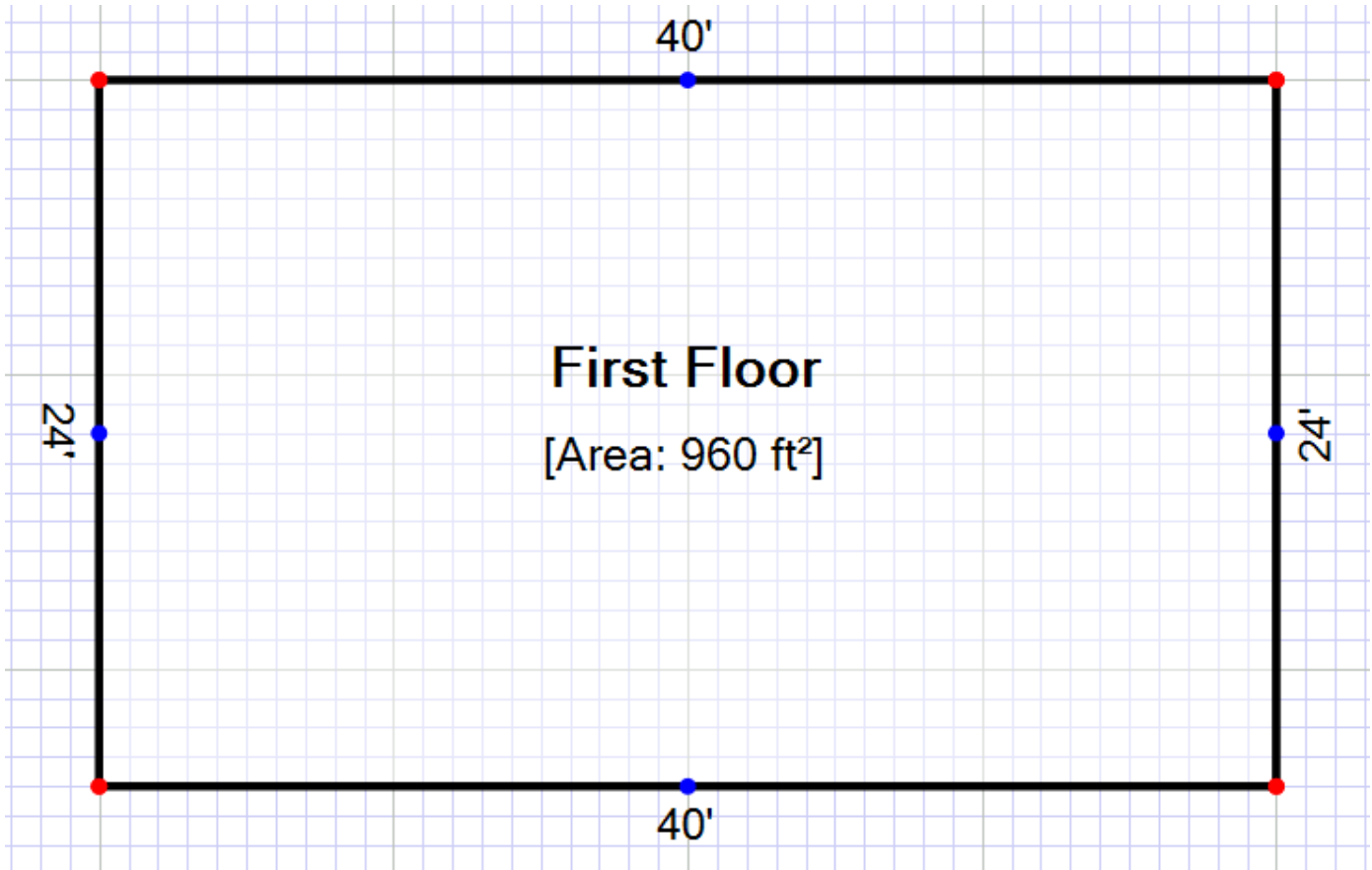

Main Living Floor Area = 960 Sq. Ft.

**Total Living Floor Area = 960 Sq. Ft.**

Prepared by:  
**A+ Measurement**

**Teresa Anderson**  
**AIC Candidate Member**  
Direct: (780) 512-6271

All measurements completed by A+ Measurement Service using the Residential Measurement Standard (RMS) guidelines as set forth by the Real Estate Council of Alberta (RECA). Pursuant to RMS guidelines, the total area is based on the area inside the allowable perimeter of the house or condominium, not by adding up the room areas; and DOES NOT include garages, decks, porches, patios, "open to below" areas, cantilevers with non-walkable space, plant ledge windows, or any area with a ceiling height less than 5'-0". For more information on the RMS guide, please visit [www.reca](http://www.reca)

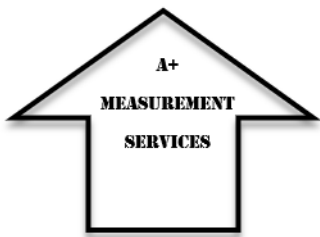

# A+ MEASUREMENT SERVICES

*and photography*

## CALCULATIONS

Living Area	Area Calculation			
First Floor	960 ft <sup>2</sup>	First Floor	x 1.00 =	960 ft <sup>2</sup>
Total Living Area (rounded):	960 ft <sup>2</sup>	24' x	40' x	1.00 = 960 ft <sup>2</sup>

## Room Dimensions

Room	Dimensions	Room	Dimensions
Main Floor Bed	8'6" x 9'	Basement Bed	10'6" x 13'6"
Main Floor Bed	8'6" x 10'	Basement Bed	
Main Floor Bath	5' x 7'	Basement Bath	
2 <sup>nd</sup> Floor Bed		Basement Family	12'6" x 24'
2 <sup>nd</sup> Floor Bed		Basement Storage	10' x 15'
2 <sup>nd</sup> Floor Bath			
Master Bed	11' x 12'		
Ensuite	3' x 6'	Laundry	9' x 19'
Kitchen	11'6" x 17'		
Dining	7' x 8'		
Living	11' x 17'		

*Room measurements are not RMS compliant, and represent an approximate interior (paint to paint) sqft for the sole purpose of MLS input. Rooms are measured at longest length and width. To date this does not include closet areas.*