

# 1610 GARDEN OF THE GODS



## FOR LEASE

**4,377 SF OF OFFICE/FLEX  
FROM \$10.50 NNN YEAR 1**

**RECENT IMPROVEMENTS**



## Office/Flex

- HIGH CEILINGS
- EXPOSED DUCTWORK
- ABUNDANT GLASS
- OPEN LANDSCAPE
- PRIVATE OFFICE
- CONFERENCE ROOM
- FROM \$10.50 NNN YEAR 1

**CORE**  
COMMERCIAL  
BROKERAGE CO.

**MIKE HELWEGE**  
PRINCIPAL  
+1.719.668.6811  
MIKE@CORECOMMBC.COM

**PARKER CURRY,**  
ASSOCIATE  
+1.719.337.1367  
PARKER@CORECOMMBC.COM





## LOCATION

North side of Garden of the Gods, W of Centennial

## ZONING

PIP 1 HS

## AVAILABLE SPACE

4,377

## BUILDING

91,440 SF- Built in 1979

## CONSTRUCTION

Metal/Concrete Panels

## LEASE RATE

From \$10.50 NNN Year 1

## EXPENSES

\$1.85/SF excluding utilities and in-suite janitorial

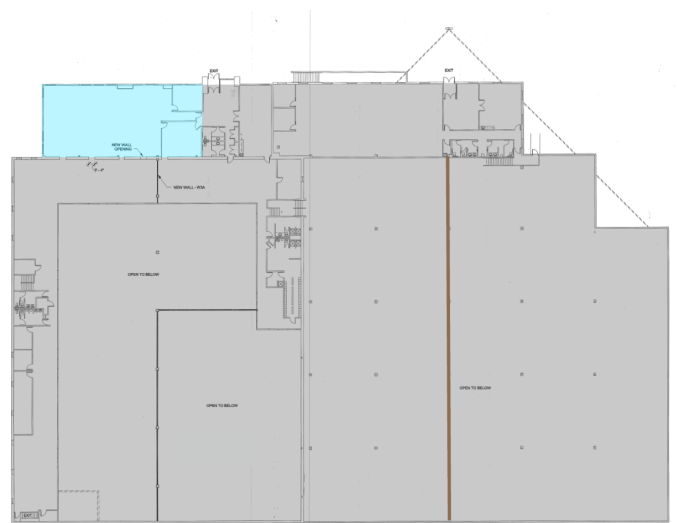

FOR MORE INFORMATION, PLEASE CONTACT:



**MIKE HELWEGE**  
**PRINCIPAL**  
**+1.719.668.6811**  
**MIKE@CORECOMMBC.COM**

**PARKER CURRY,**  
**ASSOCIATE**  
**+1.719.337.1367**  
**PARKER@CORECOMMBC.COM**