

OREGON INVENTORY OF HISTORIC PROPERTIES
HISTORIC RESOURCE INVENTORY FORM - TWO

NAME: Charles & Sarah Toole Residence

T/R/S: 2-1E-36DD TAX LOT 1900

ADDRESS: 207 Fourth Avenue

QUADRANGLE: Oregon City



NEGATIVE NO. IV-B-11, 12

SLIDE NO. _____

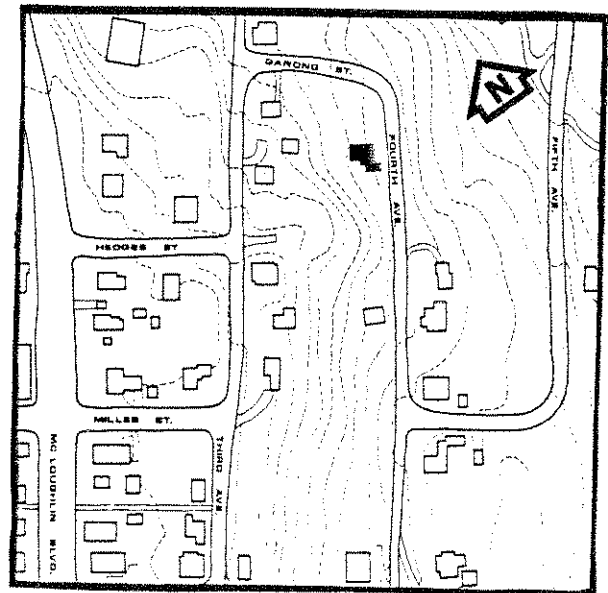
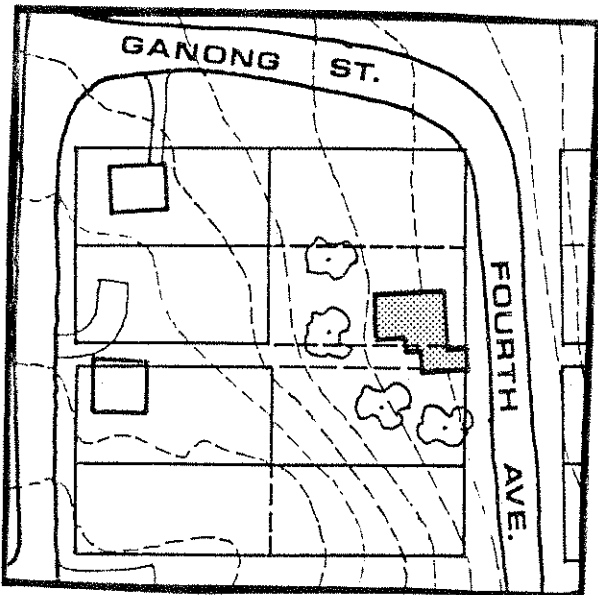

GRAPHIC AND PHOTO SOURCES: Base Map of Canemah. Oregon City Planning Department Photograph, 1988.

SHPO INVENTORY NO.: _____

OREGON INVENTORY OF HISTORIC PROPERTIES
HISTORIC RESOURCE INVENTORY FORM

HISTORIC NAME: Charles & Sarah Toole Residence
COMMON NAME: _____
ADDRESS: 207 Fourth Avenue
OWNER: Michael McDonald, 24261 S. Brockway Road,
Oregon City, OR 97045
T/R/S: 2-2E-31CC TAX LOT: 1900
ADDITION: Plat of Canemah
LOT: 7 BLOCK: 18 QUAD: Oregon City

DATE OF CONSTRUCTION: c. 1895
ORIGINAL USE: Residence
PRESENT USE: Residence
ARCH./BLDR.: Unknown
STYLE: Vernacular
BLDG. STRUC. DIST. SITE OBJ. (CIRCLE)
THEME: Architecture, 19th Century

PLAN TYPE/SHAPE: Rectangular
FOUNDATION MATERIAL: Concrete
ROOF FORM & MATERIALS: Gable roof.
WALL CONSTRUCTION: Wood

NO. OF STORIES: 2
BASEMENT (Y/N): Yes

STRUCTURAL FRAME: Stud
PRIMARY WINDOW TYPE: One-over-one windows with narrow trim.
SURFACING MATERIALS: Masonite singles cover original shiplap siding.
DECORATIVE FEATURES: None.

OTHER: Single-story pent-roof porch with square posts. Pent-roof porch over rear deck.
CONDITION: EXCELLENT _____ GOOD _____ FAIR X DETERIORATED _____ MOVED _____ (date)

EXTERIOR ALTERATIONS/ADDITIONS (dated): Masonite shingles, original porch posts replaced, porch over rear deck altered, all n.d.

NOTEWORTHY LANDSCAPE FEATURES: None.

ASSOCIATED STRUCTURES: Garage.

KNOWN ARCHAEOLOGICAL FEATURES: None.

GEOGRAPHIC SETTING: Located on a corner lot of Fourth Avenue at its intersection with Ganong Street. Hillside location. Lower side of Fourth Avenue. A heavily treed, residential area of Canemah.

STATEMENT OF SIGNIFICANCE: (Historical and/or architectural importance, dates, events, persons, contexts): Charles Toole, born in 1863, was a woolsorter at the Oregon City Woolen Mill at the turn of the century. His wife, Sarah, was born in 1868 in England, and emigrated to the United States in 1884. They had seven children. The house is significant for its age; it is a typical vernacular structure for turn-of-the-century Oregon City. Within the Canemah NR District, it is classified as a Secondary structure.

SOURCES: Federal Census, 1900. Sanborn Insurance Map, 1900, 1911. Clackamas County Tax Rolls, 1901, 1905. Pioneer National Title Company Records, Oregon City.

NEGATIVE NO: IV-B-11, 12
SLIDE NO: _____

RECORDED BY: Patricia Erigeron
DATE: 1983

SHPO INVENTORY NO.: _____