

Recreation Map
for the
BURNS PROPERTY

Mountain Road
Newbury, NH
347 acres

Drafted: 12/8/2015

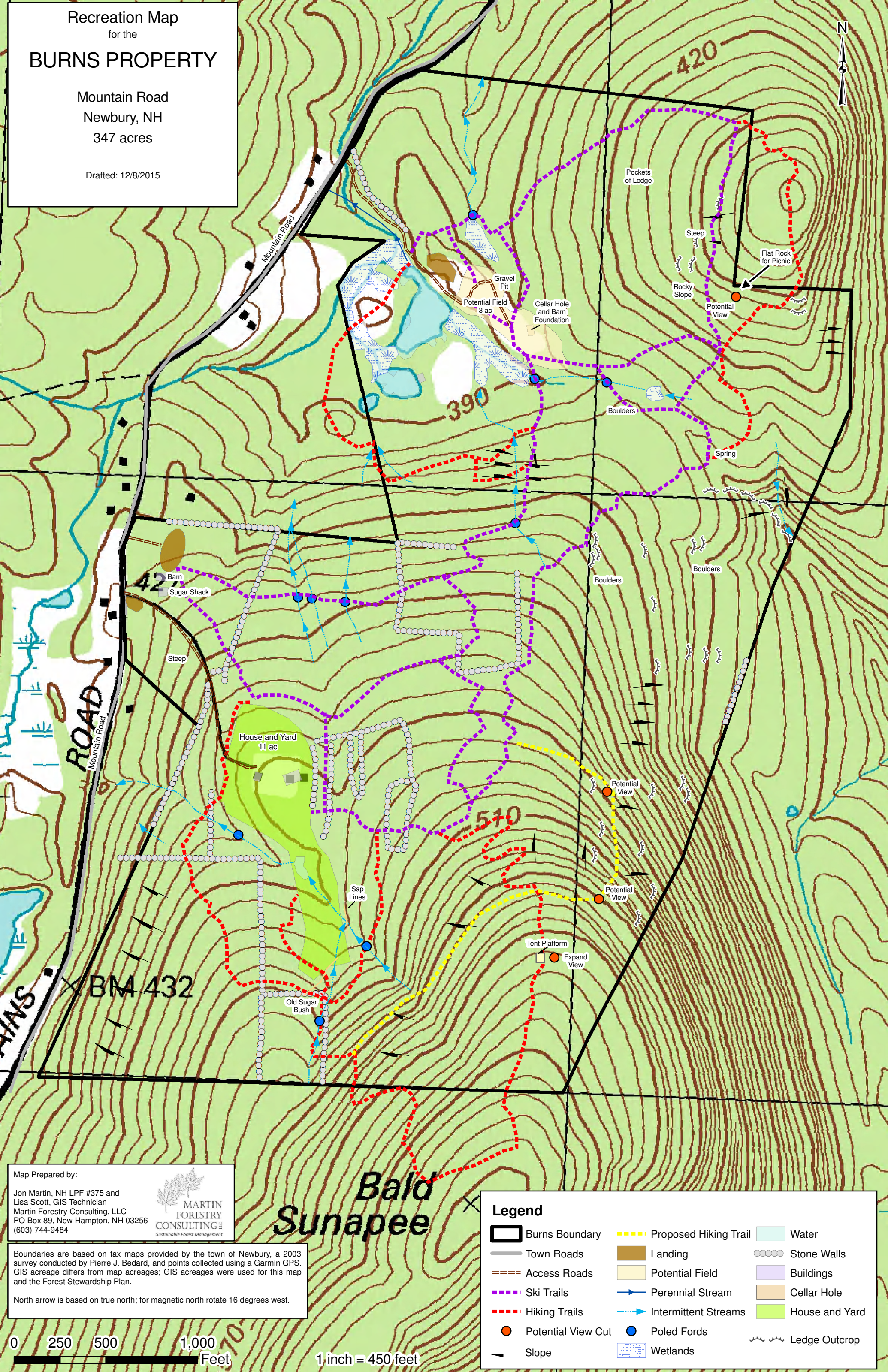

Map Prepared by:

Jon Martin, NH LPF #375 and
Lisa Scott, GIS Technician
Martin Forestry Consulting, LLC
PO Box 89, New Hampton, NH 03256
(603) 744-9484

**MARTIN
FORESTRY
CONSULTING**
Sustainable Forest Management

Boundaries are based on tax maps provided by the town of Newbury, a 2003 survey conducted by Pierre J. Bedard, and points collected using a Garmin GPS. GIS acreage differs from map acreages; GIS acreages were used for this map and the Forest Stewardship Plan.

North arrow is based on true north; for magnetic north rotate 16 degrees west.

Legend

Burns Boundary	Proposed Hiking Trail	Water
Town Roads	Landing	Stone Walls
Access Roads	Potential Field	Buildings
Ski Trails	Perennial Stream	Cellar Hole
Hiking Trails	Intermittent Streams	House and Yard
Potential View Cut	Poled Fords	Ledge Outcrop
Slope	Wetlands	

02505001,000
Feet

1 inch = 450 feet