



COMMONWEALTH of VIRGINIA

THREE RIVERS HEALTH DISTRICT

SERVING ESSEX, GLOUCESTER, KING & QUEEN, KING WILLIAM, LANCASTER, MATHEWS, MIDDLESEX, NORTHUMBERLAND, RICHMOND, & WESTMORELAND COUNTIES

MIDDLESEX COUNTY HEALTH DEPARTMENT

P. O. BOX 415
SALUDA, VA 23149
(804) 758-2381, FAX: (804) 758-4828
ENVIRONMENTAL (804) 758-0330
FAX (804) 758-8390

RICHARD WILLIAMS, MD, MPH,
DISTRICT DIRECTOR

FAX COVER SHEET

DATE: 5/7/20

RECIPIENT(S): Frank

FAX #: 642.0437

PAGES(including cover sheet): 6

SENDER: Ruth Carter, EH OM

FAX #: 804-758-8390

TELEPHONE # 804-758-0330

COMMENTS:

My apologies for sending this late -
Here's the septic permit, drawing from 1994 &
the Well permit from 2008

CONFIDENTIALITY NOTICE

This facsimile transmission (and/or documents accompanying it) may contain information belonging to the sending party or the recipient which is extremely confidential in nature. This information is intended for the use of the individual and/or entity named above as the recipient. If you are not the intended party, you are hereby notified that any disclosure, copying, distribution or the taking of any action in reliance upon the contents of the transmission is strictly prohibited. If you have received this transmission in error, please notify us by telephone to arrange for the return of the documents.



THIS PERMIT IS NOT TRANSFERABLE

Water Supply and/or Sewage Disposal System Construction Permit

Commonwealth of Virginia

Department of Health

Middlesex County Health Department

Health Department

Identification Number 159-94-324

Map Reference 26-15-2

General Information

Water Supply System: New ☐ Repair ☐ Public ☐ FHA ☐ VA ☐ Case No. _____Sewage Disposal System: New ☐ Repair ☒ Expanded ☐ Conditional ☐ Public ☐Based on the application for a sewage disposal system construction permit filed in accordance with Section 2.13 E, of the Sewage Handling and Disposal Regulations and/or Section 2.13 of the Private Well Regulations a construction permit is hereby issued to:Owner Steve D. Benefield

Telephone (919) 482-2120

Address P O Box 177 Elizabeth City, NC 27907 For a Type I Sewage Disposal System or Well to be constructed on/at North 17, 1st drive past Rt. 615Subdivision _____ Section/Block _____ Lot _____ Actual or estimated water use 450 GPD/3 bd

DESIGN

NOTE: SEWAGE DISPOSAL SYSTEM INSPECTION RESULTS

Water supply, existing: (describe) DCWater supply location: Satisfactory yes ☒ no ☐ comments _____

To be installed: class _____

Completion Report _____

cased ☐ grouted ☐G. W. 2 Received: yes ☐ no ☐ not applicable ☐Building sewer: 4"

I.D. PVC Schedule 40, or equivalent.

Building sewer: yes ☐ no ☐ comments _____

Slope 1.25" per 10' (minimum).

Satisfactory

☐ Other _____Pretreatment unit: yes ☒ no ☐ comments _____Septic tank: Capacity 900 gals. (minimum).

Satisfactory

☐ Other _____

Inlet-outlet structure:

Inlet-outlet structure: yes ☐ no ☐ comments _____

PVC Schedule 40, 4" tees or equivalent.

Satisfactory TANKS COVERED AND NOT SECURED☐ Other _____

Pump and pump station:

Pump & pump station: yes ☐ no ☐ comments _____No ☐ Yes ☐ describe and show design.

Satisfactory

If yes: _____

Gravity mains: 3" or larger I.D., minimum 6" fall per 100', 1500 lb. crush strength or equivalent.

Conveyance method: yes ☐ no ☐ comments _____☐ Other _____

Satisfactory

Distribution box:

Distribution box: yes ☒ no ☐ comments _____Precast concrete with 8 ports.

Satisfactory

☐ Other _____

Header lines:

Header lines:

Material: 4" I.D. 1500 lb. crush strength plastic or equivalent from distribution box to 2' into absorption trench. Slope 2" minimum.

yes ☒ no ☐ comments _____☐ Other _____

Satisfactory

Percolation lines:

Percolation lines:

Gravity 4" plastic 1000 lb. per foot bearing load or equivalent, slope 2" 4" (min. max.) per 100'.

yes ☒ no ☐ comments _____☐ Other _____

Satisfactory

Absorption trenches:

Absorption trenches:

Square ft. required 750; depth from ground surface to bottom of trench 7' to 9'; aggregate size #50/57.yes ☐ no ☒ comments _____Trench bottom slope 2"-4"/100'.

Satisfactory

center to center spacing 9'; trench width 3'.Depth of aggregate 3'-5'.

Date _____

Inspected and approved by: _____

Trench length 50'; Number of trenches 5.

Sanitarian



Middlesex County Health Department
P.O. Box 415
Saluda, Virginia 23149
(804) 758-0330 Voice
(804) 758-8390 Fax

Private Well Construction Permit
Health Department ID Number: **159-08-0056**

Owner / Agent Information

Owner: Janine L. Wyatt
11495 Tidewater Trail
Saluda, Virginia 23149
Owner Phone: (804) 758-9989

Location Information

Property Address: 11495 Tidewater Trail
Locality: Middlesex
Directions: Rt. 17 North --> house on right past Rt. 615

Tax Map: 26-15-2

General Information

Well Class: Class IIIA	Minimum Casing Depth: 100 feet	Minimum Grout Depth: 20 feet
------------------------	--------------------------------	------------------------------

Well Class: Class IIIB	Minimum Casing Depth: 50 feet	Minimum Grout Depth: 50 feet
------------------------	-------------------------------	------------------------------

Comments:

Refer to page 3 for detailed construction drawing.

Do NOT use soil spray or soil injection for termite treatment on any existing or proposed building foundation less than 50' from well.

Class IIIA or IIIB wells must be 50'+ from all actual and potential sources of contamination including all parts of all sewage disposal systems, soil-poisoned foundations, underground petroleum tanks, cemeteries, feedlots, etc.

Construction documentation and a water sample negative for coliform bacteria is required for approval of all potable water wells (Classes IIIA, B or C)

Please contract with a licensed well driller.

This permit is issued based upon a site evaluation conducted by Leora StClair, EHS on March 14, 2008. See following page for Construction Drawing.

Notice: The Virginia Department of Health may revoke or modify this permit if, at a later date, it finds the conditions that formed the basis for issuing the permit do not substantially comply with the *Private Well Regulations*, 12 VAC 5-630-10 et seq., or if the well would threaten public health or the environment.

approximate area
of drainfield

~150'

The proposed IIIA/IIIB well
to be constructed according
to the 1992 VA Private Well
Regulations:

	IIIA	IIIB
Case	100'	50'
Grout	20'	50'

existing well and
pump house

existing
house

124' 7/29/08
least clear

property line

107'

~100'

proposed IIIA/IIIB
well location

93'

barn

* Do NOT use soil spray or
soil injection for termite
treatment on any building
foundation less than 50'
from proposed well.

Janine Wyatt
TM#: 26-15-2
HDID#: 159-08-0060

Route 17 North

Well Construction Permit -- Drawing**HD ID #: 159-08-0056****Owner Information**

Janine L. Wyatt
 11495 Tidewater Trail
 Saluda, Virginia 23149

Phone: (804) 758-9989

Construction Drawing

Scale drawing of the well site and related features.

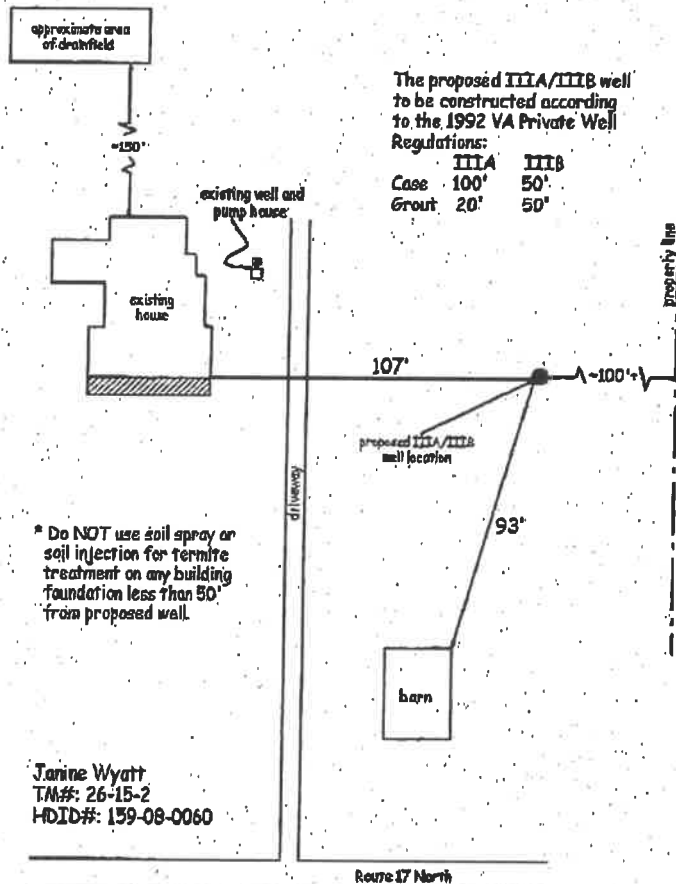

Page ____ of ____

Show the property lines, all existing and proposed structures, existing and proposed sewage systems and water supplies, slope, and any topographic features which may impact the design of the well.

Lee St. Clair
 Issued by: Lee St. Clair

March 14, 2008
 Issue Date

September 14, 2012
 Expiration Date

Eva Lowe
 Reviewed by: Eva Lowe