

GENERAL NOTES

1. APPROVAL OF THIS GRADING PLAN DOES NOT CONSTITUTE APPROVAL OF VERTICAL OR HORIZONTAL ALIGNMENT OF ANY PRIVATE ROAD SHOWN HEREON FOR COUNTY ROAD PURPOSES.
2. FINAL APPROVAL OF THESE GRADING PLANS IS SUBJECT TO FINAL APPROVAL OF THE ASSOCIATED IMPROVEMENT PLANS WHERE APPLICABLE. FINAL CURB GRADE ELEVATIONS MAY REQUIRE CHANGES IN THESE PLANS.
3. IMPORTANT MATERIAL SHALL BE OBTAINED FROM A LEGAL SITE.
4. A CONSTRUCTION, EXCAVATION OR ENCROACHMENT PERMIT FROM THE DEPARTMENT OF PUBLIC WORKS WILL BE REQUIRED FOR ANY WORK IN THE COUNTY RIGHT-OF-WAY.
5. ALL SLOPES OVER THREE FEET IN HEIGHT WILL BE PLANTED IN ACCORDANCE WITH SAN DIEGO COUNTY SPECIFICATIONS.
6. THE CONTRACTOR SHALL VERIFY THE EXISTENCE AND LOCATION OF ALL UTILITIES BEFORE COMMENCING WORK. NOTICE OF PROPOSED WORK SHALL BE GIVEN TO THE FOLLOWING AGENCIES:

SAN DIEGO GAS AND ELECTRIC
AT&T TELEPHONE
CATV (AGENCY NAME)
SEWER (AGENCY NAME)
WATER (AGENCY NAME)

PHONE NUMBER:
1-800-411-7343
1-800-288-2020

1-760-479-4150
1-858-756-2854

7. A SOILS REPORT MAY BE REQUIRED PRIOR TO THE ISSUANCE OF BUILDING PERMIT.
8. APPROVAL OF THESE PLANS BY THE DIRECTOR OF PUBLIC WORKS DOES NOT AUTHORIZE ANY WORK OR GRADING TO BE PERFORMED UNTIL THE PROPERTY OWNER'S PERMISSION HAS BEEN OBTAINED AND VALID GRADING PERMIT HAS BEEN ISSUED.
9. THE DIRECTOR OF PUBLIC WORK'S APPROVAL OF THESE PLANS DOES NOT CONSTITUTE COUNTY BUILDING OFFICIAL APPROVAL OF ANY FOUNDATION FOR STRUCTURES TO BE PLACED ON THE AREA COVERED BY THESE PLANS. NO WAIVER OF THE GRADING ORDINANCE REQUIREMENTS CONCERNING MINIMUM COVER OVER EXPANSIVE SOIL IS MADE OR IMPLIED (SECTIONS 87.403 & 87.410). ANY SUCH WAIVER MUST BE OBTAINED FROM THE DIRECTOR OF PLANNING AND DEVELOPMENT SERVICES.

10. ALL OPERATIONS CONDUCTED ON THE PREMISES, INCLUDING THE WARMING UP, REPAIR, ARRIVAL, DEPARTURE OR RUNNING OF TRUCKS, EARTHMOVING EQUIPMENT, CONSTRUCTION EQUIPMENT AND ANY OTHER ASSOCIATED GRADING EQUIPMENT SHALL BE LIMITED TO THE PERIOD BETWEEN 7:00AM AND 6:00PM EACH DAY, MONDAY THROUGH SATURDAY, AND NO EARTHMOVING OR GRADING OPERATIONS SHALL BE CONDUCTED ON THE PREMISES ON SUNDAYS OR HOLIDAYS.

11. ALL MAJOR SLOPES SHALL BE ROUNDED INTO EXISTING TERRAIN TO PRODUCE A CONTOURED TRANSITION FROM CUT OR FILL FACES TO NATURAL GROUND AND ABUTTING CUT OR FILL SURFACES.

12. NOTWITHSTANDING THE MINIMUM STANDARDS SET FORTH IN THE GRADING ORDINANCE AND NOTWITHSTANDING THE APPROVAL OF THESE GRADING PLANS, THE PERMITTEE IS RESPONSIBLE FOR THE PREVENTION OF DAMAGE TO ADJACENT PROPERTY. NO PERSON SHALL EXCAVATE ON LAND SO CLOSE TO THE PROPERTY LINE AS TO ENDANGER ANY ADJOINING PUBLIC STREET, SIDEWALK, ALLEY, FUNCTION OF ANY SEWAGE DISPOSAL SYSTEM, OR ANY OTHER PUBLIC OR PRIVATE PROPERTY WITHOUT SUPPORTING AND PROTECTING SUCH PROPERTY FROM SETTLING, CRACKING, EROSION, SILTING, SCOUR OR OTHER DAMAGE WHICH MIGHT RESULT FROM THE GRADING DESCRIBED ON THIS PLAN. THE COUNTY WILL HOLD THE PERMITTEE RESPONSIBLE FOR CORRECTION OF NON-DEDICATED IMPROVEMENTS WHICH DAMAGE ADJACENT PROPERTY.

13. SLOPE RATIOS:
CUT--1 ½: 1 FOR MINOR SLOPES (SLOPES < 15'), 2:1 FOR MAJOR SLOPES.
FILL--2:1

EXCAVATION: 344 C. Y. FILL: 304 C. Y. WASTE/IMPORT 40 C. Y.
(NOTE: A SEPARATE VALID PERMIT MUST EXIST FOR EITHER WASTE OR IMPORT AREAS BEFORE PERMIT TO BE ISSUED).

14. SPECIAL CONDITION: IF ANY ARCHEOLOGICAL RESOURCES ARE DISCOVERED ON THE SITE OF THIS GRADING DURING GRADING OPERATIONS, SUCH OPERATIONS WILL CEASE IMMEDIATELY, AND THE PERMITTEE WILL NOTIFY THE DIRECTOR OF PUBLIC WORKS OF THE DISCOVERY. GRADING OPERATIONS WILL NOT RECOMMENCE UNTIL THE PERMITTEE HAS RECEIVED WRITTEN AUTHORITY FROM THE DIRECTOR OF PUBLIC WORKS TO DO SO.

15. PERMANENT POST--CONSTRUCTION BMP DEVICES SHOWN ON PLAN SHALL NOT BE REMOVED OR MODIFIED WITHOUT THE APPROVAL FROM THE DEPARTMENT OF PUBLIC OF WORKS.

16. THE APPLICANT IS RESPONSIBLE FOR THE ROAD MAINTENANCE (SWEEPING AS NECESSARY) AND REPAIRS OF ANY DAMAGE CAUSED BY THEM TO THE ON-SITE AND OFF-SITE COUNTY MAINTAINED OR PRIVATE ROADS THAT SERVE THE PROPERTY EITHER DURING CONSTRUCTION OR SUBSEQUENT OPERATIONS. THE APPLICANT WILL REPAIR THOSE PORTIONS OF THE ROUTE THAT WOULD BE DAMAGES BY THE HEAVY LOADS THAT LOADED TRUCKS PLACE ON THE ROUTE IDENTIFIED.

17. FINAL APPROVAL OF THIS GRADING PLAN IS SUBJECT TO FINAL APPROVAL OF THE ASSOCIATED IMPROVEMENT PLANS WHERE APPLICABLE. FINAL CURB GRADE ELEVATIONS MAY REQUIRE CHANGE TO THESE PLANS.

18. THE ENGINEER-OF-WORK SHALL COMPLY WITH ALL PROJECT APPLICABLE LAWS THAT INCLUDE, BUT ARE NOT LIMITED TO, HEALTH, SAFETY, AND ENVIRONMENTAL LAWS, ORDINANCES, AND REGULATIONS RELATING TO THE COUNTY OF SAN DIEGO, STATE OF CALIFORNIA, AND U.S. FEDERAL GOVERNMENT. THE PROJECT IS SUBJECT TO ENFORCEMENT UNDER PERMITS FROM THE SAN DIEGO REGIONAL WATER QUALITY CONTROL BOARD (RWQCB) AND THE COUNTY OF SAN DIEGO WATERSHED PROTECTION, STORMWATER MANAGEMENT, AND DISCHARGE CONTROL ORDINANCE NO. 10410, COUNTY OF SAN DIEGO HYDRAULIC DESIGN MANUAL, AND ALL OTHER APPLICABLE ORDINANCES AND STANDARDS FOR THE LIFE OF THIS PERMIT. THE PROJECT SITE SHALL BE IN COMPLIANCE WITH ALL APPLICABLE STORMWATER REGULATIONS REFERENCED ABOVE AND ALL OTHER APPLICABLE ORDINANCES AND STANDARDS. THIS INCLUDES COMPLIANCE WITH THE APPROVED STORM WATER QUALITY MANAGEMENT PLAN (SWQMP), ALL REQUIREMENTS FOR LOW IMPACT DEVELOPMENT (LID), HYDROMODIFICATION, DETENTION FACILITIES, MATERIALS AND WASTES CONTROL, EROSION CONTROL, AND SEDIMENT CONTROL ON THE PROJECT SITE.

19. THE ISSUANCE OF THIS PERMIT/APPROVAL BY THE COUNTY OF SAN DIEGO DOES NOT AUTHORIZE THE APPLICANT FOR THE PERMIT/APPROVAL TO VIOLATE ANY FEDERAL, STATE, OR COUNTY LAWS, ORDINANCES, REGULATIONS, OR POLICIES INCLUDING, BUT NOT LIMITED TO THE FEDERAL ENDANGERED SPECIES ACT AND CLEAN WATER ACT. GRADING AND/OR FURTHER DEVELOPMENT ARE PROHIBITED WITHIN THE AREAS DESIGNATED "LIMITS OF JURISDICTIONAL HABITAT" UNTIL FEDERAL PERMITS AND STATE PERMITS (IF ANY) HAVE BEEN ACQUIRED.

OWNER / PERMITTEE

NAME: NICHOLAS & ANNA-MARIE ROACH

ADDRESS: 2255 EUCLID AVE.
EL CAJON, CA 92019

TELEPHONE NO:

SHORT LEGAL DESCRIPTION: PARCEL 3 OF PARCEL MAP NO. 2652
PARCEL 4 OF PARCEL MAP NO. 2652

A.P.N. NO: 512-180-35 & 512-180-36

SITE ADDRESS: 2255 EUCLID AVE., EL CAJON, CA 92019



RESIDENTIAL MINOR GRADING PLAN FOR:
2255 EUCLID AVE
EL CAJON, CA 92019

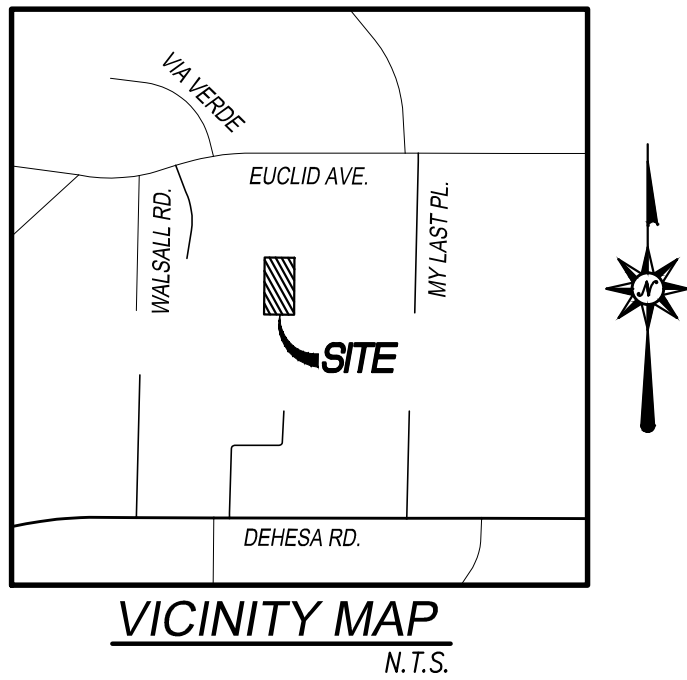

SHEET INDEX

SHEET 1	TITLE SHEET
SHEET 2	NOTES
SHEET 3	HELIX WATER DISTRICT NOTES
SHEET 4	GRADING PLAN
SHEET 5	EROSION CONTROL NOTES AND TYPICAL BMP DETAILS
SHEET 6	EROSION CONTROL AND STORM WATER QUALITY BMP PLAN
SHEET 7	DMA HYDROMODIFICATION PLAN

DISTURBED AREA CALCULATIONS:

PAD + SLOPES:	22,520	SF
DRIVEWAY:	8,460	SF
PRIMARY SEPTIC:	N/A	SF
FIRE CLEARING:	N/A	SF
TOTAL:	30,980	SF
IF ≥ 1 AC, PROVIDE WID# :	N/A	

DWELLING UNITS

INDICATE THE NUMBER OF DWELLING UNITS IN PROJECT:	1
INDICATE THE NUMBER OF GRADED PADS IN PROJECT:	1

OWNER'S CERTIFICATE

IT IS AGREED THAT FIELD CONDITIONS MAY REQUIRE CHANGES TO THESE PLANS.

IT IS FURTHER AGREED THAT THE OWNER (DEVELOPER) SHALL HAVE A REGISTERED CIVIL ENGINEER MAKE SUCH CHANGES ALTERATIONS OR ADDITIONS TO THESE PLANS WHICH THE DIRECTOR OF PLANNING & DEVELOPMENT SERVICES DETERMINES ARE NECESSARY AND DESIRABLE FOR THE PROPER COMPLETIONS OF THE IMPROVEMENTS.

BY: DATE:

ASSESSOR'S PARCEL NO. 512-180-35 & 512-180-36

NAME: NICHOLAS & ANNA-MARIE ROACH

ADDRESS: 2255 EUCLID AVE.
EL CAJON, CA 92019

PHONE NUMBER:

GRADING PLAN CERTIFICATION:

I, CERTIFY THAT THE GRADING AS SHOWN ON THIS MINOR GRADING PLAN SATISFIES THE REQUIREMENTS OF THE COUNTY OF SAN DIEGO GRADING ORDINANCE.

BY: DATE:

RCE NO.: C80667

THE COUNTY IS NOT RESPONSIBLE FOR THE DESIGN IN ANYWAY.

BY: DATE:
FOR: VINCE NICOLETTI, DIRECTOR, DEPARTMENT OF PLANNING & DEVELOPMENT SERVICES

FIRE DEPARTMENT APPROVAL

FIRE DEPT. / DISTRICT: SAN MIGUEL FIRE & RESCUE

APPROVED BY: DATE:

DECLARATION OF RESPONSIBLE CHARGE

I HEREBY DECLARE THAT I AM THE ENGINEER OF WORK FOR THIS PROJECT, THAT I HAVE EXERCISED RESPONSIBLE CHARGE OVER THE DESIGN OF THE PROJECT AS DEFINED IN SECTION 6703 OF THE BUSINESS AND PROFESSIONS CODE, AND THAT THE DESIGN IS CONSISTENT WITH CURRENT STANDARDS.

I UNDERSTAND THAT THE CHECK OF PROJECT DRAWINGS AND SPECIFICATIONS BY THE COUNTY OF SAN DIEGO IS CONFINED TO REVIEW ONLY AND DOES NOT RELIEVE ME, AS ENGINEER OF WORK, OF MY RESPONSIBILITIES FOR PROJECT DESIGN

BY: DATE: RCE NO:

PDS ENVIRONMENTAL REVIEW

APPROVED FOR COMPLIANCE WITH THE ENVIRONMENTAL REVIEW.

APPROVED BY: DATE:

THE ISSUANCE OF THIS PERMIT/APPROVAL BY THE COUNTY OF SAN DIEGO DOES NOT AUTHORIZE THE APPLICANT FOR THE PERMIT/APPROVAL TO VIOLATE ANY FEDERAL, STATE, OR COUNTY LAWS, ORDINANCES, REGULATIONS, OR POLICIES INCLUDING, BUT NOT LIMITED TO THE FEDERAL ENDANGERED SPECIES ACT AND CLEAN WATER ACT. GRADING AND/OR FURTHER DEVELOPMENT ARE PROHIBITED WITHIN THE AREAS DESIGNATED "LIMITS OF JURISDICTIONAL HABITAT" UNTIL FEDERAL PERMITS AND STATE PERMITS (IF ANY) HAVE BEEN ACQUIRED.

COUNTY APPROVED CHANGES

NO.	DESCRIPTION:	APPROVED BY:	DATE:

PERMITS

LANDSCAPE PERMIT NO. N/A

WDID/NOI NO. N/A SWPPP RISK LEVEL N/A

TENTATIVE MAP NO.

BENCH MARK

DESCRIPTION: 2" IRON PIPE & DISK STAMPED LS 2783 SET IN DIRT

LOCATION: APPROXIMATELY 490' NORTH OF THE INTERSECTION OF SINGING VISTA DR. AND SINGING VISTA WAY ALONG A E-W 52.3' EAST OF A POWER POLE

RECORD FROM: SURVEY CONTROL RECORD OF SURVEY NO. 13702

ELEVATION: 688.62' DATUM: (NGVD 29)

DATUM:

PRIVATE CONTRACT

SHEET 1 OF 7 SHEETS

COUNTY OF SAN DIEGO DEPARTMENT OF PUBLIC WORKS

TITLE SHEET FOR: 2255 EUCLID AVE

CALIFORNIA COORDINATE INDEX 226-1797

APPROVED FOR: SAMIR NAJAL, COUNTY ENGINEER

ENGINEER OF WORK: R.C.E.: C80667 DATE: GRADING PERMIT NO: PSD2024-LDGRMN-20405

SEE CERTIFICATION

WORK TO BE DONE

GRADING, DRAINAGE AND PUBLIC WATER WORK CONSISTS OF THE FOLLOWING WORK TO BE DONE ACCORDING TO THESE PLANS, THE CURRENT SAN DIEGO AREA REGIONAL STANDARD DRAWINGS AND THE STANDARD SPECIFICATIONS FOR PUBLIC WORKS CONSTRUCTION, AND PER SAN DIEGO COUNTY GRADING ORDINANCE, AND THE SAN DIEGO WATER AGENCIES' STANDARDS (WWW.SDWAS.ORG), CURRENT EDITION. THE PROJECT PROPOSES TO RESURFACE AN EXISTING DIRT ROAD THROUGH A DRIVEWAY ACCESS EASEMENT IN ORDER TO GRADE AND CONSTRUCT A SINGLE FAMILY HOME ON AN EXISTING RESIDENTIAL LOT.

LEGEND

PROPERTY LINE	---
RIGHT OF WAY	----
ROAD CENTERLINE	----
ADJOINING PROPERTY LINE	----
EASEMENT LINE	----

PROPOSED IMPROVEMENTS

IMPROVEMENT	STANDARD DWGS.	SYMBOL	QTY
BUILDING FOOTPRINT		----	
GARAGE LIMITS		----	
MAJOR CONTOUR		170	
MINOR CONTOUR		171	
GRADE SLOPE CUT		2:1	
GRADE SLOPE FILL		2:1	
GRADE LIMIT LINE		----	
GRADE BREAK		----	
DRAINAGE FLOW ARROW		←	
INSTALL 6" AREA DRAIN		○	
INSTALL 4" PVC STORM DRAIN PIPE		----	
INSTALL PCC PAVING		4	
INSTALL RIP RAP	SDRSD D-40		
INSTALL AC PAVING			
INSTALL DG DRIVEWAY			
INSTALL FIRE HYDRANT (ONE 2.5" & ONE 4" PORTS)WITH BREAK-OFF CHECK VALVE (BY HWD)	WAS WF-02, WF-04	1 EA	

STORMWATER STRUCTURAL POLLUTANT CONTROL & HYDROMODIFICATION CONTROL BMPs				
DESCRIPTION/TYPE	PLAN SHEET	BMP ID#	MAINTENANCE CATEGORY	MAINTENANCE AGREEMENT RECORDED DOC#
BIOFILTRATION BASIN	2	BF-1	1	

* BMP'S APPROVED AS PART OF THIS STORMWATER QUALITY MANAGEMENT PLAN (SWQMP) DATED 06/13/2025 ON FILE WITH DPW. ANY CHANGES TO THE ABOVE BMP'S WILL REQUIRE SWQMP REVISION AND PLAN CHANGE APPROVALS.

SAN MIGUEL FIRE & RESCUE	HELIX WATER DISTRICT
PROJECT	PROJECT RMB24101
APPROVED BY: DATE	ACCEPTED BY: TIMOTHY J. ROSS DATE
EXPIRES ONE YEAR AFTER SIGNATURE DATE	

PERMANENT POST-CONSTRUCTION SOURCE CONTROL AND SITE DESIGN BMP NOTES:

SOURCE CONTROL BMP REQUIREMENTS:

ALL DEVELOPMENT PROJECTS MUST IMPLEMENT SOURCE CONTROL BMPS 4.2.1 THROUGH 4.2.6 WHERE APPLICABLE AND FEASIBLE. SEE CHAPTER 4.2 AND APPENDIX E OF THE COUNTY BMP DESIGN MANUAL FOR INFORMATION TO IMPLEMENT SOURCE CONTROL BMPS SHOWN BELOW:

- 4.2.1
- PREVENT ILLICIT DISCHARGES INTO THE MS4.
- 4.2.2
- IDENTIFY THE STORM DRAIN SYSTEM USING STENCILING AND SIGNAGE
- 4.2.3
- PROTECT OUTDOOR MATERIAL STORAGE AREAS FROM RAINFALL, RUN-ON, RUN-OFF, AND WIND DISPERSAL
- 4.2.4
- PROTECT MATERIALS STORED IN OUTDOOR WORK AREAS FROM RAINFALL, RUN-ON, RUN-OFF, AND WIND DISPERSAL
- 4.2.5
- PROTECT TRASH STORAGE FROM RAINFALL, RUN-ON, RUN-OFF, AND WIND DISPERSAL
- 4.2.6
- USE OF ANY ADD'L BMPS DETERMINED TO BE NECESSARY BY THE COUNTY TO MINIMIZE POLLUTANT GENERATION AT EACH PROJECT SITE

SOURCE CONTROL BMP NOTES:

- SC-A
- ON-SITE STORM DRAIN INLETS
1. MARK ALL INLETS WITH THE WORDS "NO DUMPING DRAINS TO WATERWAYS" OR SIMILAR. SEE STENCIL TEMPLATE PROVIDED ON THE SHEET.
- SC-B
- INTERIOR DRAINS PLUMBED TO SANITARY SEWER
1. INTERIOR FLOOR DRAINS AND ELEVATOR SHAFT SUMP PUMPS SHALL BE PLUMBED TO SANITARY SEWER.
- SC-C
- INTERIOR PARKING GARAGES TO SANITARY SEWER
1. PARKING GARAGE FLOOR DRAINS SHALL BE PLUMBED TO THE SANITARY SEWER.
- SC-D
- NEED FOR FUTURE INDOOR AND STRUCTURAL PEST CONTROL
1. NOTE BUILDING DESIGN FEATURES THAT DISCOURAGE ENTRY OF PESTS.
2. PRESERVE EXISTING DROUGHT TOLERANT TREES, SHRUBS, AND GROUND COVER TO THE MAXIMUM EXTENT POSSIBLE.
3. DESIGN LANDSCAPING TO MINIMIZE IRRIGATION AND RUNOFF, TO PROMOTE SURFACE INFILTRATION WHERE APPROPRIATE, AND TO MINIMIZE THE USE OF FERTILIZERS AND PESTICIDES THAT CAN CONTRIBUTE TO STORM WATER POLLUTION.
4. WHERE LANDSCAPED AREAS ARE USED TO RETAIN OR DETAIN STORM WATER, SPECIFY PLANTS THAT ARE TOLERANT OF PERIODIC SATURATED SOIL CONDITIONS.
5. CONSIDER USING PEST-RESISTANT PLANTS, ESPECIALLY ADJACENT TO HARDSCAPE.
6. TO ENSURE SUCCESSFUL ESTABLISHMENT, SELECT PLANTS APPROPRIATE TO SITE SOILS, SLOPES, CLIMATE, SUN, WIND, RAIN, LAND USE, AIR MOVEMENT, ECOLOGICAL CONSISTENCY, AND PLANT INTERACTIONS.
- SC-E
- POOLS, SPAS, PONDS WITH ACCESSIBLE SANITARY SEWER
1. IF POOLS WILL BE PLUMBED TO THE SANITARY SEWER, ENSURE THAT THIS CONNECTION WILL BE MADE ACCORDING TO COUNTY OF SAN DIEGO REQUIREMENTS.
- SC-F
- FOOD SERVICE
1. SHOW LOCATION OF THE DESIGNATED CLEANING AREA
2. ADD NOTE ON HOW THE ITEMS WILL BE CLEANED IN THE FACILITY AND HOW IT HAS BEEN SIZED TO ENSURE THAT THE LARGEST ITEMS CAN BE ACCOMMODATED
- SC-G
- TRASH OF REFUSE EXPOSURE REDUCTION
1. SIGNS SHALL BE POSTED ON OR NEAR DUMPSTERS WITH THE WORDS "DO NOT DUMP HAZARDOUS MATERIALS HERE" OR SIMILAR.
2. COVER STORAGE CONTAINERS WITH LEAK PROOF LIDS OR SOME OTHER MEANS. IF WASTE IS NOT IN CONTAINERS, COVER ALL WASTE PILES (PLASTIC TARPS ARE ACCEPTABLE COVERAGE) AND PREVENT STORMWATER RUNON AND RUNOFF WITH A BERM. THE WASTE CONTAINERS OR PILES MUST BE COVERED EXCEPT WHEN IN USE.
3. POST "NO LITTERING" SIGNS AND ENFORCE ANTI-LITTER LAWS.
4. PREVENT STORMWATER RUNON FROM ENTERING THE WASTE MANAGEMENT AREA BY ENCLOSING THE AREA OR BUILDING AND BERM AROUND THE AREA.
- SC-H
- INDUSTRIAL PROCESSES PERFORMED INDOORS
1. IF INDUSTRIAL PROCESSES ARE TO BE LOCATED ONSITE, STATE: "ALL PROCESS ACTIVITIES TO BE PERFORMED INDOORS. NO PROCESSES TO DRAIN TO EXTERIOR OR TO STORM DRAIN SYSTEM."
- SC-I
- STORAGE OF EQUIPMENT/MATERIALS EXPOSURE REDUCTION
1. STORAGE OF NON-HAZARDOUS LIQUIDS MUST BE COVERED BY A ROOF AND/OR DRAIN TO THE SANITARY SEWER SYSTEM, AND BE CONTAINED BY BERMS, DIKES, LINERS, OR VAULTS.
2. STORAGE OF HAZARDOUS MATERIALS AND WASTES MUST BE IN COMPLIANCE WITH THE LOCAL HAZARDOUS MATERIALS ORDINANCE AND A HAZARDOUS MATERIALS MANAGEMENT PLAN FOR THE SITE.
- SC-J/K/L
- VEHICLE AND EQUIPMENT CLEANING, REPAIR AND MAINTENANCE
1. INDICATE CAR WASH AREA ON PLANS, IF NOT PROVIDED POST SIGNS TO DISCOURAGE ONSITE CAR WASHING.
2. STATE THAT NO VEHICLE REPAIR OR MAINTENANCE WILL BE DONE OUTDOORS, OR ELSE DESCRIBE THE REQUIRED FEATURES OF THE OUTDOOR WORK AREA.
3. STATE THAT THERE ARE NO FLOOR DRAINS OR IF THERE ARE FLOOR DRAINS, NOTE THE AGENCY FROM WHICH AN INDUSTRIAL WASTE DISCHARGE PERMIT WILL BE OBTAINED AND THAT THE DESIGN MEETS THAT AGENCY'S REQUIREMENTS.
4. STATE THAT THERE ARE NO TANKS, CONTAINERS OR SINKS TO BE USED FOR PARTS CLEANING OR RINSING OR, IF THERE ARE, NOTE THE AGENCY FROM WHICH AN INDUSTRIAL WASTE DISCHARGE PERMIT WILL BE OBTAINED AND THAT THE DESIGN MEETS THAT AGENCY'S REQUIREMENTS.

- SC-M
- FUEL DISPENSING COVERAGE AND GRADING REQUIREMENTS
1. FUELING AREAS (THE FUELING AREA MUST BE DEFINED AS THE AREA EXTENDING A MINIMUM OF 6.5 FEET FROM THE CORNER OF EACH FUEL DISPENSER OR THE LENGTH AT WHICH THE HOSE AND NOZZLE ASSEMBLY MAY BE OPERATED PLUS A MINIMUM OF ONE FOOT, WHICHEVER IS GREATER) MUST HAVE IMPERMEABLE FLOORS (I.E., PORTLAND CEMENT CONCRETE OR EQUIVALENT SMOOTH IMPERVIOUS SURFACE) THAT ARE (1) GRADED AT THE MINIMUM SLOPE NECESSARY TO PREVENT PONDING; AND (2) SEPARATED FROM THE REST OF THE SITE BY A GRADE BREAK THAT PREVENTS RUN-ON OF STORM WATER TO THE MEP.
2. FUELING AREAS MUST BE COVERED BY A CANOPY THAT EXTENDS A MINIMUM OF TEN FEET IN EACH DIRECTION FROM EACH PUMP. (ALTERNATIVE: THE FUELING AREA MUST BE COVERED AND THE COVER'S MINIMUM DIMENSIONS MUST BE EQUAL TO OR GREATER THAN THE AREA WITHIN THE GRADE BREAK OR FUEL DISPENSING AREA.) THE CANOPY (OR COVER) MUST NOT DRAIN ONTO THE FUELING AREA. IF POSSIBLE USE A PERIMETER DRAIN OR SLOPE PAVEMENT INWARD WITH DRAINAGE TO A BLIND SUMP (MUST BE PROPERLY MAINTAINED AND WATER PROPERLY DISPOSED OF); PAVE AREA WITH CONCRETE RATHER THAN ASPHALT.
- SC-N
- LOADING DOCKS COVERAGE AND GRADING REQUIREMENTS
1. ROOF DOWNSPOUTS MUST BE POSITIONED TO DIRECT STORM WATER AWAY FROM THE LOADING AREA. WATER FROM LOADING DOCK AREAS SHOULD BE DRAINED TO THE SANITARY SEWER WHERE FEASIBLE. DIRECT CONNECTIONS TO STORM DRAINS FROM DEPRESSED LOADING DOCKS ARE PROHIBITED.
2. LOADING DOCK AREAS DRAINING DIRECTLY TO THE SANITARY SEWER MUST BE EQUIPPED WITH A SPILL CONTROL VALVE OR EQUIVALENT DEVICE, WHICH MUST BE KEPT CLOSED DURING PERIODS OF OPERATION.
3. PROVIDE A ROOF OVERHANG OVER THE LOADING AREA OR INSTALL DOOR SKIRTS (COWLING) AT EACH BAY THAT ENCLOSE THE END OF THE TRAILER.
- SC-O
- FIRE SPRINKLER TEST WATER
1. SHOW DRAINAGE CONNECTION TO DRAIN FIRE SPRINKLER WATER TO THE SANITARY SEWER.
- SC-P
- MISCELLANEOUS DRAIN OR WASH WATER
1. BOILER DRAIN LINES MUST BE DIRECTLY OR INDIRECTLY CONNECTED TO THE SANITARY SEWER SYSTEM AND MAY NOT DISCHARGE TO THE STORM DRAIN SYSTEM.
2. CONDENSATE DRAIN LINES MAY DISCHARGE TO LANDSCAPED AREAS IF THE FLOW IS SMALL ENOUGH THAT RUNOFF WILL NOT OCCUR. CONDENSATE DRAIN LINES MAY NOT DISCHARGE TO THE STORM DRAIN SYSTEM.
3. ROOFTOP MOUNTED EQUIPMENT WITH POTENTIAL TO PRODUCE POLLUTANTS MUST BE ROOFED AND/OR HAVE SECONDARY CONTAINMENT.
4. ANY DRAINAGE SUMPS ONSITE MUST FEATURE A SEDIMENT SUMP TO REDUCE THE QUANTITY OF SEDIMENT IN PUMPED WATER.
5. AVOID ROOFING, GUTTERS, AND TRIM MADE OF COPPER OR OTHER UNPROTECTED METALS THAT MAY LEACH INTO RUNOFF.
- SC-Q
- PLAZAS, SIDEWALKS, AND PARKING LOTS
1. IDENTIFY AREAS AND PROVIDE ADEQUATE DRAINAGE. PROVIDE STORM WATER QUALITY MEASURES OR EXPLANATION.
- SC-6A
- LARGE TRASH GENERATING FACILITY BMPS
83. ENCLOSURES SHALL BE STRUCTURALLY STRONG AND CONSTRUCTED OF REINFORCED MASONRY BLOCK OR WOOD PANELS/BOARDS. REFER TO COUNTY STAFF FOR SPECIFIC GUIDELINES.
3. THE ENCLOSURE SLAB SHOULD BE DESIGNED TO KEEP STORM WATER DRAINAGE OUT OF THE ENCLOSURE AREA. TYPICALLY SLOPED AT 0.5%. SLAB CONSTRUCTION SPECIFICATIONS WILL VARY ACCORDING TO METHODS OF CONSTRUCTION, BUT SHOULD BE AT LEAST 4 INCHES OF REINFORCED CONCRETE.
4. STURDY GATES/DOORS SHALL BE INSTALLED ON ALL ENCLOSURES. GATES SHOULD NOT BE MOUNTED DIRECTLY ONTO THE BLOCK WALL OR INSIDE OF ENCLOSURE. THE ENCLOSURE SHOULD INCLUDE HARDWARE TO SECURE THE GATE'S DOORS BOTH OPEN AND CLOSED (I.E., CANE BOLT W/SLEEVE AND LATCH BETWEEN DOORS AND SLEEVE IN PAVEMENT).
5. TO PREVENT TRASH ENCLOSURES FROM CONTRIBUTING TO STORM WATER RUNOFF POLLUTION, ALL ENCLOSURES MUST BE FITTED WITH A ROOF DEIGNED TO DRAIN INTO ON-SITE LANDSCAPE AREAS (WHERE NECESSARY) AND/OR TO APPROPRIATE BMPS. THE ROOF MUST PROVIDE SUFFICIENT CLEARANCE TO ALLOW THE DUMPSTER LID TO OPEN TO THE 90 DEGREE POSITION.
6. ENCLOSURE ROOFS NOT CONFORMING TO COUNTY SPECIFICATIONS FOR PATIO COVERS MAY REQUIRE A BUILDING PERMIT. GENERALLY ROOFS NOT MORE THAN 12 FEET IN HEIGHT ABOVE GRADE AND CONSTRUCTED WITH CONVENTIONAL LIGHT-FRAME WOOD CONSTRUCTION ARE CONSIDERED ACCEPTABLE. THE USE OF METAL ROOFS IS NOT RECOMMENDED AS THEY CAN ACT AS A SOURCE OF POLLUTANTS.
- SC-6B
- ANIMAL FACILITIES
1. DRY WEATHER RUNOFF MUST BE CONTROLLED. DRY WEATHER RUNOFF FROM HOSED OFF AREAS AS PART OF ANIMAL FACILITY OPERATIONS MUST NOT DRAIN TO THE MS4. DRY WEATHER FLOWS SHOULD BE RETAINED ON-SITE THROUGH IMPLEMENTATION OF BMPS OR COLLECTED AND DISCHARGED TO THE SANITARY SEWER.
2. OUTDOOR ACTIVITY AREAS MUST BE IDENTIFIED ON SITE PLANS. PLAN REVIEWERS MUST BE ABLE TO ENSURE THAT RUNOFF FROM THESE AREAS IS EITHER DIVERTED TO THE SANITARY SEWER OR DIRECTED TO APPROPRIATE TREATMENT BMPS. ON-SITE INSPECTION OF FACILITIES, GRADING, AND DRAINAGE MAY BE REQUIRED.
3. TRASH ENCLOSURES WITHIN ANIMAL FACILITIES MUST BE COVERED TO MINIMIZE DIRECT PRECIPITATION AND PREVENT RAINFALL FROM ENTERING ENCLOSURES. STRUCTURAL OVERHEAD COVERS ARE REQUIRED AS CONTAINER LIDS ARE OFTEN LEFT OPEN.
- SC-6C
- PLANT NURSERIES AND GARDEN FACILITIES
1. OWNER MUST PROVIDE BMP STORMWATER TRAINING TO APPROPRIATE EMPLOYEES. EMPLOYEE PARTICIPATION IS REQUIRED TO ENSURE THAT SOURCE CONTROLS ARE PROPERLY MAINTAINED AND BEHAVIORAL BMPS ARE FOLLOWED.
2. ELIMINATE OVERWATERING AND OVER SPRAYING OF PLANTS. OVERWATERING AND OVER SPRAYING OF PLANTS INCREASES DRY WEATHER FLOWS AND POLLUTANT LOADING, AND WASTES WATER. DELIVERY SYSTEMS AND SCHEDULES SHOULD ACCOUNT FOR DIFFERENT PLANT TYPES AND CONTAINERS.
3. DISCHARGES FROM OUTDOOR WATERING AREAS MUST BE CONTROLLED. REGULAR RUNOFF FROM OUTDOOR WATERING CAN CONTRIBUTE UN-AUTHORIZED DRY WEATHER FLOWS TO THE MS4 (E.G., RUNOFF FROM WATERING THE PLANTS AT GARDEN CENTERS). RUNOFF WATER IS ALSO LIKELY TO BE POLLUTED BY POTTING SOIL MIXES AND PLANTS THAT CONTAIN FERTILIZERS AND/OR PESTICIDES. SO, REGULAR RUNOFF SHOULD BE TREATED AND/OR RETAINED ON-SITE THROUGH BMPS OR DISCHARGED TO THE SANITARY SEWER.
- SC-6D
- AUTOMOTIVE FACILITY BMPS
1. AUTO REPAIR, MAINTENANCE ACTIVITIES, FUELING, AND VEHICLE WASHING MUST BE CONDUCTED IN COVERED AREAS. COVERS 10 FEET HIGH OR LESS SHOULD HAVE A MINIMUM OVERHANG OF 3 FEET ON EACH SIDE. COVERS HIGHER THAN 10 FEET SHOULD HAVE A MINIMUM OVERHANG OF 5 FEET ON EACH SIDE. OVERHANG SHOULD BE MEASURED FROM THE PERIMETER OF THE HYDRAULICALLY ISOLATED ACTIVITY AREA.
2. ACTIVITY AREAS SHOULD BE PROTECTED FROM RUN-ON THROUGH THE USE OF GRADING, BERMS, OR DRAINS. DIRECT DRAINAGE FROM THE HYDRAULICALLY ISOLATED AREA TO AN APPROVED SANITARY SEWER OR A BMP.
3. PAVE ACTIVITY AREAS WITH HYDRAULIC CONCRETE OR APPROPRIATELY SEALED ASPHALT CEMENT.

SITE DESIGN BMP REQUIREMENTS:

ALL DEVELOPMENT PROJECTS MUST IMPLEMENT SITE DESIGN BMPS 4.3.1 THROUGH 4.3.8 WHERE APPLICABLE AND FEASIBLE. SEE CHAPTER 4.3 AND APPENDIX E OF THE COUNTY BMP DESIGN MANUAL FOR INFORMATION TO IMPLEMENT SITE DESIGN BMPS SHOWN IN THIS CHECKLIST.

- 4.3.1
- MAINTAIN NATURAL DRAINAGE PATHWAYS AND HYDROLOGIC FEATURES
1. A SETBACK OF 50 TO 200 FEET IS REQUIRED FOR DEVELOPMENT ADJACENT TO WATERS OF THE U.S. NO STRUCTURAL BMPS ARE TO BE PLACED IN BUFFER ZONES.
2. USE A CONSTRUCTION FENCE OR SILT FENCE AROUND THE BUFFER ZONE TO PREVENT CONSTRUCTION EQUIPMENT FROM ENTERING.
- 4.3.2
- CONSERVE NATURAL AREAS, SOILS AND VEGETATION
- 4.3.3
- MINIMIZE IMPERVIOUS AREA
- 4.3.4
- MINIMIZE SOIL COMPACTION
- 4.3.5
- DISPERSE IMPERVIOUS AREAS
- 4.3.6
- COLLECTION OF RUN-OFF
- 4.3.7
- LANDSCAPE WITH NATIVE OR DROUGHT TOLERANT SPECIES

ADDITIONAL BMP NOTES:

1. THESE BMPS ARE MANDATORY TO BE INSTALLED PER MANUFACTURER'S RECOMMENDATIONS OR THESE PLANS.
2. NO CHANGES TO THE PROPOSED BMPS ON THIS SHEET WITHOUT PRIOR APPROVAL FROM THE COUNTY.
3. NO SUBSTITUTIONS TO THE MATERIAL, TYPES, OR PLANTING TYPES WITHOUT PRIOR APPROVAL FROM THE COUNTY ENGINEER.
4. NO OCCUPANCY WILL BE GRANTED UNTIL THE COUNTY STAFF HAS INSPECTED THIS PROJECT FOR APPROPRIATE BMP CONSTRUCTION AND INSTALLATION.
5. ALL VEGETATED BMPS SHALL BE SHOWN ON LANDSCAPE PLANS PER PERMIT #_____.
6. REFER TO THE MAINTENANCE PLAN IN ATTACHMENT 3 OF SWQMP FOR ACCESS TO STRUCTURAL BMPS TO INSPECT AND PERFORM MAINTENANCE, FEATURES PROVIDED TO FACILITATE INSPECTION, MAINTENANCE THRESHOLDS, RECOMMENDED EQUIPMENT TO PERFORM MAINTENANCE, AND SPECIAL TRAINING OR CERTIFICATION REQUIREMENTS FOR INSPECTION AND MAINTENANCE PERSONNEL.
7. ALL GRADING CONTOURS SHALL BE CONSISTENT WITH DMA EXHIBIT.
8. SEE PROJECT SWQMP FOR ADDITIONAL INFORMATION.

SOURCE CONTROL BMPS				
SYMBOL	QUANTITY	BMP TYPE	BMP DM FACT SHEET ID	SHEET NO. (S)
SITE DESIGN BMPS				
SYMBOL	QUANTITY	BMP TYPE	BMP DM FACT SHEET ID	SHEET NO. (S)

BMP STORMWATER MANAGEMENT NOTES:

1. DURING THE RAINY SEASON THE AMOUNT OF EXPOSED SOIL ALLOWED AT ONE TIME SHALL NOT EXCEED THAT WHICH CAN BE ADEQUATELY PROTECTED BY THE PROPERTY OWNER IN THE EVENT OF A RAINSTORM. 125% OF ALL SUPPLIES NEEDED FOR BMP MEASURES SHALL BE RETAINED ON THE JOB SITE IN A MANNER THAT ALLOWS FULL DEPLOYMENT AND COMPLETE INSTALLATION IN 48 HOURS OR LESS OF A FORECAST RAIN.
2. NO AREA BEING DISTURBED SHALL EXCEED 50 ACRES AT ANY GIVEN TIME WITHOUT DEMONSTRATING TO THE SAN DIEGO COUNTY DPW DIRECTOR'S SATISFACTION THAT ADEQUATE EROSION AND SEDIMENT CONTROL CAN BE MAINTAINED. ANY DISTURBED AREA THAT IS NOT ACTIVELY GRADED FOR 15 DAYS MUST BE FULLY PROTECTED FROM EROSION. UNTIL ADEQUATE LONG-TERM PROTECTIONS ARE INSTALLED, THE DISTURBED AREA SHALL BE INCLUDED WHEN CALCULATING THE ACTIVE DISTURBANCE AREA. ALL EROSION CONTROL MEASURES SHALL REMAIN INSTALLED AND MAINTAINED DURING ANY INACTIVE PERIOD.
3. THE PROPERTY OWNER IS OBLIGATED TO INSURE COMPLIANCE WITH ALL APPLICABLE STORMWATER REGULATIONS AT ALL TIMES. THE BMP'S (BEST MANAGEMENT PRACTICES) THAT HAVE BEEN INCORPORATED INTO THIS PLAN SHALL BE IMPLEMENTED AND MAINTAINED TO EFFECTIVELY PREVENT THE POTENTIALLY NEGATIVE IMPACTS OF THIS PROJECT'S CONSTRUCTION ACTIVITIES ON STORMWATER QUALITY. THE MAINTENANCE OF THE BMP'S IS THE PERMITTEE'S RESPONSIBILITY, AND FAILURE TO PROPERLY INSTALL OR MAINTAIN THE BMP'S MAY RESULT IN ENFORCEMENT ACTION BY THE COUNTY OF SAN DIEGO OR OTHERS. IF INSTALLED BMP'S FAIL, THEY MUST BE REPAIRED OR REPLACED WITH AN ACCEPTABLE ALTERNATE WITHIN 24 HOURS, OR AS SOON AS SAFE TO DO SO.
4. ON PROJECTS OF GREATER THAN 1 ACRE ADD THE FOLLOWING NOTE: A NOTICE OF INTENT (NOI) HAS BEEN, OR WILL BE FILED WITH THE STATE WATER RESOURCES CONTROL BOARD (SWRCB) AND THAT A STORMWATER POLLUTION PREVENTION PLAN (SWPPP) HAS BEEN OR WILL BE PREPARED IN ACCORDANCE WITH THE REQUIREMENTS OF CALIFORNIA GENERAL PERMIT FOR STORMWATER DISCHARGES ASSOCIATED WITH CONSTRUCTION ACTIVITY (R9-2015-0001 AND R9-2015-0100, NPDES NO. CAS0109266) FOR ALL OPERATIONS ASSOCIATED WITH THESE PLANS. THE NOI NUMBER ASSIGNED BY SWRCB FOR THIS PROJECT IS [WDID#] [ALTERNATIVE: NOT YET ASSIGNED, BUT WILL BE PROVIDED BEFORE A PERMIT IS ISSUED]. THE PERMITTEE SHALL KEEP A COPY OF THE SWPPP ON SITE AND AVAILABLE FOR REVIEW BY COUNTY.

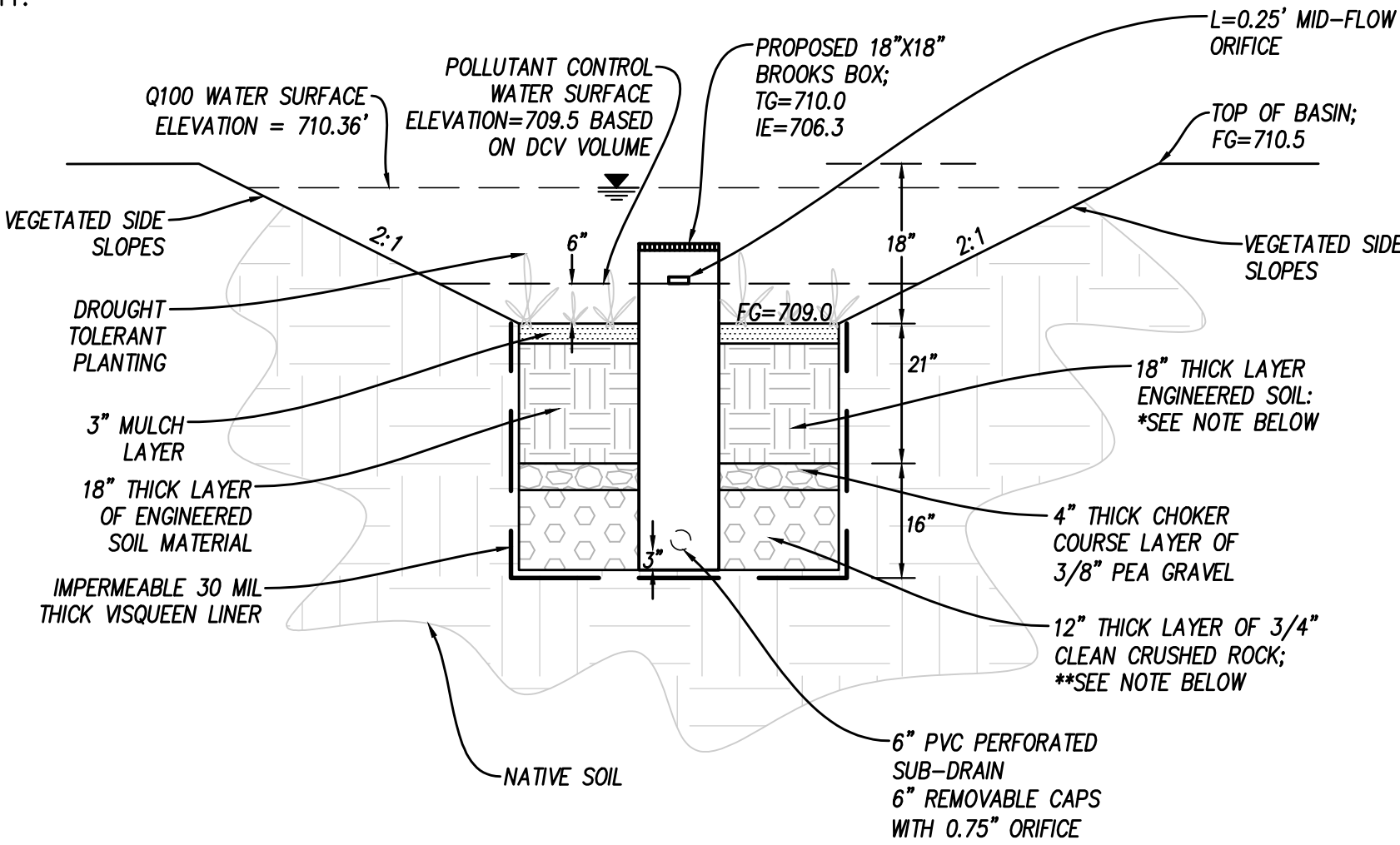
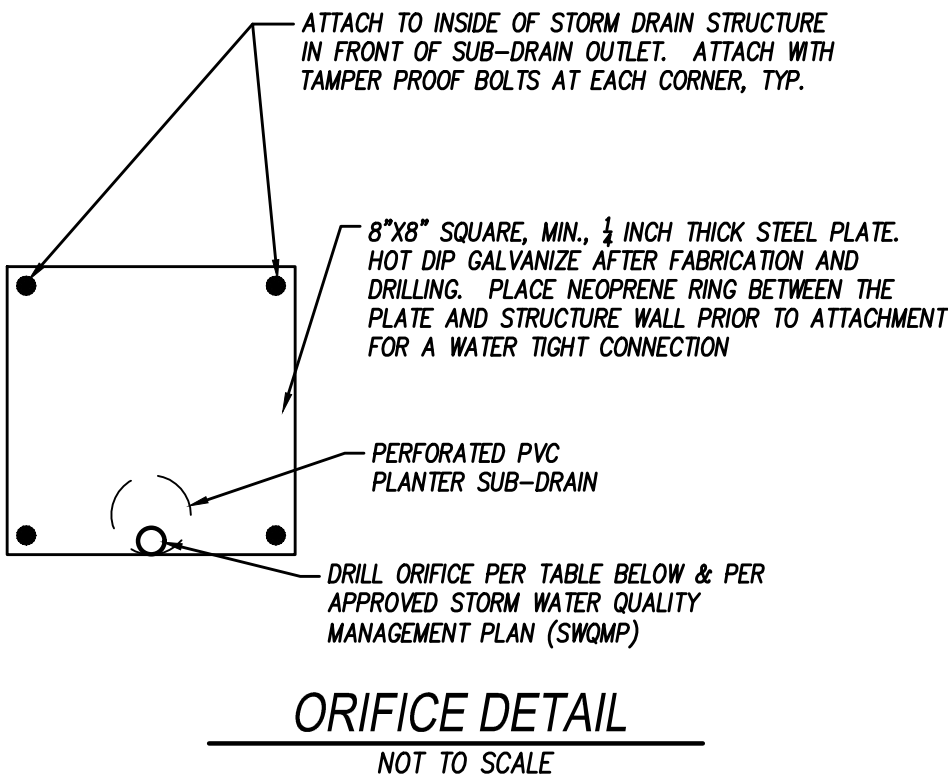

FINISHED GRADE OF BASIN SHALL BE LESS THAN OR EQUAL TO 2%

*"ENGINEERED SOIL" LAYER SHALL BE MINIMUM 18" DEEP "SANDY LOAM" SOIL MIX WITH 20% SANDY LOAM (SAND, SILT, & CLAY) CONTENT. THE MIX SHALL CONTAIN 65% SAND, AND 15% COMPOST OR HARDWOOD MULCH. BSM SHOULD ACHIEVE LONG-TERM, IN-PLACE INFILTRATION RATE OF 5 INCHES PER HOUR, ACCORDING TO THE COUNTY OF SAN DIEGO 2012 STANDARD URBAN STORMWATER MITIGATION PLAN (SUSMP) REQUIREMENTS. POLUTANT CONTROL TREATMENT PERFORMANCE STANDARDS IN SECTION F.1.1 FROM THE SAN DIEGO COUNTY LID HANDBOOK MUST BE MET

**3/4" CRUSHED ROCK LAYER SHALL BE A MINIMUM OF 12" BUT MAY BE DEEPEENED TO INCREASE THE INFILTRATION AND STORAGE ABILITY OF THE DETAIL.

AT-GRADE BIOFILTRATION PLANTER - TYPICAL DETAIL

NOT TO SCALE



GRADING PLAN CERTIFICATION:

I, CERTIFY THAT THE GRADING AS SHOWN ON THIS MINOR GRADING PLAN SATISFIES THE REQUIREMENTS OF THE COUNTY OF SAN DIEGO GRADING ORDINANCE.

BY: _____ DATE: _____

RCE NO.: C80667

THE COUNTY IS NOT RESPONSIBLE FOR THE DESIGN IN ANYWAY.

BY: _____ DATE: _____
FOR: VINCE NICOLETTI, DIRECTOR, DEPARTMENT OF PLANNING & DEVELOPMENT SERVICES

COUNTY APPROVED CHANGES			PRIVATE CONTRACT		
DESCRIPTION:	APPROVED BY:	DATE:	SHEET 2	COUNTY OF SAN DIEGO DEPARTMENT OF PUBLIC WORKS	07 SHEETS
SOURCE CONTROL AND SITE DESIGN BMP NOTES:					
2255 EUCLID AVE					
CALIFORNIA COORDINATE INDEX 226-1797					
APPROVED FOR: SAHAR NUNALI, COUNTY ENGINEER			ENGINEER OF WORK:		
SEE CERTIFICATION			R.C.E.: C80667		
			GRADING PERMIT NO: PDS2024-LDGRMN-20405		

HELIX WATER DISTRICT NOTES

1. IT SHALL BE THE CONTRACTOR'S RESPONSIBILITY TO CONTACT HELIX WATER DISTRICT 48 HOURS PRIOR TO COMMENCING WORK AT (619) 596-3860 AND UNDERGROUND SERVICE ALERT FOR LOCATION OF EXISTING WATER FACILITIES AT 1-800-422-4133.
2. CONTRACTOR TO PROTECT ALL EXISTING HELIX WATER DISTRICT FACILITIES AND SHALL BE FINANCIALLY RESPONSIBLE FOR ANY DAMAGE TO HELIX WATER DISTRICT FACILITIES AS A RESULT OF HIS/HER OPERATION, AND SHALL IMMEDIATELY CALL THE HELIX WATER DISTRICT WHO WILL REPAIR ANY DAMAGE AND WILL BILL THE DEVELOPER FOR THE COST INCURRED. CONTRACTOR TO PROVIDE CONTINUOUS WATER SERVICE TO ALL WATER ACCOUNTS SHOWN OR NOT SHOWN ON THESE PLANS DURING ALL PHASES OF CONSTRUCTION. CONTRACTOR SHALL PROVIDE DISTRICT ACCESS TO WATER FACILITIES DURING ALL PHASES OF CONSTRUCTION.
3. APPROVAL/REVIEW OF PLANS BY HELIX WATER DISTRICT DOES NOT CONSTITUTE RESPONSIBILITY FOR ACCURACY OF INFORMATION NOR LOCATIONS OF ANY EXISTING UTILITIES.
4. DEVELOPER SHALL BE RESPONSIBLE FOR THE COST OF RELOCATING ANY WATER LATERALS, FIRE HYDRANTS OR FACILITIES THAT FALL WITHIN DRIVEWAYS OR OTHERWISE CONFLICT WITH ANY PROPOSED FACILITIES OR IMPROVEMENTS.
5. CONTRACTOR SHALL BE RESPONSIBLE FOR RELOCATION OR ADJUSTMENT OF ANY NEW OR EXISTING WATER SERVICE APPURTENANCES, MANHOLES, GATE VALVE COVERS, OR METER BOXES TO NEW FINISH GRADE.
6. ALL UNDERGROUND UTILITIES AND LATERALS SHALL BE INSTALLED BEFORE CONSTRUCTION OF CURBS, CONCRETE CROSS GUTTERS, SIDEWALK OR SURFACING OF STREETS.
7. DEVELOPER AGREES THAT IF THEY, THEIR EMPLOYEES, AGENTS, OR ANY INDEPENDENT CONTRACTORS OR SUBCONTRACTORS SHOULD USE WATER OTHER THAN THROUGH AN AUTHORIZED WATER METER, DEVELOPER SHALL PAY A CHARGE, DETERMINED BY HELIX WATER DISTRICT, PER OCCURRENCE FOR SAID USE. SAID PAYMENT MAY BE DEDUCTED FROM ANY DEPOSIT DEVELOPER HAS WITH HELIX WATER DISTRICT.
8. NO PERSON, OTHER THAN AN EMPLOYEE OR AGENT OF THE HELIX WATER DISTRICT, SHALL HAVE A RIGHT TO OPERATE ANY PART OF A HELIX WATER DISTRICT WATER DISTRIBUTION SYSTEM AND FIRE HYDRANTS. ANY PERSON WHO TAMPERS OR INTERFERES WITH ANY PART OR COMPONENT OF SAID SYSTEM, OR CAUSES OR PERMITS ANY ACT OF TAMPERING OR INTERFERING WITH THE SYSTEM, SHALL BE LIABLE FOR ANY INJURY OR DAMAGE CAUSED THEREBY OR RESULTING THERE FROM. A CHARGE, DETERMINED BY HELIX WATER DISTRICT, PER OCCURRENCE WILL BE IMPOSED ON ANY PERSON OR COMPANY WHO OPERATES ANY PART OF THE HELIX WATER DISTRICT WATER SYSTEM WITHOUT PROPER AUTHORIZATION.
9. FOR WORK OVER EXISTING WATER FACILITIES, HEAVY EQUIPMENT (ABOVE H20 LOADING) SHALL NOT BE USED WHEN COVER OVER THE WATER MAIN IS LESS THAN THREE (3) FEET THROUGH ALL PHASES OF CONSTRUCTION, INCLUDING THE REMOVAL AND/OR INSTALLATION OF PAVEMENT SECTIONS.
10. DEVELOPER/CONTRACTOR SHALL INSTALL ONLY HIGH EFFICIENCY APPLIANCES, USE ONLY HIGH EFFICIENCY TECHNOLOGIES AND LANDSCAPE USING LOW WATER USE PLANTS. DEVELOPER/CONTRACTOR SHALL COORDINATE THE INSTALLATION OF WATER EFFICIENT APPLIANCES, TECHNOLOGIES AND LANDSCAPING WITH HELIX WATER DISTRICT REPRESENTATIVE. CONTACT THE DISTRICT'S PUBLIC AFFAIRS GROUP AT CONSERVE@HELIXWATER.ORG FOR INSPECTION AND COORDINATION.
11. CONTRACTOR IS TO COORDINATE THE LOCATION OF ANY PROPOSED FIRE PROTECTION FACILITIES WITH THE FIRE DEPARTMENT OF JURISDICTION, PRIOR TO INSTALLATION OF THE FACILITIES.
12. COMMERCIAL AND MULTIPLE DWELLING PROPERTIES WITH MORE THAN 5,000 SQUARE FEET OF IRRIGATED LANDSCAPE MUST HAVE A SEPARATE WATER METER FOR LANDSCAPE PURPOSES.

13. ANY EXISTING WATER SERVICES SERVING THE PROPERTY THAT WILL NOT BE USED SHALL BE ABANDONED BY THE DISTRICT AT THE OWNER'S EXPENSE.
14. ANY FINISHED SURFACE IMPROVEMENT OTHER THAN ASPHALT ABOVE THE PIPELINE OR UNDERGROUND FACILITIES, WILL REQUIRE AN ENCROACHMENT REMOVAL AGREEMENT. PERMEABLE FINISHED SERVICE IMPROVEMENTS ARE PROHIBITED WITHIN HELIX WATER DISTRICT WATER MAIN EASEMENT.
15. TRENCH REPAIR IS TO BE BY HELIX WATER DISTRICT TRENCH DETAIL OR THE CITY OR COUNTY TRENCH REPAIR DETAIL, WHICHEVER IS MORE STRINGENT.
16. BACKFLOW PREVENTION WILL BE REQUIRED ON EACH WATER METER SERVING COMMERCIAL PROPERTIES, PROPERTIES WITH FIRE SPRINKLER SYSTEMS AND/OR ON LANDSCAPE IRRIGATION WATER METERS. CONTACT THE DISTRICT'S CROSS-CONNECTION CONTROL COORDINATOR AT 619 667-6224. SUBMIT CUT SHEETS OF THE PROPOSED BACKFLOW PREVENTION DEVICES FOR APPROVAL
17. RESIDENTIAL DWELLINGS WITH FIRE PROTECTION SYSTEMS SHALL HAVE A TESTABLE BACKFLOW PREVENTION ASSEMBLY (BPA) ON EACH WATER SERVICE OR A PASSIVE PURGE SYSTEM INSTALLED FOR SYSTEM PROTECTION. COORDINATE APPROVAL OF THE BPA WITH THE DISTRICT'S CROSS CONNECTION CONTROL COORDINATOR AT 619-667-6224. IF PASSIVE PURGE IS SELECTED FOR BACKFLOW PREVENTION, BUILDING PLANS SHOWING THE PASSIVE PURGE SYSTEM SHALL BE SUBMITTED FOR REVIEW AND APPROVAL PRIOR TO IMPROVEMENT PLAN APPROVAL. THE WATER METER WILL NOT BE ACTIVATED UNTIL THE PASSIVE PURGE SYSTEM HAS BEEN COMPLETED OR A TEMPORARY BACKFLOW METER PROTECTION IS IN PLACE.
18. ALL WATER SERVICE LATERALS, FIRE SERVICE LATERALS, FIRE HYDRANT LATERALS, BLOW-OFF LATERALS AND WATER MAINS THAT CROSS ANY BIO-RETENTION SWALE, MUST BE WITHIN A HARDENED SURFACE (CONCRETE).
19. ROOF DRAINS OR DOWN SPOUTS FROM HOMES OR BUILDINGS ARE PROHIBITED FROM DISCHARGING WATER IN OR NEAR WATER METER BOXES.
20. FOR NEW SEWER MAINS OR STORM DRAINS CROSSING BENEATH EXISTING WATER MAINS, CONTRACTOR SHALL PROTECT THE EXISTING MAIN PER WATER AGENCIES' STANDARD DRAWING WP-09 OR REPLACE THE EXISTING WATER MAIN WITH NEW PVC PIPE AT THE DISCRETION OF THE DISTRICT ENGINEER. PIPE REPLACEMENTS SHALL EXTEND A MINIMUM OF 2' BEYOND THE EDGE OF THE TRENCH WIDTH ON BOTH SIDES OF THE CROSSING. CONTRACTOR SHALL NOTIFY THE DISTRICT A MINIMUM OF 48 HOURS PRIOR TO CROSSING UNDER ANY EXISTING WATER MAIN AND SHALL COORDINATE THE INSPECTION OF ALL WORK RELATED TO THE PROTECTION OF EXISTING WATER FACILITIES WITH THE DISTRICT INSPECTOR.
21. UNLESS SHOWN ON THESE PLANS, PRIVATE WATER LINES AND OTHER PRIVATE UTILITIES (PROPOSED OR EXISTING) SHALL NOT RUN PARALLEL WITHIN A WATER LINE EASEMENT. ANY NEW PRIVATE UTILITIES THAT CROSS EXISTING WATER MAINS OR LATERALS SHALL CROSS PERPENDICULARLY ONLY, WITH A MINIMUM OF 1' VERTICAL SEPARATION PER WATER AGENCIES' STANDARD DRAWING WI-02. CONTRACTOR SHALL INSTALL WARNING/IDENTIFICATION TAPE 12" ABOVE THE PRIVATE LINE TO 5' EACH SIDE OF THE CROSSING LOCATION. ANY NEW PRIVATE ELECTRICAL OR GAS LINES THAT CROSS EXISTING WATER MAINS OR LATERALS SHALL BE PLACED IN A CASING AND ENCASED IN CONCRETE (RED COLORED CONCRETE FOR ELECTRICAL CONDUITS) TO 5' EACH SIDE OF THE WATER MAIN OR LATERAL. ADDITIONALLY, ANY DISTURBANCE IN THE TRENCH LINE OF ANY EXISTING WATER FACILITIES SHALL BE BACKFILLED WITH THE MATERIALS AS APPROVED PER THE WATER AGENCIES' STANDARDS.
22. HELIX WATER DISTRICT WILL PERFORM THE WORK APPROXIMATELY TWENTY (20) WEEKS AFTER APPROVAL OF ALL REQUIRED PROJECT DOCUMENTS. CONTRACTOR TO INSTALL ANY REQUIRED BACKFLOW PREVENTION DEVICES AND CONNECT PRIVATE PLUMBING.

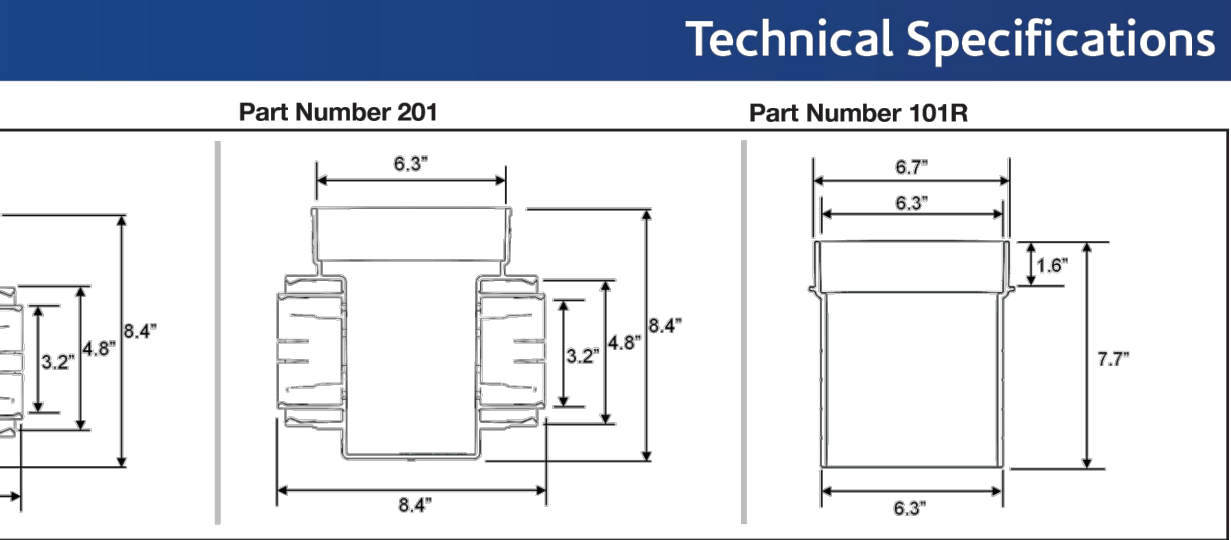
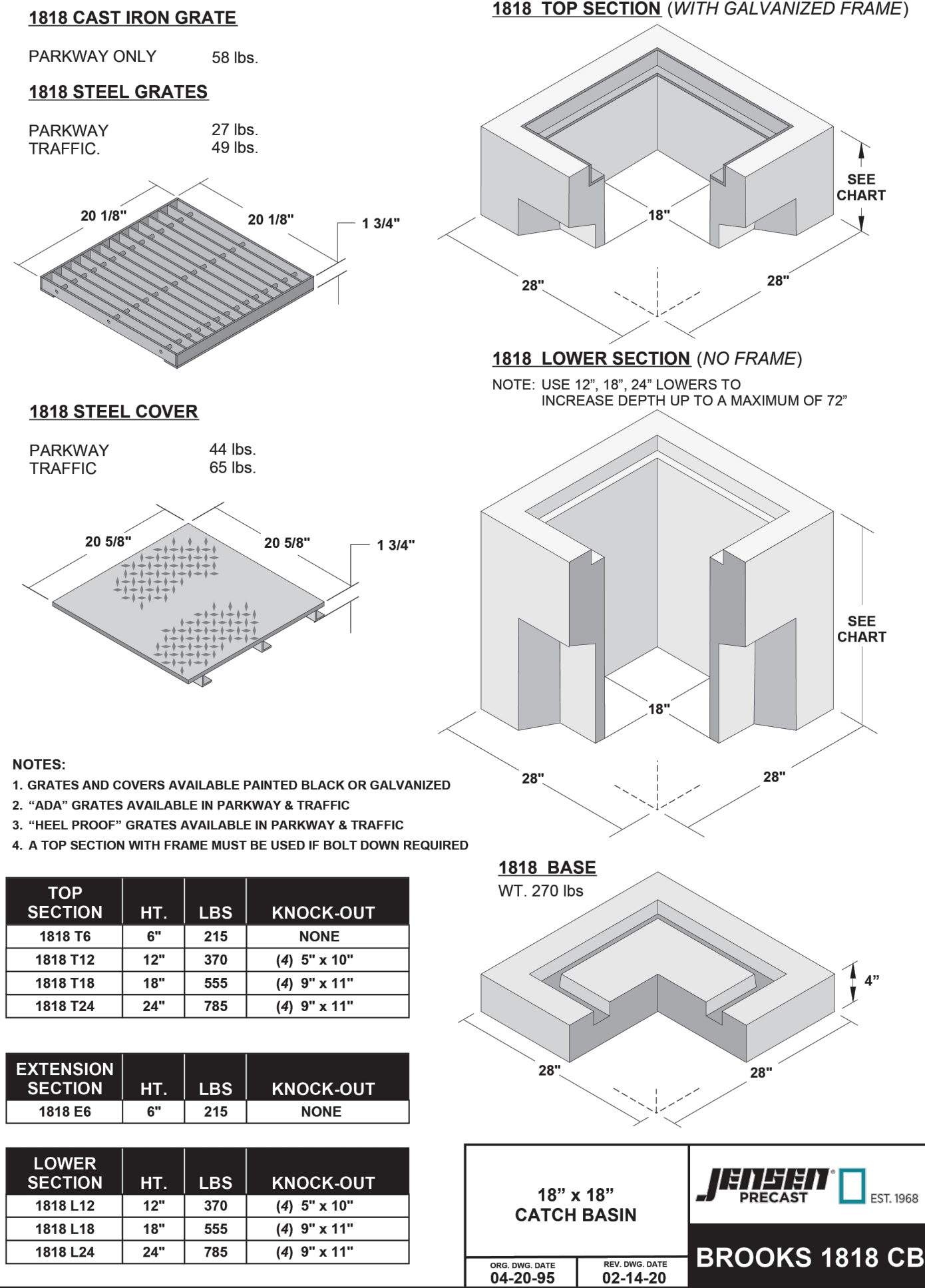

NDS Spee-D® Catch Basin Drains

Part Number	Material	Description	Flow Rate*
101	HIPS with UV protection	6 in. Round Spee-D Catch Basin Drain with one outlet	Based on type of grate installed
201	HIPS with UV protection	6 in. Round Spee-D Catch Basin Drain with two outlet	Based on type of grate installed
101GRKIT	Catch basin made of HIPS; grate made of HDPE; both with UV protection	6 in. Round Spee-D Catch Basin Kit with one-outlet basin and 6 in. green round grate	28 GPM

Side View

- Stacking ribs

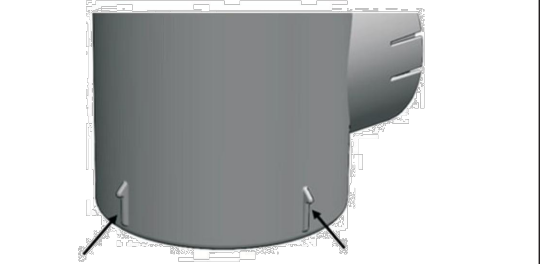

End View

- Inner 3 in. hub knockout
- Knockout guidance

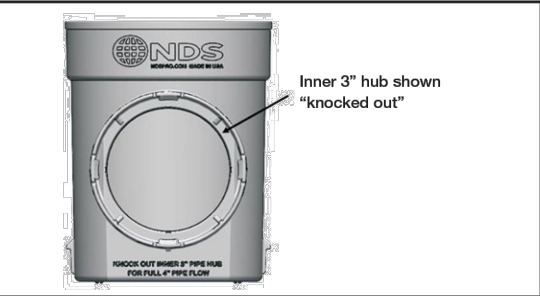

Bottom View

- Weephole knockouts



* Calculated with 0.8 inches of head above grate top

Compatible NDS Accessory

Part Number	Description
101R	Spee-D® Basin Riser, 2 in. to 6 in. nested height

TS_Bin_SpeeD CatchBasin 082023

851 N. Harvard Avenue | Lindsay, CA 93247 | Technical Support: 888-825-4716

More solutions at [ndspro.com](https://www.ndspro.com)

6" NDS AREA DRAIN DETAIL

NO SCALE

ABBREVIATIONS LEGEND

AC	ASPHALT CONCRETE SURFACE
EG	EXISTING GRADE
FS	FINISHED SURFACE
TW	TOP OF WALL
BW	BOTTOM OF WALL
DG	DECOMPOSED GRANITE
TC	TOP OF CURB
EX	EXISTING
FL	FLOW LINE
CONC	CONCRETE
()	EXISTING ELEVATION
HWD	HELIX WATER DISTRICT
TC	TOP OF GRADE
IE	INVERTED ELEVATION
FF	FINISHED FLOOR
FG	FINISHED GRADE
BS	BOTTOM OF SLOPE
TS	TOP OF SLOPE
EA	EDGE OF ASPHALT
EC	EDGE OF CONCRETE

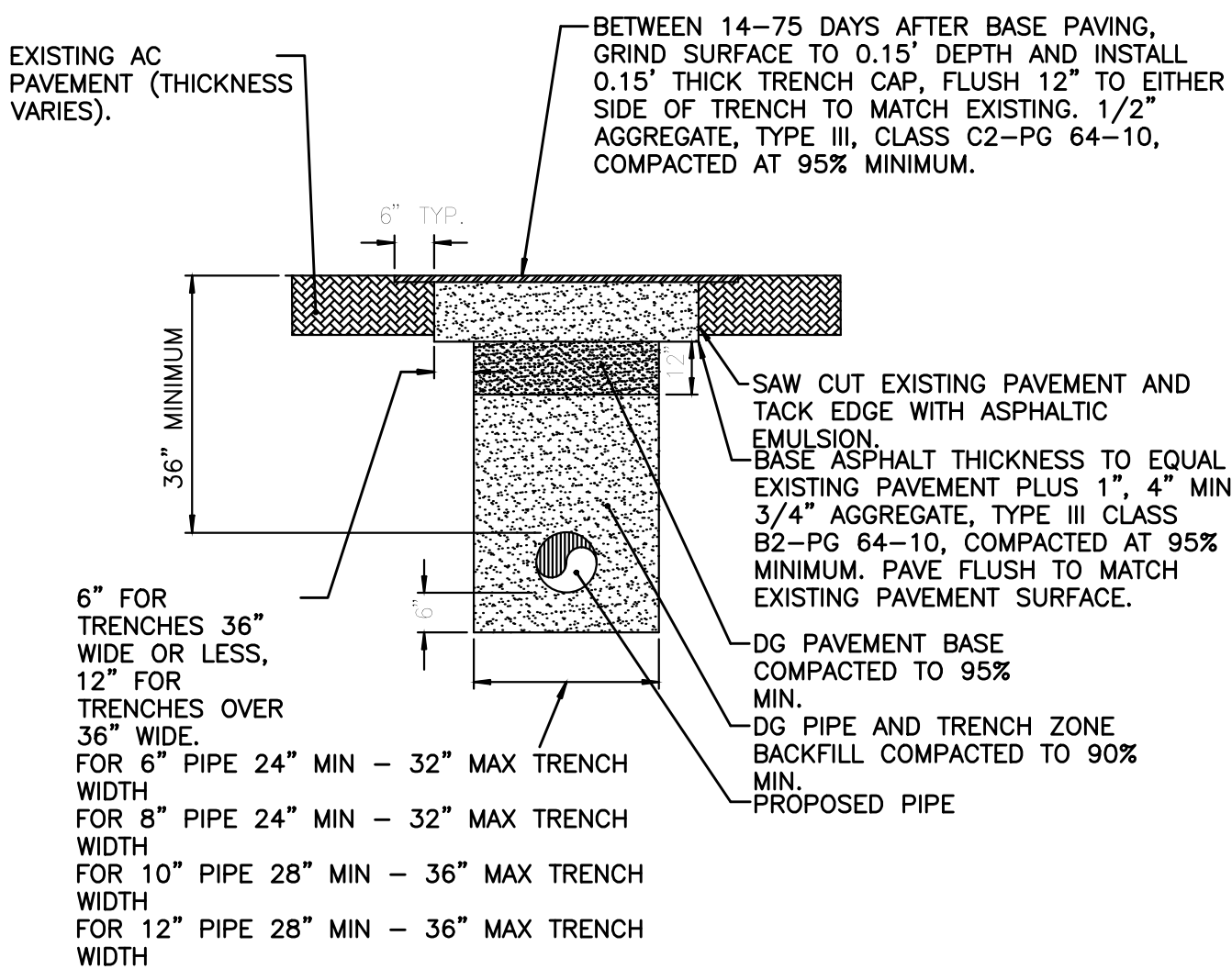

HWD TRENCH REPAIR DETAIL

NO SCALE

GRADING PLAN CERTIFICATION:

I, CERTIFY THAT THE GRADING AS SHOWN ON THIS MINOR GRADING PLAN SATISFIES THE REQUIREMENTS OF THE COUNTY OF SAN DIEGO GRADING ORDINANCE.

BY: _____ DATE: _____

RCE NO.: C80667

THE COUNTY IS NOT RESPONSIBLE FOR THE DESIGN IN ANYWAY.

BY: _____ DATE: _____
FOR: VINCE NICOLETTI, DIRECTOR, DEPARTMENT OF PLANNING & DEVELOPMENT SERVICES

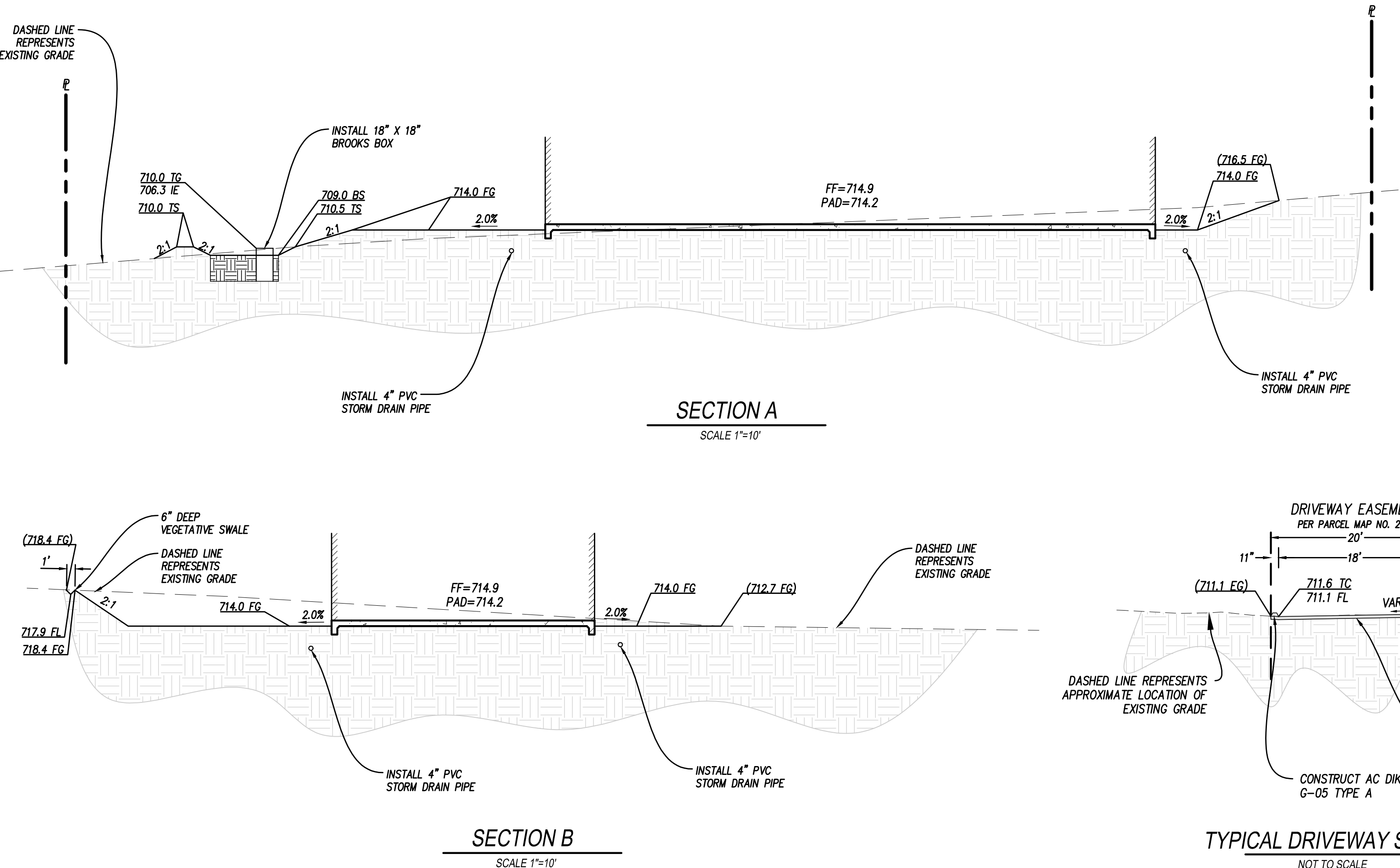

NOTES:

1. A RECORDED PRIVATE DRAINAGE EASEMENT GRANTED TO APN 512-180-36-00 WILL BE REQUIRED PRIOR TO THE SALE OF ANY INDIVIDUAL PARCEL.
2. A RECORDED PRIVATE UTILITY EASEMENT GRANTED TO APN 512-180-35-00 WILL BE REQUIRED PRIOR TO THE SALE OF ANY INDIVIDUAL PARCEL.

APN: 512-180-35

PARCEL 3
PM NO. 2652

SURVEY NOTES

1. THE BEARINGS AND DISTANCES SHOWN HEREON ARE BASED ON A FIELD SURVEY. RECORD DIMENSIONS MAY VARY. THE BOUNDARIES OF ADJOINING PARCELS WERE COMPILED FROM RECORDED OR FIELD DATA, AND ARE TO BE USED FOR PLANNING PURPOSES ONLY.
2. THE LOCATIONS OF UNDERGROUND UTILITY LINES AND/OR STRUCTURES AS SHOWN HEREON ARE BASED ON OBSERVED ABOVE GROUND EVIDENCE AND RECORD INFORMATION PROVIDED TO THE SURVEYOR. NO EXCAVATIONS WERE MADE DURING THE COURSE OF THIS SURVEY TO LOCATE UNDERGROUND UTILITIES. LOCATIONS OF UNDERGROUND UTILITIES MAY VARY FROM LOCATIONS SHOWN HEREON. ADDITIONAL UNDERGROUND UTILITIES MAY EXIST.
3. PRELIMINARY TITLE REPORT PROVIDED BY TICOR TITLE COMPANY DATED FEBRUARY 9, 2022.

CONSTRUCTION NOTES

1. INSTALL 6" NDS AREA DRAIN
2. INSTALL 4" PVC STORM DRAIN PIPE
3. CONSTRUCT PCC MODIFIED HEADWALL PER DETAIL THIS SHEET
4. INSTALL RIP RAP PER SDRSD D-40; ROCK CLASS = No. 2 BACKING THICKNESS = 1.1 FT
5. ALL EXISTING MONUMENT TO BE PROTECTED IN PLACE. ANY MONUMENT DESTROYED DURING CONSTRUCTION SHALL BE REPLACED BY A LICENSED LAND SURVEYOR AND PRE/POST SHALL BE FILED WITH COUNTY RECORDER.
6. INSTALL 18" BROOKS BOX

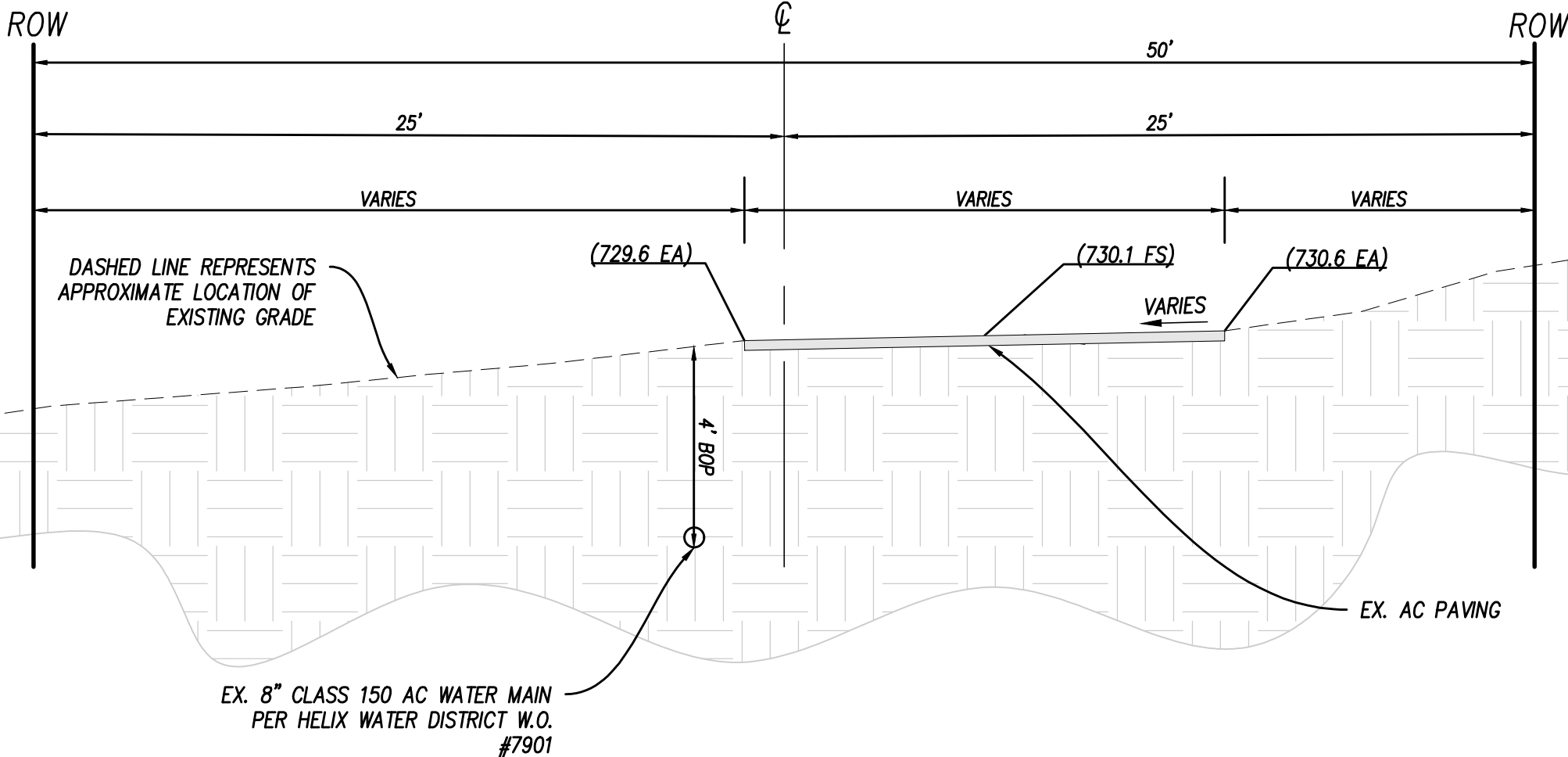

EUCLID TYPICAL SECTION

NOT TO SCALE

ABBREVIATIONS LEGEND

AC ASPHALT CONCRETE SURFACE
EG EXISTING GRADE
FS FINISHED SURFACE
TW TOP OF WALL
BW BOTTOM OF WALL
DC DECOMPOSED GRANITE
TC TOP OF CURB
EX EXISTING
FL FLOW LINE
CONC CONCRETE
() AFFLUENT PUMP TANK
FWD FINISHED FLOOR
TG TOP OF GRADE
IE INVERTED ELEVATION
FF FINISHED FLOOR
FG FINISHED GRADE
BS BOTTOM OF SLOPE
TS TOP OF SLOPE
EA EDGE OF ASPHALT
EC EDGE OF CONCRETE

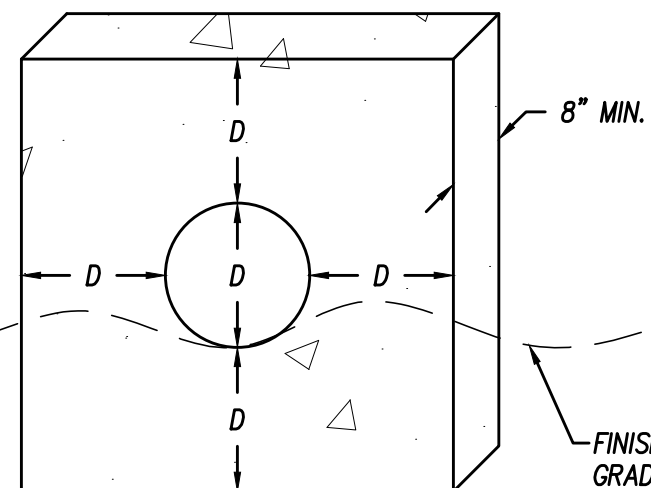

TYPICAL DETAIL-MODIFIED HEADWALL

NOT TO SCALE

GRADING PLAN CERTIFICATION:

I, CERTIFY THAT THE GRADING AS SHOWN ON THIS MINOR GRADING PLAN SATISFIES THE REQUIREMENTS OF THE COUNTY OF SAN DIEGO GRADING ORDINANCE.

BY: _____ DATE: _____

RCE NO.: C80667

THE COUNTY IS NOT RESPONSIBLE FOR THE DESIGN IN ANYWAY.

BY: _____ DATE: _____
FOR: VINCE NICOLETTI, DIRECTOR, DEPARTMENT OF PLANNING & DEVELOPMENT SERVICES

COUNTY APPROVED CHANGES

DESCRIPTION:	APPROVED BY:	DATE:

PRIVATE CONTRACT

SHEET 4	COUNTY OF SAN DIEGO DEPARTMENT OF PUBLIC WORKS	07 SHEETS
GRADING PLAN FOR:		
2255 EUCLID AVE		
CALIFORNIA COORDINATE INDEX 226-1797		
APPROVED FOR SAMIR NUNALLY, COUNTY ENGINEER		
SEE CERTIFICATION		
ENGINEER OF WORK: _____ R.C.E.: C80667		
GRADING PERMIT NO: PDS2024-LDGRMN-20405		



VAN RYN
CIVIL ENGINEERING & LAND SURVEYING
San Diego | Manteca | 858.521.8100
vanryngineering.com

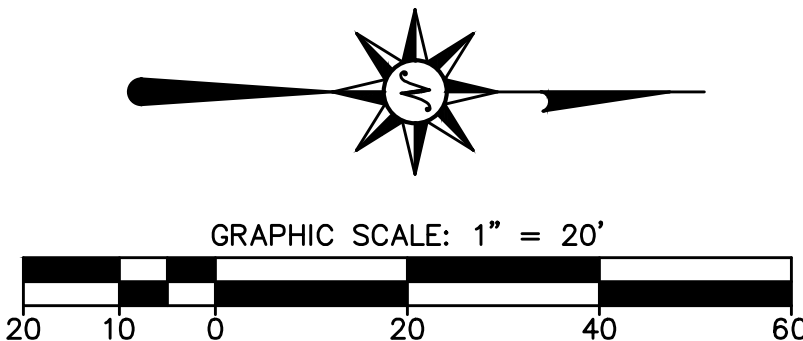

EROSION CONTROL NOTES

- ALL BUILDING PADS TO BE DIKED AND THE DIKES MAINTAINED TO PREVENT WATER FROM FLOWING FROM THE PAD UNTIL THE STREETS AND DRIVEWAYS ARE PAVED AND WATER CAN FLOW FROM THE PADS WITHOUT CAUSING EROSION, OR CONSTRUCT DRAINAGE FACILITIES TO THE SATISFACTION OF THE COUNTY DEPARTMENT OF PUBLIC WORKS THAT WILL ALLOW WATER TO DRAIN FROM THE PAD WITHOUT CAUSING EROSION.
- TOPS OF ALL SLOPES TO BE DIKED OR TRENCHED TO PREVENT WATER FROM FLOWING OVER THE CREST OF SLOPES.
- MANUFACTURED SLOPES AND PADS SHALL BE ROUNDED VERTICALLY AND HORIZONTALLY AS APPROPRIATE TO BLEND WITH THE SURROUNDING TOPOGRAPHY.
- AS SOON AS CUTS OR EMBANKMENTS ARE COMPLETED, BUT NOT LATER THAN OCTOBER 1, ALL CUT AND FILL SLOPES SHALL BE STABILIZED WITH A HYDROMULCH MIXTURE OR AN EQUAL TREATMENT APPROVED BY THE COUNTY DEPARTMENT OF PUBLIC WORKS BETWEEN OCTOBER 1 AND APRIL 15. APPROVED SLOPE PROTECTION MEASURES SHALL PROCEED IMMEDIATELY BEHIND THE EXPOSURE OF CUT SLOPES AND/OR THE CREATION OF EMBANKMENT SLOPES.
- CATCH BASINS, DESILTING BASINS AND STORM DRAIN SYSTEMS SHALL BE INSTALLED TO THE SATISFACTION OF THE COUNTY DEPARTMENT OF PUBLIC WORKS.
- SAND BAG CHECK DAMS TO BE PLACED IN A MANNER APPROVED BY THE COUNTY DEPARTMENT OF PUBLIC WORKS IN UNPAVED STREETS WITH GRADIENTS IN EXCESS OF 2% AND ON OR IN OTHER GRADED OR EXCAVATED AREAS AS REQUIRED BY THE COUNTY DEPARTMENT OF PUBLIC WORKS.
- THE DEVELOPER TO MAINTAIN THE PLANTING AND EROSION CONTROL MEASURES DESCRIBED ABOVE UNTIL RELIEVED OF THE SAME BY THE COUNTY DEPARTMENT OF PUBLIC WORKS. THE DEVELOPER TO REMOVE ALL SOIL INTERCEPTED BY THE SAND BAGS, CATCH BASINS AND DESILTING BASINS AND KEEP THESE FACILITIES CLEAN AND FREE OF SILT AND SAND AS DIRECTED BY THE COUNTY DEPARTMENT OF PUBLIC WORKS. THE DEVELOPER SHALL REPAIR ANY ERODED SLOPES AS DIRECTED BY THE COUNTY DEPARTMENT OF PUBLIC WORKS.

PLANTING & IRRIGATION NOTES

ALL PERMANENT AND TEMPORARY EROSION CONTROL PLANTING AND IRRIGATION SHALL BE INSTALLED AND MAINTAINED AS REQUIRED BY SECTIONS 87.417 AND 87.418 OF THE COUNTY'S GRADING ORDINANCE AND SHALL BE COMPLIANT WITH THE COUNTY'S WATER CONSERVATION IN LANDSCAPE ORDINANCE, THE WATER EFFICIENT LANDSCAPE DESIGN MANUAL, AND THE BMP DESIGN MANUAL:

- A. SLOPE EROSION CONTROL:
- AT A MINIMUM, ALL MANUFACTURED SLOPE AREAS SHALL BE COVERED WITHIN 10 DAYS OF COMPLETION OF GRADING WITH HYDROSEED/MULCH, PUNCHED STRAW MULCH, JUTE NETTING OR OTHER APPROVED GEOTEXTILE MATERIAL CAPABLE OF CONTROLLING SURFACE SOIL EROSION;
 - EXCEPT WHERE APPROVED OTHERWISE, ALL SLOPES AND ANY OTHER AREAS DISTURBED IN CONJUNCTION WITH GRADING ACTIVITIES SHALL BE MAINTAINED UNTIL VEGETATION IS WELL ESTABLISHED, WITH COVERAGE EQUAL TO AT LEAST 70 PERCENT OF COVERAGE AS COMPARED TO THE NATIVE BACKGROUND PLANTS IS ACHIEVED. THIS THRESHOLD MUST BE MET BEFORE OCCUPANCY OF THE SITE WILL BE PERMITTED;
 - A MINIMUM OF 50 PERCENT OF THE TOTAL SLOPE AREAS OF MANUFACTURED SLOPES SHALL BE PLANTED WITH DEEP ROOTING PLANTINGS (I.E., THOSE WITH A TYPICAL ROOT DEPTH OF APPROXIMATELY 5 FEET OR GREATER). FOR SEEDED PLANTINGS, AT LEAST 50 PERCENT OF THE VIABLE SEED COUNT SHALL BE DEEP ROOTING SPECIES;
 - ALL PLANT MATERIALS ON MANUFACTURED SLOPES SHALL BE APPROPRIATE TO THE SITE CONDITIONS, SHALL BE WATER EFFICIENT WHEN ESTABLISHED AND SHALL BE ADEQUATELY SPACED TO CONTROL SOIL EROSION;
 - ALL SLOPES IN EXCESS OF 15 FEET SHALL BE PLANTED WITH ROOTED CONTAINER STOCK AT AN AVERAGE RATE OF ONE PER 100 SQUARE FEET UNLESS APPROVED OTHERWISE. CONTAINERS SHALL BE A MINIMUM OF ONE GALLON FOR SHRUBS AND FIVE GALLON FOR TREES. ALL CONTAINER STOCK SHALL BE PROVIDED WITH A TEMPORARY IRRIGATION SYSTEM;
 - SLOPES GREATER THAN 25 PERCENT SHALL NOT BE IRRIGATED WITH AN IRRIGATION SYSTEM WITH A PRECIPITATION RATE EXCEEDING 0.75 INCHES PER HOUR.
- B. IRRIGATION
- ALL IRRIGATION SYSTEMS SHALL BE INSTALLED TO AVOID RUNOFF, SEEPAGE, LOW HEAD DRAINAGE, OVER-SPRAY OR OTHER SIMILAR CONDITIONS ONTO ADJACENT PROPERTY, NON-IRRIGATED AREAS,WALKS, ROADWAYS OR STRUCTURES;
 - APPROVED BACKFLOW PREVENTION UNITS ARE REQUIRED ON ALL POTABLE WATER IRRIGATION SYSTEMS;
 - AFTER PLANT ESTABLISHMENT, THE IRRIGATION SYSTEM IS TO PROVIDE SUFFICIENT WATER TO SUSTAIN PLANTS IN A HEALTHY, GROWING CONDITION;
 - LANDSCAPE WATER METERS, SHALL BE INSTALLED FOR ALL NON-RESIDENTIAL IRRIGATED LANDSCAPES OF 1,000 SQ. FT. OR MORE, AND FOR ALL RESIDENTIAL IRRIGATED LANDSCAPES OF 5,000 SQ. FT. OR GREATER. A LANDSCAPE WATER METER SHALL BE EITHER A CUSTOMER SERVICE METER DEDICATED TO LANDSCAPE USE PROVIDED BY THE LOCAL WATER PURVEYOR; OR A PRIVATELY OWNED METER OR SUB-METER;
 - FLOW SENSORS THAT DETECT AND REPORT HIGH FLOW CONDITIONS CREATED BY SYSTEM DAMAGE OR MALFUNCTION ARE REQUIRED FOR ALL NON-RESIDENTIAL LANDSCAPES, AND RESIDENTIAL LANDSCAPES OF 5,000 SQ. FT. OR LARGER;
 - MASTER SHUT-OFF VALVES ARE REQUIRED;
 - AUTOMATIC CONTROL SYSTEMS ARE REQUIRED, AND MUST BE ABLE TO ACCOMMODATE ALL ASPECTS OF THE INSTALLED EROSION CONTROL LANDSCAPE, INCLUDING MULTIPLE SCHEDULES, REPEAT CYCLES, EVAPOTRANSPIRATION OR SOIL MOISTURE SENSING, AND RAIN SENSING OVERRIDE DEVICES. CONTROL MECHANISMS FOR AN EVAPOTRANSPIRATION (WEATHER BASED) SYSTEM OR SOIL MOISTURE DETECTING SYSTEMS, UTILIZING NON-VOLATILE MEMORY SHALL BE ACCOMMODATED WITHIN THE CONTROLLER ENCLOSURE. BATTERY OPERATED VALVES OR SOLAR POWERED CONTROLLERS MAY BE USED IN AREAS WHERE ELECTRICITY IS NOT YET AVAILABLE, HOWEVER, WHEN AVAILABLE, SYSTEMS SHALL BE CONVERTED;

- ALL IRRIGATION SYSTEMS SHALL BE ADJUSTED SEASONALLY AND AS WEATHER AND PLANT CONDITIONS WARRANT;
- SHUTOFF VALVES SHALL BE PROVIDED AT POINTS OF CONNECTION TO DIVIDE THE IRRIGATION SYSTEM INTO CONTROLLABLE UNITS. CHECK VALVES OR ANTI-DRAIN VALVES ARE REQUIRED FOR ALL IRRIGATION SYSTEMS;
- ALL PIPE AND WIRE UNDER VEHICULAR PAVING SHALL BE INSTALLED IN PVC SCHEDULE 40 SLEEVES. SLEEVES SHALL BE AT LEAST TWICE THE DIAMETER OF THE PIPE OR WIRE BUNDLES TO BE ENCLOSED;
- PERMANENT ON-GRADE SYSTEMS MAY ONLY BE ALLOWED FOR AREAS WITH HIGHLY EROSION OR ROCKY SOILS AND SHALL NOT BE ALLOWED ADJACENT TO PEDESTRIAN TRAFFIC;
- ALL ON-GRADE LINES SHALL BE SECURED TO SLOPES EVERY TEN FEET OR LESS. THE ENDS OF ALL LATERALS SHALL ALSO BE STAKED;
- ON-GRADE LATERAL PIPING IS ALLOWED FOR TEMPORARY SYSTEMS;
- ALL REQUIRED LANDSCAPING SHALL BE PLANTED AND IRRIGATION SYSTEMS INSTALLED PRIOR TO THE ROUGH GRADING INSPECTION. THE COUNTY OFFICIAL SHALL DETERMINE AT FINAL GRADING INSPECTION THAT PLANTING IS ESTABLISHED AND THAT ALL IRRIGATION SYSTEMS ARE OPERATIONAL;
- SLOPE HYDROSEEDING MIX SHALL CONSIST OF THE FOLLOWING:

- NON-IRRIGATED SEED MIX SHALL NOT BE ALLOWED AND NO INVASIVE, FIRE PRONE SPECIES SHALL BE INCLUDED;
- SEED MIX SHALL CONSIST OF NO LESS THAN:
 - ALL SEED MATERIALS SHALL BE TRANSPORTED TO THE JOBSITE IN UNOPENED CONTAINERS WITH THE CALIFORNIA DEPARTMENT OF FOOD AND AGRICULTURE CERTIFICATION TAG ATTACHED TO, OR PRINTED ON SAID CONTAINERS.
 - NON-PHYTO-TOXIC WETTING AGENTS MAY BE ADDED TO THE HYDROSEED SLURRY AT THE DISCRETION OF THE CONTRACTOR.
- TYPE 1 MULCH APPLIED AT THE RATE OF NO LESS THAN 2000 LBS. PER ACRE. TYPE 6 MULCH (STRAW) MAY BE SUBSTITUTED, ALL OR PART, FOR HYDRAULICALLY APPLIED FIBER MATERIAL. WHEN STRAW IS USED IT MUST BE ANCHORED TO THE SLOPE BY MECHANICALLY PUNCHING NO LESS THAN 50% OF THE STRAW INTO THE SOIL.
- FERTILIZER CONSISTING OF AMMONIUM PHOSPHATE, SULFATE, 16-20-0, WITH 15% SULPHUR APPLIED AT THE RATE OF 500 LBS. PER ACRE.
- AREAS TO BE HYDROSEEDED SHALL BE PREPARED PRIOR TO HYDROSEEDING BY:
 - ROUGHENING THE SURFACE TO BE PLANTED BY ANY OR COMBINATION OF:
 - TRACK WALKING SLOPES STEEPER THAN 6:1
 - HARROWING AREAS 6:1 OR FLATTER THAT ARE SUFFICIENTLY FRIABLE
 - RIPPING AREAS THAT WILL NOT BREAK UP USING ITEMS a.a. OR a.b. ABOVE.
- CONDITION THE SOILS SO THAT IT IS SUITABLE FOR PLANTING BY:
 - ADJUSTING THE SURFACE SOIL MOISTURE TO PROVIDE A DAMP BUT NOT SATURATED SEED BED.
 - THE ADDITION OF SOIL AMENDMENTS, PH ADJUSTMENT, LEACHING OR COVERING SALINE SOILS TO PROVIDED VIABLE CONDITIONS FOR GROWTH.
- HYDROSEEDED AREAS SHALL BE MAINTAINED TO PROVIDE A VIGOROUS GROWTH UNTIL THE PROJECT IS PERMANENTLY LANDSCAPED OR, FOR AREAS WHERE HYDROSEEDING IS THE PERMANENT LANDSCAPING, UNTIL THE PROJECT IS COMPLETED AND ALL GRADING BONDS RELEASED.

HYDROSEED NOTES:

- PRIOR TO THE ACCEPTANCE OF THE HYDROSEEDED AREAS BY THE COUNTY , A CERTIFICATION REPORT MUST BE SUBMITTED BY A REGISTERED LANDSCAPE ARCHITECT, STATING THAT THE HYDROSEEDING WAS DONE ACCORDING TO THE PROJECT SPECIFICATIONS AND THAT THE GROWTH IS ADEQUATELY ESTABLISHED TO PREVENT EROSION.
- ALL DISTURBED SLOPES TO BE HYDROSEEDED UNLESS OTHERWISE NOTED.

PLANT LEGEND:

- ** PROVIDE A PLANT LEGEND WITH BOTH BOTANICAL AND COMMON NAMES LISTED ALONG WITH SYMBOLS FOR IDENTIFICATION AND LOCATION. PROVIDE CONTAINER SIZES, QUANTITIES OF EACH SPECIES, AND ON CENTER SPACE REQUIREMENTS. NO INVASIVE OR FIRE PRONE SPECIES SHALL BE INTRODUCED TO THE SITE.
- ** PROVIDE A PLANT LEGEND OF ALL PROPOSED HYDROSEED SPECIES WITH BOTH BOTANICAL AND COMMON NAMES LISTED. INCLUDE POUNDS PER ACRE FOR EACH SEED SPECIES. NO INVASIVE OR FIRE PRONE SPECIES SHALL BE INTRODUCED TO SITE.

NOTE:

VEGETATION STABILIZATION (PLANTING OR HYDROSEEDING) MAY BE INSTALLED BETWEEN MAY 1ST AND AUGUST 15TH. SLOPE IRRIGATION MUST BE IN PLACE AND TO BE OPERABLE FOR SLOPES >3'. VEGETATION MUST BE WATERED AND ESTABLISHED PRIOR TO OCTOBER 1ST. THE OWNER SHALL SUPPLEMENT VEGETATION WITH BARK OR MULCH BY OCTOBER 1ST IF VEGETATION ESTABLISHMENT DOES NOT OCCUR BY THAT DATE. EROSION CONTROL MEASURES MUST ALSO BE USED WHILE LANDSCAPING IS BEING ESTABLISHED. ESTABLISHED VEGETATION SHALL HAVE A SUBSURFACE MAT OF INTERTWINED MATURE ROOTS WITH A UNIFORM VEGETATION COVERAGE OF 70% OF THE NATURAL VEGETATIVE COVERAGE OR MORE ON ALL DISTURBED AREAS.

ALL SLOPES OVER THREE FEET MUST HAVE ESTABLISHED VEGETATIVE COVER PRIOR TO FINAL PERMIT APPROVAL

TYPICAL BMP DETAILS

- SET POSTS AND EXCAVATE A 4 BY 4 IN (10 BY 10 CM) TRENCH UPSLOPE FROM AND ALONG THE LINE OF POSTS.
- STAPLE WIRE FENCING TO THE POSTS.
- ATTACH THE FILTER FABRIC TO THE WIRE FENCE AND EXTEND IT INTO THE TRENCH.
- BACKFILL AND COMPACT THE EXCAVATED SOIL.

SILT FENCE

NO SCALE

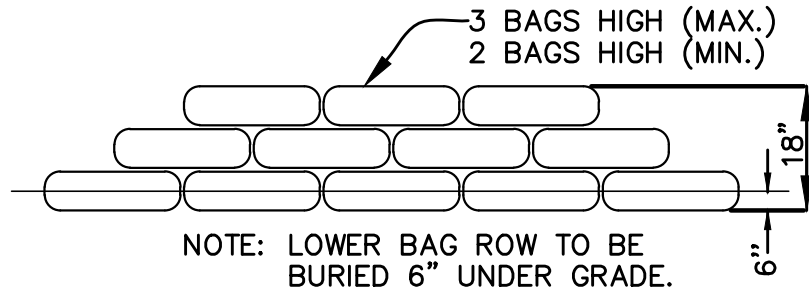

GRAVEL BAG CHECK DAM

NO SCALE

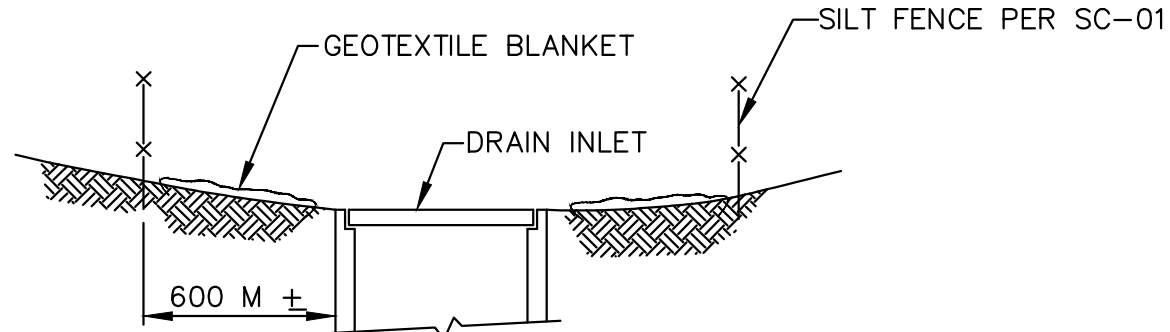

SECTION A-A

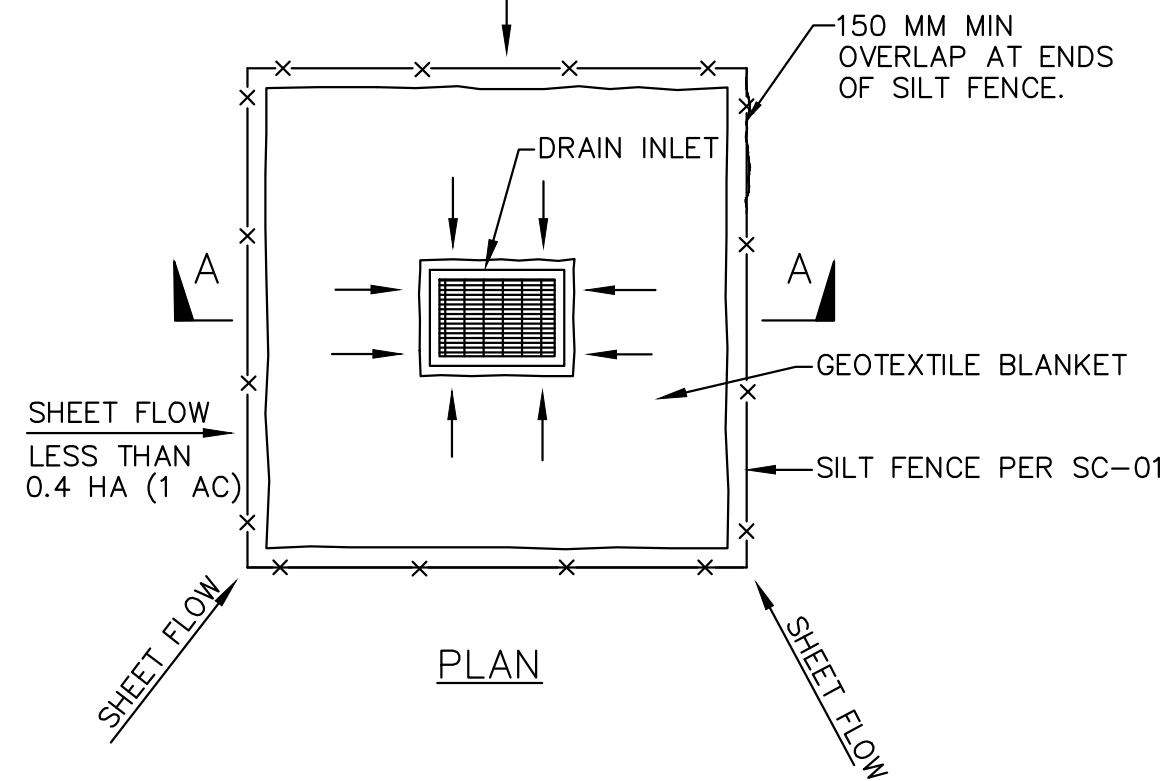

PLAN

NOTES:

- FOR USE IN AREAS WHERE GRADING HAS BEEN COMPLETED AND FINAL SOIL STABILIZATION AND SEEDING ARE PENDING.
- NOT APPLICABLE IN PAVED AREAS.
- NOT APPLICABLE WITH CONCENTRATED FLOWS.

DRAIN INLET PROTECTION TYPE 1

NO SCALE

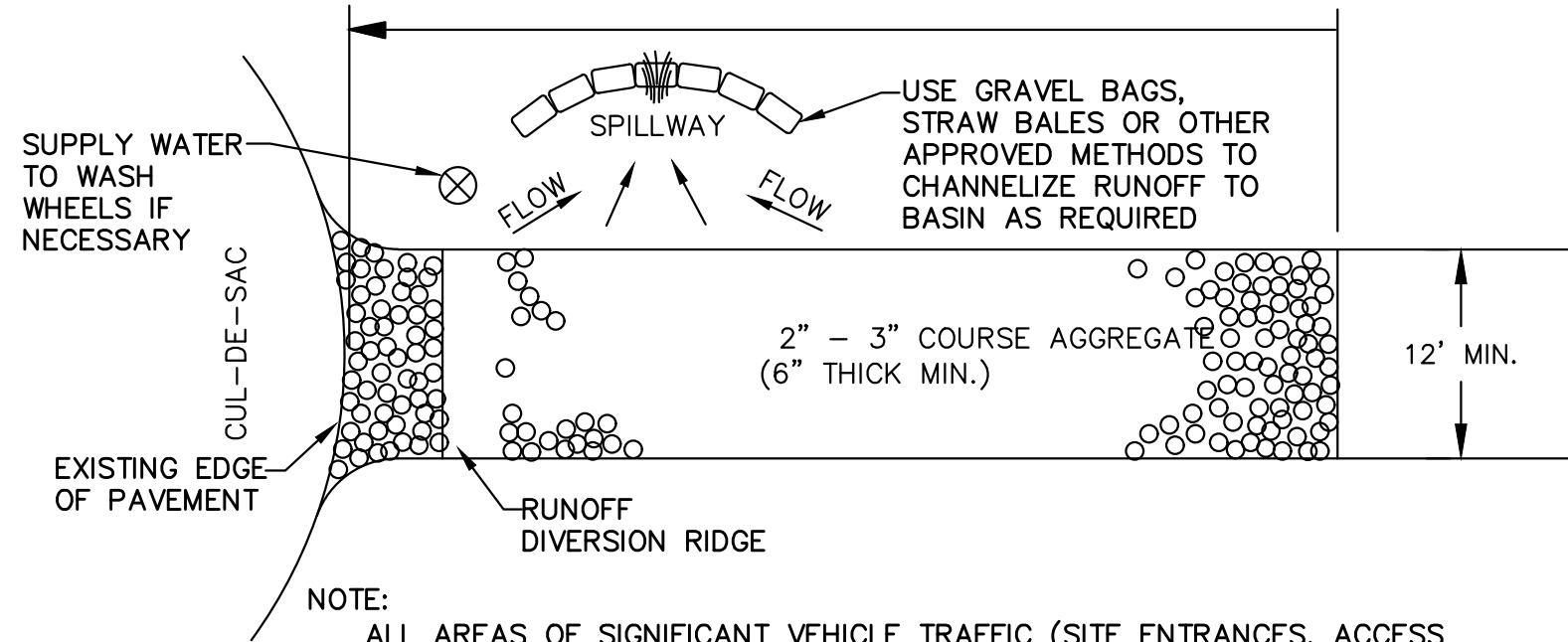

STABILIZED CONSTRUCTION ENTRANCE

NO SCALE

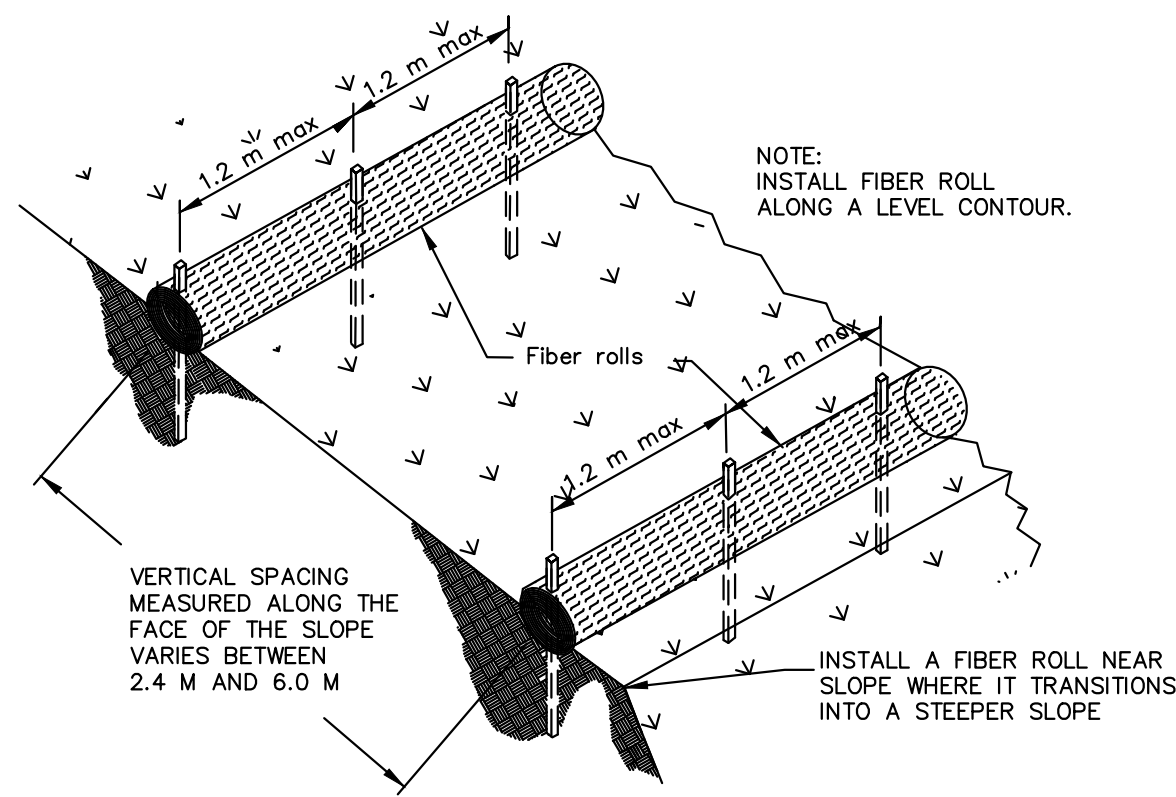

TYPICAL FIBER ROLL INSTALLATION

NO SCALE

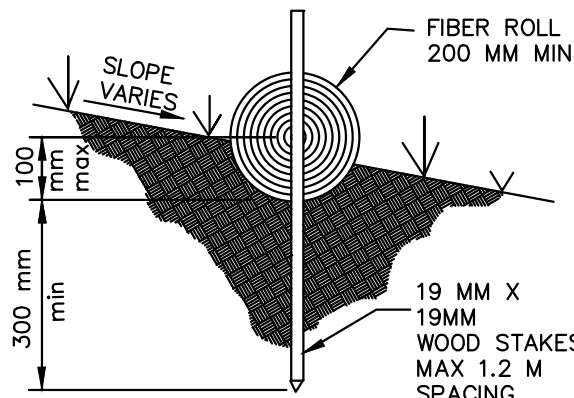

ENTRENCHMENT DETAIL

NO SCALE

GRADING PLAN CERTIFICATION:

I, CERTIFY THAT THE GRADING AS SHOWN ON THIS MINOR GRADING PLAN SATISFIES THE REQUIREMENTS OF THE COUNTY OF SAN DIEGO GRADING ORDINANCE.

BY: _____ DATE: _____

RCE NO.: C80667

THE COUNTY IS NOT RESPONSIBLE FOR THE DESIGN IN ANYWAY.

BY: _____ DATE: _____
FOR: VINCE NICOLETTI, DIRECTOR, DEPARTMENT OF PLANNING & DEVELOPMENT SERVICES



COUNTY APPROVED CHANGES			PRIVATE CONTRACT		
DESCRIPTION:	APPROVED BY:	DATE:	SHEET 5	COUNTY OF SAN DIEGO DEPARTMENT OF PUBLIC WORKS	07 SHEETS
EROSION CONTROL NOTES AND DETAILS FOR:					
2255 EUCLID AVE					
CALIFORNIA COORDINATE INDEX 226-1797					
APPROVED FOR SAMIR MUHALY, COUNTY ENGINEER			ENGINEER OF WORK:		
SEE CERTIFICATION			R.C.E.: C80667		
GRADING PERMIT NO: PDS2024-LDGRMN-20405					

CONSTRUCTION STORMWATER BMP LEGEND:

ITEMS FACT SHEET/DETAILS SYMBOL

MATERIAL DELIVERY & STORAGE	WM-1	
SPILL PREVENTION AND CONTROL	WM-4	
CONCRETE WASTE MANAGEMENT	WM-8	
SOLID WASTE MANAGEMENT	WM-5	
SANITARY WASTE MANAGEMENT	WM-9	
HAZARDOUS WASTE MANAGEMENT	WM-6	

PRESERVATION OF EXISTING VEGETATION	SS-2	
BONDED OR STABILIZED FIBER MATRIX (WINTER)	SS-3	
HYDROSEEDING (SUMMER)	SS-4	
STRAW OR WOOD MULCH	SS-6, SS-8	
PHYSICAL STABILIZATION (WINTER)	SS-7	
ENERGY DISSIPATOR	SS-10	
SILT FENCE	SC-1, DETAIL SHEET 4	
SEDIMENT / DESILTING BASIN	SC-2	
FIBER ROLLS	SC-5, DETAIL SHEET 4	
GRAVEL OR SAND BAGS	SC-6, SC-8, DETAIL SHEET 4	
STREET SWEEPING AND VACUUMING	SC-7	
STORM DRAIN INLET PROTECTION	SC-10, DETAIL SHEET 4	
DEWATERING FILTRATION	NS-2	
STABILIZED CONSTRUCTION ENTRANCE	TC-1, DETAIL SHEET 4	
CONSTRUCTION ROAD STABILIZATION	TC-2	
ENTRANCE / EXIT TIRE WASH	TC-3	

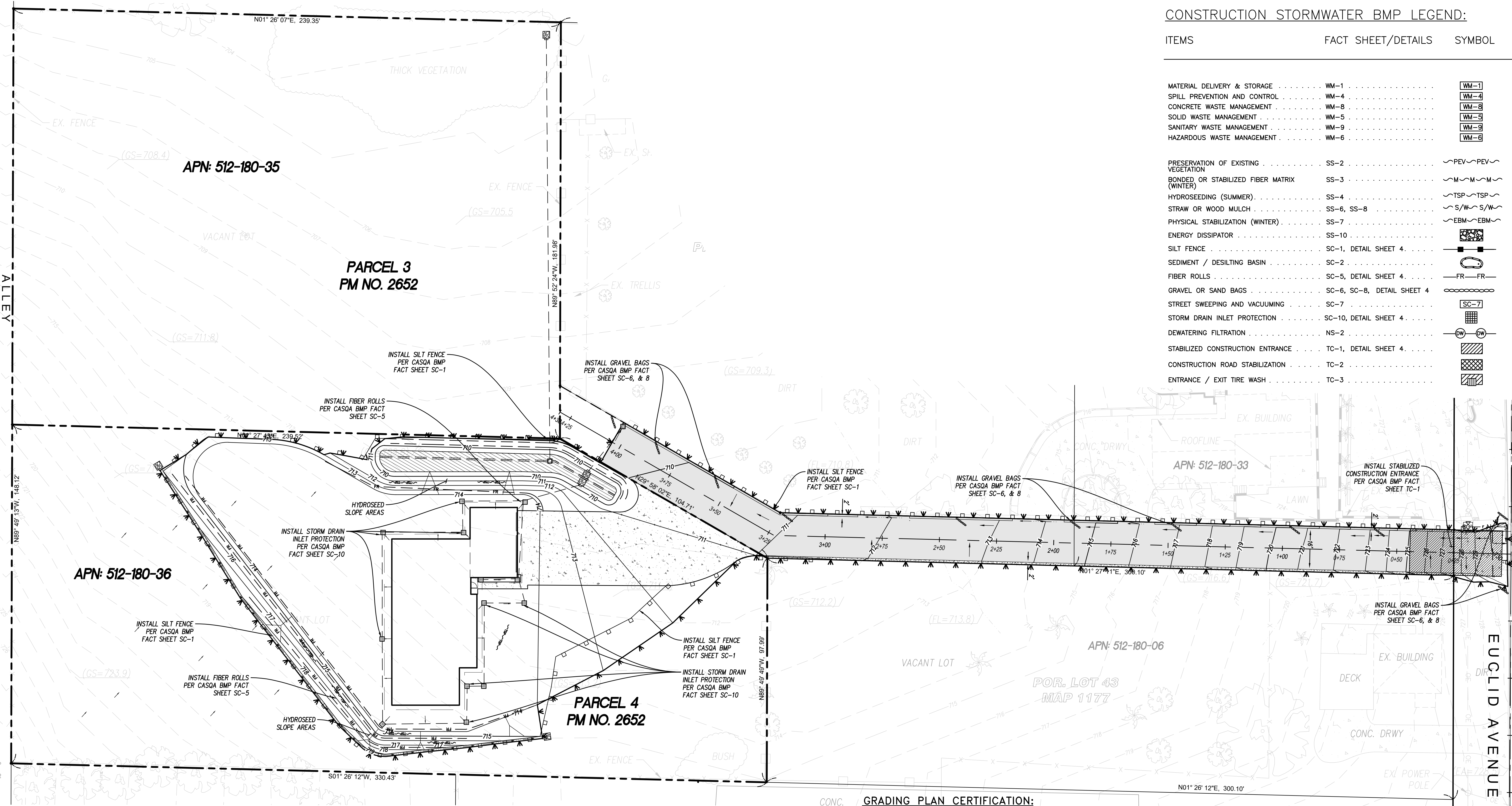

GRADING PLAN CERTIFICATION:

I, CERTIFY THAT THE GRADING AS SHOWN ON THIS MINOR GRADING PLAN SATISFIES THE REQUIREMENTS OF THE COUNTY OF SAN DIEGO GRADING ORDINANCE.

BY: _____ DATE: _____

RCE NO.: C80667

THE COUNTY IS NOT RESPONSIBLE FOR THE DESIGN IN ANYWAY.

BY: _____ DATE: _____
FOR: VINCE NICOLETTI, DIRECTOR, DEPARTMENT OF PLANNING & DEVELOPMENT SERVICES

COUNTY APPROVED CHANGES

DESCRIPTION:	APPROVED BY:	DATE:

PRIVATE CONTRACT

SHEET 6	COUNTY OF SAN DIEGO DEPARTMENT OF PUBLIC WORKS	07 SHEETS
EROSION CONTROL AND STORM WATER QUALITY BMP PLAN FOR: 2255 EUCLID AVE		
CALIFORNIA COORDINATE INDEX 226-1797		
APPROVED FOR SAMIR NUNALLY, COUNTY ENGINEER	ENGINEER OF WORK: R.C.E.: C80667	
SEE CERTIFICATION		
GRADING PERMIT NO: PDS2024-LDGRMN-20405		

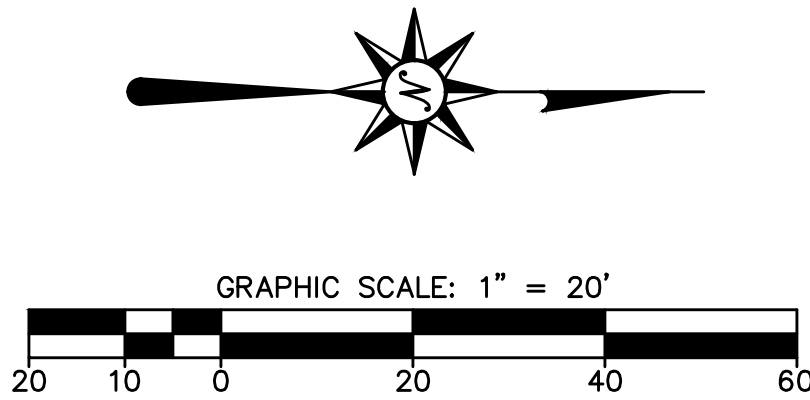

SWQMP DMA &
HYDROMODIFICATION MAP

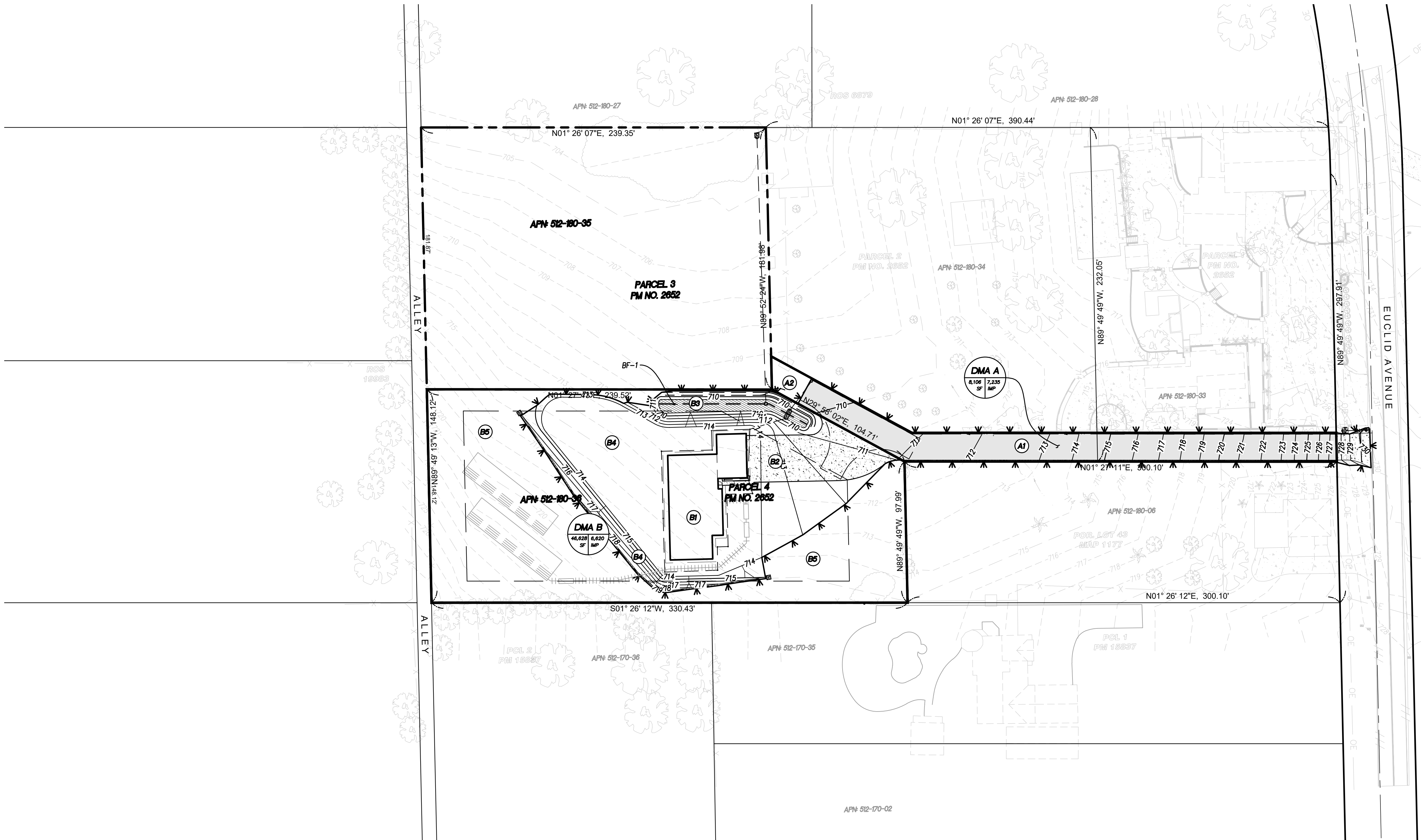

AREA CALCULATIONS

IMPERVIOUS AREA	(RESIDENCE)	= 3,139
	(CONCRETE DRIVEWAY)	= 3,120
	(AC DRIVEWAY)	= 7,235
TOTAL IMPERVIOUS		= 13,494
PERVIOUS AREA	(LANDSCAPE AREA)	= 15,984
	(EX. LANDSCAPE)	= 24,406
	(BMP BASIN)	= 850
TOTAL PERVIOUS		= 41,240

SOIL TYPE INFORMATION
HYDROLOGIC SOIL TYPE: D

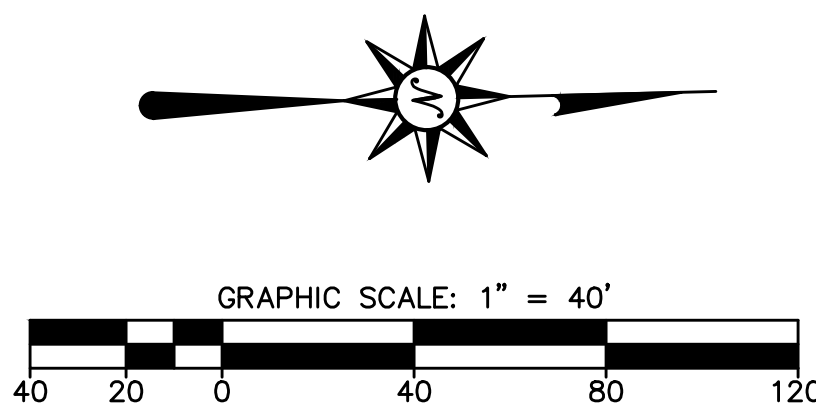

LEGEND

DESCRIPTION	SYMBOL
DMA BOUNDARY	
BASIN SUMMARY Q ₁₀₀	

DMA-A BMP SIZE & HYDROMOD ORIFICE DIAMETER SUMMARY

AREA NAME	AREA (SF)	POST-PROJECT SURFACE TYPE	SURFACE RUNOFF FACTOR	ADJUSTMENT FACTOR	AREA X ADJUSTED RUNOFF (SF)
A1	7,235	AC DRIVEWAY	0.9	0.77	5,014
A2	871	EXISTING GRADE	0.3	1.0	261
TOTAL					5,275

DMA-B BMP SIZE & HYDROMOD ORIFICE DIAMETER SUMMARY

AREA NAME	AREA (SF)	POST-PROJECT SURFACE TYPE	SURFACE RUNOFF FACTOR	ADJUSTMENT FACTOR	AREA X ADJUSTED RUNOFF (SF)
B1	3,139	PROPOSED BUILDING	0.9	0.77	2,175
B2	3,120	CONCRETE DRIVEWAY	0.9	0.77	2,162
B3	850	BMP BASIN	0.3	1.0	255
B4	15,984	LANDSCAPE/GRADING AREA	0.3	1.0	4,795
B5	23,535	EX. LANDSCAPE TO REMAIN	0.3	1.0	7,061
TOTAL					16,448

GRADING PLAN CERTIFICATION:

I, CERTIFY THAT THE GRADING AS SHOWN ON THIS MINOR GRADING PLAN SATISFIES THE REQUIREMENTS OF THE COUNTY OF SAN DIEGO GRADING ORDINANCE.

BY: _____ DATE: _____

RCE NO.: C80667

THE COUNTY IS NOT RESPONSIBLE FOR THE DESIGN IN ANYWAY.

BY: _____ DATE: _____
FOR: VINCE NICOLETTI, DIRECTOR, DEPARTMENT OF PLANNING & DEVELOPMENT SERVICES

GROUNDWATER TABLE

NO INDICATION OF NEAR-SURFACE GROUNDWATER PER SOILS REPORT

DMA-A DCV CALCULATIONS

TOTAL DMA SIZE	= 8,106 SF
ADJUSTED RUNOFF FACTOR	= 0.84
85TH % RAINFALL DEPTH	= 0.64 INCHES
DCV	= 363 CU FT

DMA-B DCV CALCULATIONS

TOTAL DMA SIZE	= 46,628 SF
ADJUSTED RUNOFF FACTOR	= 0.42
85TH % RAINFALL DEPTH	= 0.64 INCHES
DCV	= 1,044 CU FT



COUNTY APPROVED CHANGES

DESCRIPTION:	APPROVED BY:	DATE:

PRIVATE CONTRACT

SHEET 7	COUNTY OF SAN DIEGO DEPARTMENT OF PUBLIC WORKS	07 SHEETS
DMA FOR: 2255 EUCLID AVE		
CALIFORNIA COORDINATE INDEX 226-1797		
APPROVED FOR SAMIR MUHALY, COUNTY ENGINEER	ENGINEER OF WORK:	R.C.E.: C80667
SEE CERTIFICATION	GRADING PERMIT NO.: PDS2024-LDGRMN-20405	