

PLAT OF SURVEY

-OF-

LOTS 5 AND 6 IN BLOCK 2 OF GREEN LAKE PARK, LOCATED IN GOVERNMENT LOT 5, SECTION 26, TOWN 4 NORTH, RANGE 16 EAST, TOWN OF LaGRANGE, WALWORTH COUNTY, WISCONSIN.

AND ALL THAT PART OF THE VACATED ALLEY BETWEEN BLOCK 2 AND BLOCK 1 OF SAID SUBDIVISION LYING SOUTH OF THE EASTERLY EXTENSION OF THE NORTHERLY LOT LINE OF SAID LOT 5, BLOCK 2, GREEN LAKE PARK, TOWN OF LaGRANGE, WALWORTH COUNTY, WISCONSIN AND AS SET FORTH IN VACATION OF ALLEY DATED OCTOBER 1st, 1894 AND RECORDED IN THE OFFICE OF THE REGISTER OF DEEDS FOR WALWORTH COUNTY, WISCONSIN ON OCTOBER 2nd, 1894 IN VOLUME 68 OF MORTGAGES IN PAGE 464, AS DOCUMENT No. 126386.

EXCEPTING THEREFROM THE SOUTH 10 FEET OF LOT 6, BLOCK 2, GREEN LAKE PARK AS MORE FULLY SET FORTH IN WARRANTY DEED FROM GEORGE B. AVERILL AND LYDIA AVERILL, HIS WIFE, FLORENCE M. AVERILL AND MAUD A. LIEBENBERG TO ROBERT C. BULKLEY AND ROSE D. BULKLEY, HIS WIFE, DATED APRIL 21st, 1917 AND RECORDED IN THE OFFICE OF THE REGISTER OF DEEDS FOR WALWORTH COUNTY, WISCONSIN ON MAY 7th, 1917 IN VOLUME 149 OF DEEDS IN PAGE 419, AS DOCUMENT No. 213014.



LEGEND

- FOUND IRON PIPE
- FOUND IRON BAR
- △ FOUND P.K. NAIL
- ⊠ FOUND RAILROAD SPIKE
- ⊙ VENT
- ⊕ CONCRETE LID
- ⊖ PLASTIC LID
- WELL
- DECIDUOUS
- ⊙ ELECTRIC METER
- ⊙ GAS METER
- BURIED ELECTRIC
- BURIED TELEPHONE
- GAS LINE
- LIGHT POLE

I have surveyed the above-described property and the above map is a true representation thereof and shows the size and location of the property, its exterior boundaries, the location and dimensions of all structures thereon, fences apparent easements and roadways and visible encroachments, if any.

This survey is made for the exclusive use of the present owners of the property, and also those who purchase, mortgage, or insure the title thereto within one (1) year from date hereof, and as to them I warrant the accuracy of said survey map.

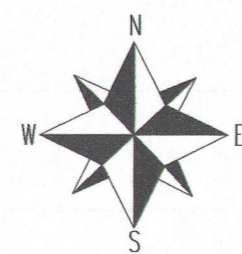

SCALE 1"=20'

NOTE: BEARINGS ARE REFERENCED TO PREVIOUS SURVEY RECORDS
NOTE: VERTICAL DATUM BASED ON N.G.V.D. 1929

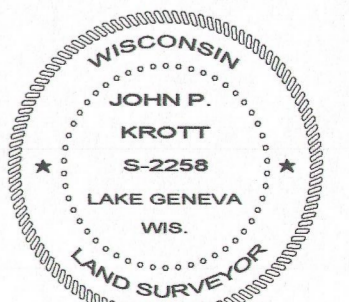
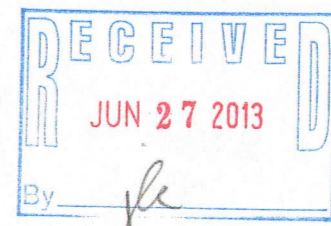

DATED THIS 1st DAY OF APRIL 2013

JOHN KROTT S-2258
Wisconsin Registered Land Surveyor
(original if signed in red)