



Lancaster County Health Department
 P.O. Box 158
 Lancaster, Virginia 22503
 (804) 462-9919 Voice
 (804) 462-6211 Fax

Septic Tank - Soil Absorption System Construction Permit

Health Department ID Number: **151-12-0190**

Owner / Agent Information			
Owner: Albert Pollard	Phone: ()		
Location Information			
Property Address: 40 Steamboat Road			
Locality: Lancaster County			
Tax Map Number: 33-335B			
Directions:			
General Information			
Approval Type: Single Lot Certification Letter	Daily Flow: 450 gallons		
Type of Property: Residential	Number of Bedrooms: 3		
Sewer Line			
Material 4" SCH 40 PVC or equivalent (cleanouts required at 50' to 60' intervals)	Distribution Box Information		
	No. of Boxes: 1		
	No. of Outlets: 8		
Conveyance Line / Force Main Information			
Method: Gravity	Material: Minimum crush	Header Line Information	
strength 1500#		Material: ASTM F405 pipe or better (1500 # crush or equivalent)	
Pipe Diameter: "		Minimum Slope: 2" per 100'	
Minimum Slope: 6" per 100' for non-pump			
Septic Tank - Inlet Outlet Structure		Percolation Lines and Absorption Area	
Capacity: 1000 gal	Slope: 2-4" per 100'		
The inlet structure shall be 1-2 inches higher than the outlet structure and shall extend 6-8 inches below and 8-10 inches above the normal liquid level. The outlet structure shall extend 35-40% below the normal liquid level and 8-10 inches above the normal liquid level. To comply with the maintenance requirements of 12 VAC 5-610-817 the septic tank must be provided with one of the following three options: 1) Inspection port, 2) Effluent filter, 3) Reduced maintenance tank	Percolation Lines: 4" diameter		
	Center to Center Spacing: 9'		
	Installation Depth: 24 "		
	Depth of Aggregate: 13" Size of Aggregate: 0.5-1.5"		
	Total Number of Laterals: 6		
	Laterals to be 55' long, 3' wide		
	Install 990 sq feet square feet total		
	100% Reserve area provided for future repair		

Please Note:

INSTALL SIX (6) LINES , 55 FEET LONG X 3 FEET WIDE, ON 9 FOOT CENTERS, ON CONTOUR, 24 INCHES DEEP,. TO YIELD 990 SQ. FT.

GRAVELLESS PRODUCTS MAY BE USED, BUT FOOTPRINT REDUCTION IS NOT RECOMMENDED.

A 15 FOOT UTILITY EASEMENT EXISTS AROUND THE PROPERTY PERIMETER. DO NOT DIG IN THIS AREA.

**THE SEPTIC TANK AND ALL PARTS OF THE DISTRIBUTION SYSTEM MUST BE A MINIMUM OF 10 FEET FROM
THE BUILDING FOUNDATION.**

A 30' X 40' RESERVE AREA, SIZED FOR TREATMENT LEVEL 3 EFFLUENT, HAS BEEN DESIGNATED TO SATISFY THE REQUIREMENTS OF THE CHESAPEAKE BAY PROTECTION ACT.

Construction Drawing

Owner Information	
Pollard, Albert	Phone: ()

Construction Drawing

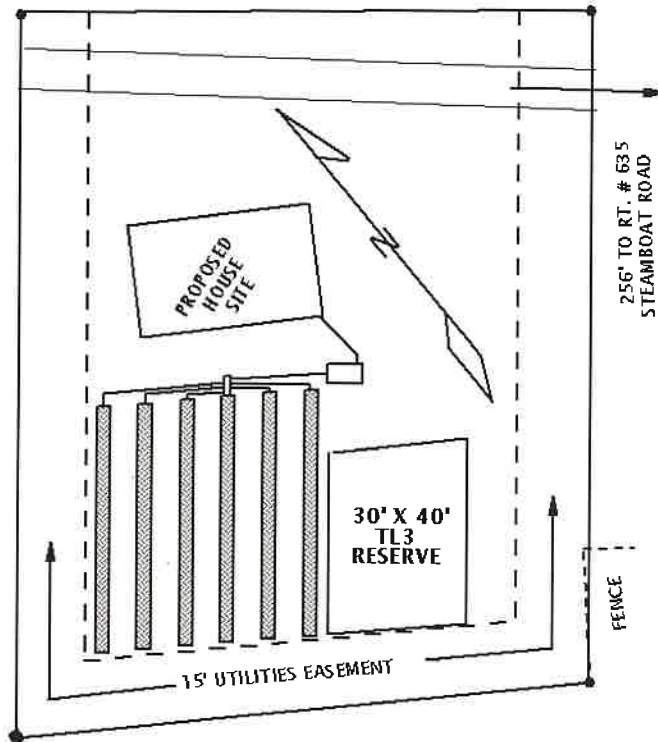

This sewage disposal system construction permit is null and void if conditions are changed from those shown on the application or construction permit. No part of any installation may be covered or used until inspected, corrections made if necessary and the system is approved. The inspection will normally be made by the system designer, who may be an AOSE, PE, or EHS. Any part of any installation which has been covered prior to approval shall be uncovered, if necessary, upon direction of the Department or the system designer.

This permit approval has been issued in accordance with applicable regulations based on the information and materials provided at the time of application. There may be other local, state, or federal laws or regulations that apply to the proposed construction of this onsite sewage system. The owner is responsible at all times for complying with all applicable local, state, and federal laws and regulations.

Site Evaluation and System Design By: Timothy Childs ;

Timothy Childs
 Timothy Childs, EHSS

December 05, 2012
 Issue Date

June 06, 2014
 Expiration Date

Tax Map #: 33-335B **HDID#:** 151-12-0190

**WHAT YOU WILL NEED TO GET YOUR
SEPTIC SYSTEM OPERATION PERMIT**

- Your system must have a **satisfactory inspection** at the time of installation. This will be done by either a representative of the local Health Department, a private OSE, or a PE, depending on the designer of your permitted system. If your system is designed/inspected by an OSE or PE, they must submit a copy of the inspection results, complete with an as-built diagram, to the Health Department.
- Please ensure that your contractor turns in a **Completion Statement** to the local Health Department after installation.
- Should you choose to reduce the size of your installed system using an approved substituted system product, a signed **Notice of Substitution** must be received by the local Health Department.
- If your permit is for an alternative system, you must sign, have notarized, and record the attached **Notice of Recordation** in your locality's land records. Please bring proof of this recordation to the local Health Department

POLLARD - TAX MAP # 33-335B - HDID# 151-12-0190

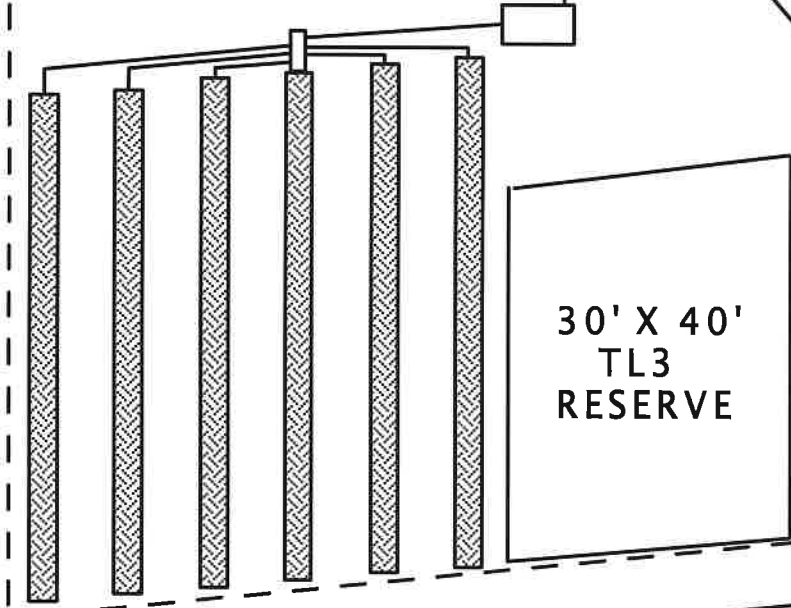
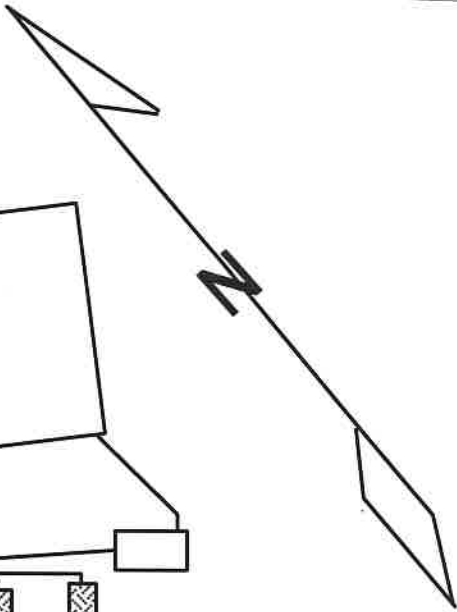
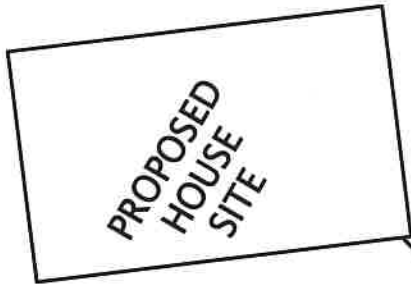

256' TO RT. # 635
STEAMBOAT ROAD

FENCE

15' UTILITIES EASEMENT

Commonwealth of Virginia

Application for: Sewage System Water Supply

VDH USE ONLY	
Receipt No	_____
Amount Rec'd	_____
Date Application Rec'd	_____
Health Department ID#	_____

Owner Albert C. Pollard

Mailing Address PO Box 266

Agent Irvington Va 22480

Mailing Address _____

Site Address 40 Steamboat Rd

Irvington VA

Directions to Property: Drive way is across from Clear Park Handicapped

Subdivision Drumming in at "Shore the Road" Section Sign Block _____ Lot _____

Tax Map Property is behind 54 Steamboat Rd. Tax map 33 335B Other Property Identification _____ Dimension/Acreage of Property _____

Home Phone 804 588 9539

Cell Phone 804 577 3613

Fax _____

Phone _____

Phone _____

Fax _____

Email _____

Sewage System (New Construction)

Construction permits are valid for 18-months. Owners are advised to apply for a construction permit if they intend to build within 18 months of completing this application. Certification letters do not expire, may be recorded in the land records, and transfer with a property sale. For which are you applying? Certification Letter Construction Permit

Sewage System (Existing Construction)

Check all that apply: Repair Modification Expansion Replacement Upgrade

Do you wish to apply for a betterment loan? _____ If yes, there is a \$50.00 fee for a betterment loan determination and you must complete the application addendum for betterment loans..

Sewage System (New or Existing Construction)

Single Family Home (Number of Bedrooms 3) Multi-Family Dwelling (Total Number of Bedrooms _____)

Other (describe) _____

Basement? Yes/No (circle one). Walk-out Basement? Yes/No (circle one) Fixtures in Basement? Yes/No (circle one).

Conditional permit desired? Yes/No (circle one). If yes, which conditions do you want?

Reduced water flow Limited occupancy Intermittent of seasonal use Seasonal or temporary use not to exceed 1 year

Water Supply

Will the water supply be Public or Private (circle one). Is the water supply Existing or Proposed (circle one).
 Drinking Water Supply Irrigation well Well Abandonment Heat Pump
if proposed, is this a replacement well? Yes/No (circle one). Will the old well be abandoned? Yes/No (circle one).

Will any buildings within 50' of the proposed well be termite treated? Yes/No (circle one).

Note: For sewage systems, a plat of the property may be required and a site sketch is always expected. For water supplies, a plat of the property is not required and a site sketch is always expected. The site sketch should show your property lines, actual and/or proposed buildings and the desired location of your well and/or sewage system. Your property lines, building location and the proposed well and sewage system sites must be clearly marked and sufficiently visible to see the topography.

I give permission to the Virginia Department of Health to enter onto the property during normal business hours for the purpose of processing this application and to perform quality assurance checks of evaluations and designs until an operation permit is approved.

Signature of Owner/Agent

11/30/2012

Date

MAGNETIC NORTH

(1955)

EUGENE GRAYSON MATTINGLY & SUZANNE F. MATTINGLY
(DEED BOOK 387 PAGE 209)

OLD ROAD BED (ABANDONED)

LAWRENCE R. & BONNIE T. PETTEY
(DEED BOOK 284 PAGE 601)

IRON PIPE FOUND

N51°25'28"W
106.41'

IRON PIPE FOUND

N31°30'44"E
71.24'

IRON PIPE FOUND

N09°30'54"E
81.03'

IRON PIPE FOUND

PARCEL 3
0.418 ACRES

FRAME SHED
10.1'x10.1'

ONE STORY MASONRY DWELLING

WATER METER

CONCRETE WALK

BRICK STEPS

SCREEN PORCH

POLE

CATHERINE P. KIMBROUGH & KAREN K. BARDEN, TRUSTEES
(DEED BOOK 391 PAGE 274)

S54°05'00"E
158.05'

PAUL E. HAWKINSON & CASSANDRA B. HAWKINSON
(DEED BOOK 403 PAGE 30)

N50°38'29"W
125.61'

IRON PIPE FOUND

N39°51'58"E
148.89'

IRON PIPE FOUND BY CONCRETE MONUMENT

PARCEL 2
0.447 ACRES

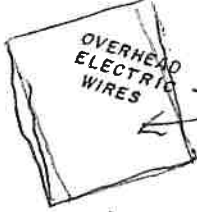

GRAVEL DRIVE

Proposed building site

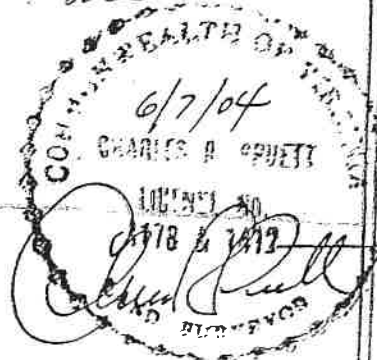

IRON PIPE FOUND

CORNER OF FENCE ON LINE

CORNER OF FENCE 0.9' N/W OF LINE

4' HIGH FENCE

EXISTING 16' ROAD RIGHT-OF-WAY
(DEED BOOK 103 PAGE 233)

S40°02'39"W
160.55'

S55°54'55"E
126.75'

BROKEN CONCRETE MONUMENT FOUND

JOSELIA DE OLIVEIRA DOLSEY
(WILL BOOK 43 PAGE 270)

GEORGE K. McNEAL & SHIRLEY W. McNEAL
(DEED BOOK 298 PAGE 438)

54 Steamboat Rd

EXISTING 16' ROAD RIGHT-OF-WAY
(DEED BOOK 103 PAGE 233)

STEAMBOAT ROAD
STATE ROUTE #635
(40' WIDE)

Show the Road Highway Sign

NOTES

- 1. THE LAND SHOWN HEREON IS NOW IN THE NAME OF SIGURD S. SOLEM AS RECORDED IN DEED BOOK 103 AT PAGE 233 AND IN DEED BOOK 135 PAGE 410 AMONG