

EarthWorks

Environmental Services, LLC
(770) 503-6488

1440 Gran Forest Drive
Cumming, GA 30041



LEVEL 3 SOIL INVESTIGATION REPORT

Report Date: 10/5/2023	Inspection Date: 9/30/2023	Level of Study: 3
Site Location: 6870 Bragg Road		Job No. 23476
Client: Christopher Shaun Schick		Phone: 678-350-8738
County: Forsyth	Parcel No: 272 125	
Field Inspection By: Jeffrey A. Reichel Jr.		
Boring Location Method: EOS Arrow 100 Submeter GPS Unit and Google Earth Professional		
Certified By: Jeffrey A. Reichel Jr, DPH CSC		

SOIL SERIES & INTERPRETIVE PROPERTIES

Soil Series & Slope Class (%)	Depth to Bedrock (in)	Depth to PWT* (in)	Estimated Perc. (min/in)	Depth of Estimated Perc/(in)	Recommended Installation Depth (in)	Soil Suitability Code
Rion, 2-15%	>72	>72	45	12-48	24-36	A
Rion, 15-25%	>64**	>64	45	12-48	24-36	A
Rion, 25-35%	>72	>72	45	12-60	24-48	A3

* Perched Water Table ** Auger Refusal on Seams of Quartz Fragments, Not Bedrock

SOIL SUITABILITY CODE DEFINITIONS

- A Soils are typically suitable for conventional absorption field with proper design, installation and maintenance.
- A3 Soils are typically suitable for conventional absorption field with proper design, installation and maintenance. Mapping unit include slopes greater than 25% which may require grading or special design considerations to overcome slope limitations.

GENERAL NOTES & COMMENTS

1. The base map was obtained from the Forsyth County GIS Website.
2. Borings were located using an EOS Arrow 100 Submeter GPS Unit and Google Earth Professional.
3. Modification of the site including cut and fill of the drain field area may void the conditions cited.
4. When installing drain line in clay soils, every effort should be made to prevent smearing trench walls and bottom. These conditions reduce drainage rate and may cause premature failure. Installation should be conducted under dry soil conditions. If smearing is evident, surface should be picked or raked prior to placement of distribution media.

NOTES:

1. PROPERTY BOUNDARIES & ELEVATION CONTOURS (2') WERE OBTAINED FROM THE FORSYTH COUNTY GIS WEBSITE AND SHOULD BE CONSIDERED APPROXIMATE.
2. STORMWATER MUST BE ROUTED AWAY FROM PRIMARY SEPTIC ABSORPTION FIELD FOR PROPER SYSTEM FUNCTION.
3. SOIL BORINGS WERE LOCATED USING AN EOS ARROW 100 SUBMETER GPS UNIT AND GOOGLE EARTH PROFESSIONAL.

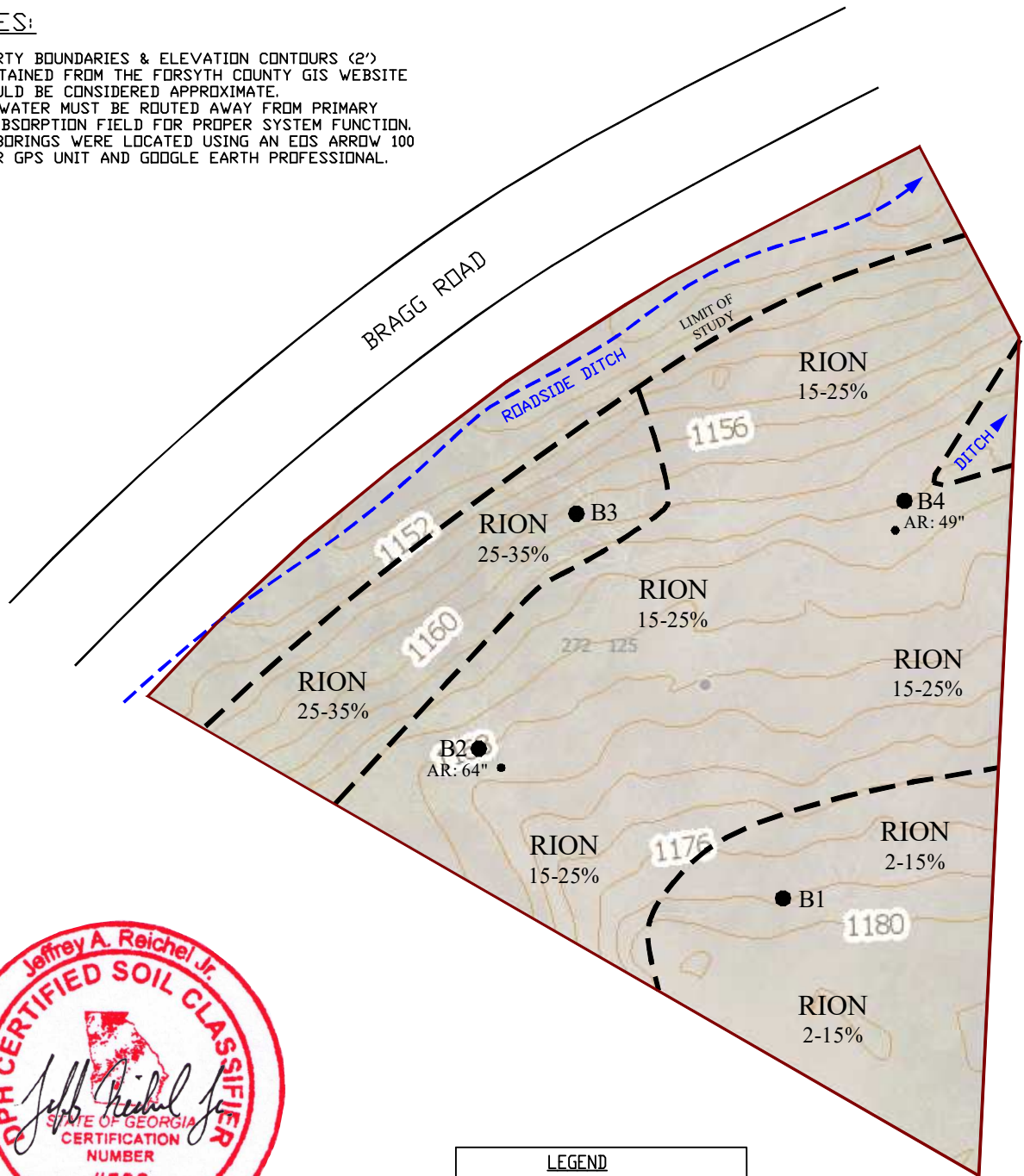

LEGEND	
●	= AUGER BORING
■	= SEPTIC TANK
□	= BACKHOE PIT
AR	= AUGER REFUSAL
PWT	= PERCHED WATER TABLE
↘	= SLOPE ARROW
○	= REFERENCE POINT
FD	= DEPTH OF OBSERVED FILL
BT	= BORING TERMINATION

EarthWorks
 Environmental Services, LLC
 (770) 503 - 6488 jeff@myearthworks.net

LEVEL 3 SOIL MAP
 6870 BRAGG ROAD
 PARCEL NO: 272 125
 FORSYTH COUNTY, GEORGIA

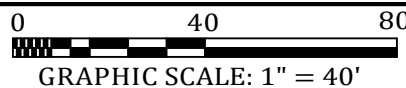

PROJECT NO: 23476
 LAST DATE OF FIELD WORK: 9/30/23
 DATE OF SOIL MAP: 10/5/23

