

# 2 GOLDENROD LN

**Location** 2 GOLDENROD LN

**Mblu** 8811/Z 42/ / /

**Owner** RIZZI FAMILY TRUST

**Total Market Value** \$670,300

**Appraisal** \$670,300

**PID** 105605

**Building Count** 1

**Tract #** 3888-N

**Tract #** 3888-W-1

**Tract #**

**Tract #**

**Tract #**

**Tract #**

## Current Value

| Appraisal      |           |                |              |           |           |
|----------------|-----------|----------------|--------------|-----------|-----------|
| Valuation Year | Building  | Extra Features | Outbuildings | Land      | Total     |
| 2025           | \$542,300 | \$1,800        | \$2,500      | \$123,700 | \$670,300 |
| Assessment     |           |                |              |           |           |
| Valuation Year | Building  | Extra Features | Outbuildings | Land      | Total     |
| 2025           | \$542,300 | \$1,800        | \$2,500      | \$123,700 | \$670,300 |

## Owner of Record

**Owner** RIZZI FAMILY TRUST

**Sale Price** \$0

**Co-Owner** RIZZI PAUL C JR & CATHY C TRUSTEES

**Certificate**

**Address** 2 GOLDENROD LN

**Book & Page** 3625/1330

CONCORD, NH 03301-2607

**Sale Date** 03/20/2019

**Instrument** 38

## Ownership History

| Ownership History         |            |             |             |            |            |
|---------------------------|------------|-------------|-------------|------------|------------|
| Owner                     | Sale Price | Certificate | Book & Page | Instrument | Sale Date  |
| RIZZI FAMILY TRUST        | \$0        |             | 3625/1330   | 38         | 03/20/2019 |
| RIZZI PAUL C JR & CATHY C | \$0        |             | 3518/1976   | 38         | 06/15/2016 |
| RIZZI JR PAUL C           | \$89,000   |             | 3459/1275   | 00         | 10/24/2014 |
| SHAWMUT HOLDING LLC       | \$0        |             | 3152/0876   | 31         | 08/31/2009 |
| SHAWMUT HOLDING LLC       | \$0        |             | 3152/0874   | 31         | 08/31/2009 |

## Building Information

### Building 1 : Section 1

**Year Built:** 2016  
**Living Area:** 3,108  
**Replacement Cost:** \$461,155  
**Replacement Cost Less Depreciation:** \$542,300

#### Building Attributes

| Field              | Description    |
|--------------------|----------------|
| Style:             | Colonial       |
| Model              | Residential    |
| Grade:             | Good           |
| Stories:           | 2              |
| Occupancy          | 1              |
| Exterior Wall 1    | Vinyl Siding   |
| Exterior Wall 2    |                |
| Roof Structure:    | Gable/Hip      |
| Roof Cover         | Asph/F GlS/Cmp |
| Interior Wall 1    | Drywall/Sheet  |
| Interior Wall 2    |                |
| Interior Flr 1     | Hardwood       |
| Interior Flr 2     |                |
| Heat Fuel          | Gas            |
| Heat Type:         | Forced Air-Duc |
| AC Type:           | Central        |
| Total Bedrooms:    | 3 Bedrooms     |
| Total Bthrms:      | 4              |
| Total Half Baths:  | 0              |
| Total Xtra Fixtrs: | 3              |
| Total Rooms:       | 11             |
| Trend              |                |

### Building Layout

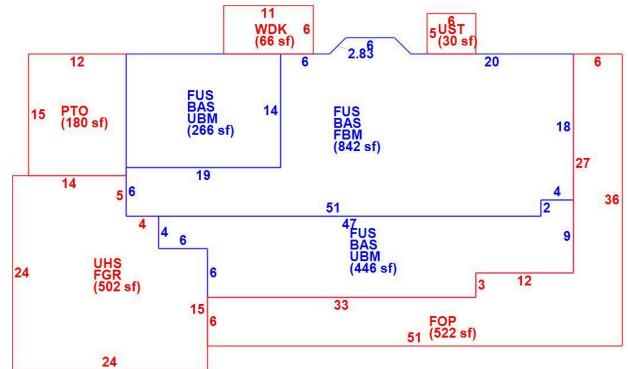

([ParcelSketch.ashx?pid=105605&bid=105127](#))

#### Building Sub-Areas (sq ft)

#### Legend

| Code | Description                  | Gross Area | Living Area |
|------|------------------------------|------------|-------------|
| BAS  | First Floor                  | 1,554      | 1,554       |
| FUS  | Upper Story, Finished        | 1,554      | 1,554       |
| FBM  | Basement, Finished           | 842        | 0           |
| FGR  | Garage                       | 502        | 0           |
| FOP  | Porch, Open                  | 522        | 0           |
| PTO  | Patio                        | 180        | 0           |
| UBM  | Basement, Unfinished         | 712        | 0           |
| UHS  | Half Story, Unfinished       | 502        | 0           |
| UST  | Utility, Storage, Unfinished | 30         | 0           |
| WDK  | Deck, Wood                   | 66         | 0           |
|      |                              | 6,464      | 3,108       |

### Extra Features

| Extra Features |             |            |         |                |        | Legend  |
|----------------|-------------|------------|---------|----------------|--------|---------|
| Code           | Description | Size       | Value   | Assessed Value | Bldg # | Comment |
| FPL            | FIREPLACE   | 1.00 UNITS | \$1,800 | \$1,800        | 1      |         |

### Land

**Land Use**

**Use Code** 1010  
**Description** SINGLE FAM MDL-01  
**Zone** RS  
**Neighborhood** 0101  
**Category**

**Land Line Valuation**

**Size (Acres)** 0.29  
**Total Market Land** \$123,700  
**Appraised Value** \$123,700

**Outbuildings**

| Outbuildings |               |          |                 |            |         |                |        | <u>Legend</u> |
|--------------|---------------|----------|-----------------|------------|---------|----------------|--------|---------------|
| Code         | Description   | Sub Code | Sub Description | Size       | Value   | Assessed Value | Bldg # | Comment       |
| GENR         | GENERATOR RES |          |                 | 1.00 UNITS | \$2,500 | \$2,500        | 1      |               |