

| CURRENT OWNER | | TOPO | UTILITIES | STRT / ROAD | LOCATION | CURRENT ASSESSMENT | | | | |
|---|--|------|---|-------------|----------|--------------------|------|-----------|----------|---|
| HOLT STEPHANIE C REV TRUST HOLT S C & CAUGHRAN S G TT 134 SPINNAKER WAY PORTSMOUTH NH 03801 | | | 0 All Public | | | Description | Code | Appraised | Assessed | 2229 PORTSMOUTH, NH VISION |
| | | | | | | RESIDNTL | 1020 | 647,200 | 647,200 | |
| SUPPLEMENTAL DATA | | | | | | | | | | |
| Alt Prcl ID 0217-0002-0097-0000 OLDACTN 71157 PHOTO WARD PREC. 1/2 HSE GIS ID 50232 | | | CONDO C INLAW Y/ LOT SPLIT 2015 Reva JM Ex/Cr Appli Assoc Pid# | | | | | | | |
| | | | | | | Total | | 647,200 | 647,200 | |

| RECORD OF OWNERSHIP | | BK-VOL/PAGE | SALE DATE | Q/U | V/I | SALE PRICE | VC | PREVIOUS ASSESSMENTS (HISTORY) | | | | | | | | |
|--------------------------------------|--|-------------|-----------|------------|-----|------------|---------|--------------------------------|-------|----------|-------|---------|------------|---------|------|----------|
| HOLT STEPHANIE C REV TRUST | | 6513 | 306 | 10-19-2023 | U | I | 0 | Year | Code | Assessed | Year | Code | Assessed V | Year | Code | Assessed |
| HOLT STEPHANIE C | | 6164 | 2679 | 09-15-2020 | Q | I | 445,000 | 2025 | 1020 | 647,200 | 2024 | 1020 | 647,200 | 2023 | 1020 | 430,700 |
| ERWIN DIANE E | | 6118 | 2389 | 05-27-2020 | U | I | 0 | | | | | | | | | |
| KRESSLEY C G REV LIV TRUST (1/2 INT) | | 6044 | 2508 | 10-09-2019 | U | I | 0 | | | | | | | | | |
| KRESSLEY CATHERINE G | | 5842 | 2330 | 08-07-2017 | Q | I | 365,000 | | | | | | | | | |
| | | | | | | Total | | 647,200 | Total | 647,200 | Total | 647,200 | Total | 430,700 | | |

| EXEMPTIONS | | | | OTHER ASSESSMENTS | | | | This signature acknowledges a visit by a Data Collector or Assessor | | | | | | | | |
|------------|------|---------------|------------|-------------------|-------------|--------|--------|---|--|--|--|--|--|--|--|--|
| Year | Code | Description | Amount | Code | Description | Number | Amount | Comm Int | | | | | | | | |
| 2025 | 7 | 75-79 ELDERLY | 450000.00 | | | | | | | | | | | | | |
| Total | | | 450,000.00 | | | | | | | | | | | | | |

| ASSESSING NEIGHBORHOOD | | | | APPROAISED VALUE SUMMARY | | | | |
|------------------------|-----------|-------------------|---------|--------------------------|-------------------------------|---------|--|--|
| Nbhd | Nbhd Name | STREET INDEX NAME | Tracing | Batch | | | | |
| 220 | | | | | Appraised Bldg. Value (Card) | 647,200 | | |
| | | | | | Appraised Xf (B) Value (Bldg) | 0 | | |
| | | | | | Appraised Ob (B) Value (Bldg) | 0 | | |
| | | | | | Appraised Land Value (Bldg) | 0 | | |
| | | | | | Special Land Value | 0 | | |
| | | | | | Total Appraised Parcel Value | 647,200 | | |
| | | | | | Valuation Method | C | | |
| | | | | | Total Appraised Parcel Value | 647,200 | | |

| NOTES | | | | | | | | BUILDING PERMIT RECORD | | | | | | | | VISIT / CHANGE HISTORY | | | | | | |
|--|--|--|--|--|--|--|--|------------------------|------------|------|-------------|--------|------------|--------|------------|---------------------------------|------------|----|------|----|--------------------------|--------------------------|
| SPINNAKER POINT CONDOS #134 | | | | 9/20-MLS-EAT IN KITCH W/ GRANITE & CUST | | | | Permit Id | Issue Date | Type | Description | Amount | Insp Date | % Comp | Date Comp | Comments | Date | Id | Type | Is | Cd | Purpose/Result |
| CATHEDRAL AREA = 1.5sFR | | | | TILE; NICE LIVING RM AREA W/ CTH; | | | | PMGR-20-6 | 11-25-2020 | | | 900 | 12-16-2020 | 100 | 11-30-2020 | Gas piping Install / Add 35? of | 08-22-2024 | SW | | | FR | Field Review Stat Update |
| 06/10 - REVIEW; OWNER; KITCH/BATH= FORM | | | | 12/2020 BP: GAS PIPING FOR KIT RANG NCIV | | | | | | | | | | | | | 05-20-2021 | LS | | | AD | Address Change |
| CT, WHI PB CABS, TILE FL; 2ND FL= 2 BDRM | | | | | | | | | | | | | | | | | 12-16-2020 | VS | 03 | 3 | 50 | Building Permit |
| HRDWD FL; LIVRM= BUILT IN BK CABS | | | | | | | | | | | | | | | | | 09-14-2020 | BH | 03 | 5 | ML | MLS Review |
| 04/14- NOH; ADJ SKTCH, CHNG BAS 12X15 | | | | | | | | | | | | | | | | | 12-07-2017 | VS | 03 | 1 | SR | Sales Review |
| | | | | | | | | | | | | | | | | 07-24-2017 | KL | | | FR | Field Review Stat Update | |
| | | | | | | | | | | | | | | | | 05-06-2015 | RT | | | FR | Field Review Stat Update | |

| LAND LINE VALUATION SECTION | | | | | | | | | | | | | | | | | | |
|-----------------------------|----------|-------------|------|----------|-------|------------|------------|------------------------|--------|-------|--------|-----------|------------|-----------------|------------------|------------|--|---|
| B | Use Code | Description | Zone | Frontage | Depth | Land Units | Unit Price | Size Ad | Site | Cond. | ST Idx | S.I. Adj. | Notes- Adj | Special Pricing | Adj Unit P | Land Value | | |
| 1 | 1020 | CONDO | GA/ | | | 0.000 | AC | 0.00 | 1.0000 | 0 | 1.00 | 220 | 1.000 | 102 | 0 | 0 | | |
| Total Card Land Units | | | | | | 0 | AC | Parcel Total Land Area | | | | | | 0 | Total Land Value | | | 0 |

| CONSTRUCTION DETAIL | | | CONSTRUCTION DETAIL (CONTINUED) | | |
|--------------------------|-----|----------------|---------------------------------|----|-------------|
| Element | Cd | Description | Element | Cd | Description |
| Style: | 122 | Townhouse End | | | |
| Model | 05 | Res Condo | | | |
| Grade | B- | B- | | | |
| Stories: | 2 | | | | |
| Occupancy | 1 | | | | |
| Interior Wall 1: | 05 | Drywall/Sheet | | | |
| Interior Wall 2: | | | | | |
| Interior Floor 1 | 12 | Hardwood | | | |
| Interior Floor 2 | 11 | Ceram Clay Til | | | |
| Heat Fuel: | 03 | Gas | | | |
| Heat Type: | 04 | Hot Water | | | |
| AC Type: | 03 | Central | | | |
| Ttl Bedrms: | 03 | 3 Bedrooms | | | |
| Ttl Bathrms: | 2 | 2 Full | | | |
| Ttl Half Bths: | 1 | | | | |
| Xtra Fixtres | 1 | | | | |
| Total Rooms: | 7 | | | | |
| Bath Style: | 1 | Avg Quality | | | |
| Kitchen Style: | 2 | Above Avg Qual | | | |
| WB Fireplaces | 0 | | | | |
| WB Openings | 0 | | | | |
| Mtl Fireplaces | 1 | | | | |
| MTL Openings | 0 | | | | |
| Kitchen Grd | 0 | | | | |
| Cost/Design Class | 0 | | | | |
| | | | CONDO DATA | | |
| Parcel Id | | 50232 | C 232 | | Owne |
| | | 0217-0002 | B 1 | | S 1 |
| Adjust Type | | Code | Description | | Factor% |
| Condo Flr | | | | | 100 |
| Condo Unit | | | | | 100 |
| | | | COST / MARKET VALUATION | | |
| Adj. Base Rate | | 366.12 | | | |
| Building Value New | | 743,954 | | | |
| Year Built | | 1998 | | | |
| Effective Year Built | | 2011 | | | |
| Depreciation Code | | GD | | | |
| Remodel Rating | | | | | |
| Year Remodeled | | | | | |
| Depreciation % | | 13 | | | |
| Functional Obsol | | | | | |
| External Obsol | | | | | |
| Trend Factor | | 1 | | | |
| Condition | | | | | |
| Condition % | | | | | |
| Percent Good | | 87 | | | |
| Cns Sect Rcnd | | 647,200 | | | |
| Dep % Ovr | | | | | |
| Dep Ovr Comment | | | | | |
| Misc Imp Ovr | | | | | |
| Misc Imp Ovr Comment | | | | | |
| Cost to Cure Ovr | | | | | |
| Cost to Cure Ovr Comment | | | | | |

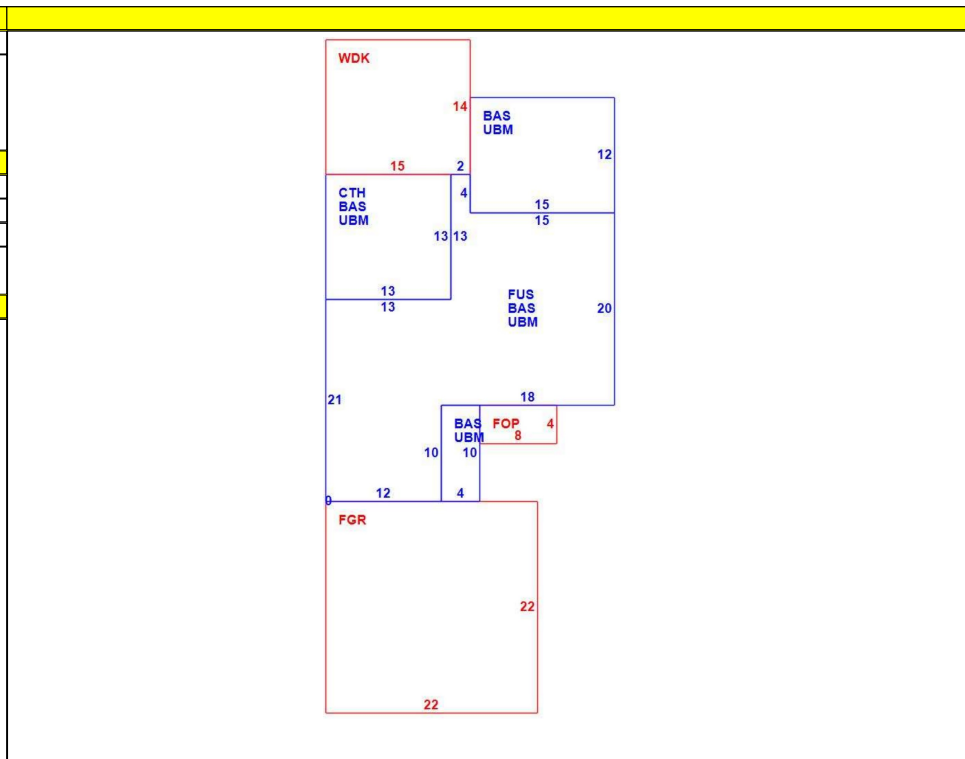

| OB - OUTBUILDING & YARD ITEMS(L) / XF - BUILDING EXTRA FEATURES(B) | | | | | | | | | | |
|--|-------------|-----|-------|------------|--------|------|------|----|--------|-------------|
| Code | Description | L/B | Units | Unit Price | Yr Blt | Cond | % Gd | Gr | Gr Adj | Appr. Value |
| | | | | | | | | | | |

| BUILDING SUB-AREA SUMMARY SECTION | | | | | | |
|-----------------------------------|-----------------------|-------------|------------|----------|-----------|----------------|
| Code | Description | Living Area | Floor Area | Eff Area | Unit Cost | Undeprec Value |
| BAS | First Floor | 1,000 | 1,000 | 1,000 | 366.12 | 366,119 |
| CTH | Cathedral Ceiling | 0 | 169 | 0 | 0.00 | 0 |
| FGR | Garage, Attached | 0 | 484 | 194 | 146.75 | 71,027 |
| FOP | Porch, Open | 0 | 32 | 6 | 68.65 | 2,197 |
| FUS | Upper Story, Finished | 611 | 611 | 611 | 366.12 | 223,699 |
| UBM | Basement, Unfinished | 0 | 1,000 | 200 | 73.22 | 73,224 |
| WDK | Deck, Wood | 0 | 210 | 21 | 36.61 | 7,689 |
| Ttl Gross Liv / Lease Area | | 1,611 | 3,506 | 2,032 | | 743,955 |

