

# 2283 COLD CHEER DR

|                           |                    |                       |                         |
|---------------------------|--------------------|-----------------------|-------------------------|
| <b>Location</b>           | 2283 COLD CHEER DR | <b>Mblu</b>           | 37/ 8/ 31/ /            |
| <b>Acct#</b>              | 2162               | <b>Owner</b>          | CLARKE WILLIAM E        |
| <b>Taxable Status</b>     | Non-Exempt         | <b>Class</b>          | Sngl Fam Res - Suburban |
| <b>Total Market Va...</b> | \$523,100          | <b>Appraisal</b>      | \$523,100               |
| <b>PID</b>                | 1227               | <b>Building Count</b> | 1                       |

## Current Value

| Appraisal      |              |           |           |
|----------------|--------------|-----------|-----------|
| Valuation Year | Improvements | Land      | Total     |
| 2025           | \$408,600    | \$114,500 | \$523,100 |

| Assessment     |              |           |           |
|----------------|--------------|-----------|-----------|
| Valuation Year | Improvements | Land      | Total     |
| 2025           | \$408,600    | \$114,500 | \$523,100 |

## Owner of Record

|          |                        |             |            |
|----------|------------------------|-------------|------------|
| Owner    | CLARKE WILLIAM E       | Sale Price  | \$350,000  |
| Co-Owner | CLARKE KRISTEN B R/S   | Certificate | 19         |
| Address  | 2283 COLD CHEER DR     | Book & Page | 0/0        |
|          | TAPPAHANNOCK, VA 22560 | Sale Date   | 07/19/2019 |
|          |                        | Instrument  | 00         |

## Ownership History

| Ownership History |            |             |             |            |            |
|-------------------|------------|-------------|-------------|------------|------------|
| Owner             | Sale Price | Certificate | Book & Page | Instrument | Sale Date  |
| CLARKE WILLIAM E  | \$350,000  | 19          | 0/0         | 00         | 07/19/2019 |

## Building Information

### Building 1 : Section 1

Year Built: 2005  
 Living Area: 3,345  
 Replacement Cost: \$570,161  
 Building Percent Good: 69  
 Replacement Cost Less Depreciation: \$393,400

| Building Attributes |             |
|---------------------|-------------|
| Field               | Description |
| Model               | Residential |
| Style               | Ranch       |
|                     |             |

|                  |              |
|------------------|--------------|
| Grade            | Grade B-     |
| Stories          | 1            |
| # Units          |              |
| Roof Type 1      | Gable        |
| Roof Type 2      |              |
| Roof Cover 1     | Comp Shingle |
| Roof Cover 2     |              |
| Roof Cover 3     |              |
| Exterior Wall 1  | Vinyl        |
| Exterior Wall 2  |              |
| Exterior Wall 3  |              |
| Heat System      | Other        |
| Heat Fuel 1      | Electric     |
| Heat Fuel 2      | Gas          |
| Heat Fuel 3      |              |
| AC Type          | 100%         |
| Interior Wall 1  | Drywall      |
| Interior Wall 2  |              |
| Interior Wall 3  |              |
| Interior Floor 1 | Carpet       |
| Interior Floor 2 | Vinyl        |
| Interior Floor 3 |              |
| Interior Floor 4 |              |
| Total Room(s)    | 6            |
| Bedroom(s)       | 3            |
| Full Bath(s)     | 2            |
| Half Bath(s)     | 1            |
| Extra Fixture(s) | 0            |
| Extra Kitchen(s) |              |
| Fireplace(s)     | 0            |
| Chimney(s)       | 0            |
| Foundation 1     | Brick        |
| Foundation 2     |              |
| Foundation 3     |              |
| Foundation 4     |              |
| Basement         |              |
| Fin Bsmt Area    |              |
| # Mobile Homes   |              |
| MH Type          |              |
| Central Heat     | Yes          |
| Central Air      | Yes          |

## Building Photo



(<https://images.vgsi.com/photos/EssexVAPhotos//\MAP378-31.JPG>)

## Building Layout

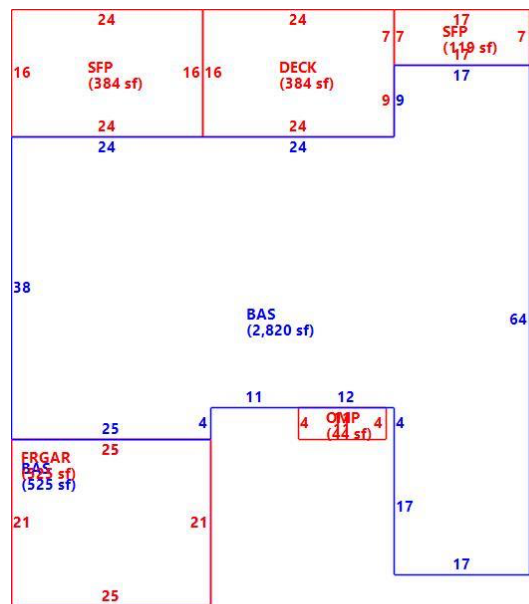

(ParcelSketch.ashx?pid=1227&bid=1227)

| Building Sub-Areas (sq ft) |                  | Legend     |             |
|----------------------------|------------------|------------|-------------|
| Code                       | Description      | Gross Area | Living Area |
| BAS                        | First Floor      | 3,345      | 3,345       |
| DECK                       | Deck             | 384        | 0           |
| FRGAR                      | Frame Garage     | 525        | 0           |
| OMP                        | Open Brick Porch | 44         | 0           |
| SFP                        | Screened Porch   | 503        | 0           |
|                            |                  | 4,801      | 3,345       |

## Extra Features

**Extra Features****Legend**

No Data for Extra Features

**Land****Land Use**

Use Code 200R  
 Description SFD - Suburban - Res  
 Zone  
 Neighborhood 74  
 Alt Land Appr No  
 Category

**Land Line Valuation**

Size (Acres) 3.91  
 Frontage 0  
 Depth 0  
 Total Market Land \$114,500  
 Appraised Value \$114,500

**Outbuildings**

| <b>Outbuildings</b> |                    |                 |                        |               |              | <b>Legend</b> |
|---------------------|--------------------|-----------------|------------------------|---------------|--------------|---------------|
| <b>Code</b>         | <b>Description</b> | <b>Sub Code</b> | <b>Sub Description</b> | <b>Size</b>   | <b>Value</b> | <b>Bldg #</b> |
| STORG               | Storage            | CB              | Conc Block             | 240.00 UNITS  | \$3,100      | 1             |
| LEANTO              | Lean-To            |                 |                        | 240.00 UNITS  | \$3,500      | 1             |
| PAVNG               | Paving             | CONC            | Concrete               | 3600.00 UNITS | \$8,600      | 1             |

**Valuation History**

| <b>Appraisal</b>      |                     |             |              |
|-----------------------|---------------------|-------------|--------------|
| <b>Valuation Year</b> | <b>Improvements</b> | <b>Land</b> | <b>Total</b> |
| 2024                  | \$408,600           | \$114,500   | \$523,100    |
| 2023                  | \$319,100           | \$94,920    | \$414,020    |
| 2021                  | \$319,100           | \$94,900    | \$414,000    |

| <b>Assessment</b>     |                     |             |              |
|-----------------------|---------------------|-------------|--------------|
| <b>Valuation Year</b> | <b>Improvements</b> | <b>Land</b> | <b>Total</b> |
| 2024                  | \$408,600           | \$114,500   | \$523,100    |
| 2023                  | \$319,100           | \$94,900    | \$414,000    |
| 2021                  | \$319,100           | \$94,900    | \$414,000    |