

Building Sketch (Page - 1) 21-002758-02-01

Borrower	Eric Werner			
Property Address	1609 Noble Way			
City	Flower Mound	County	Denton	State TX Zip Code 75022
Lender/Client	First United Bank			

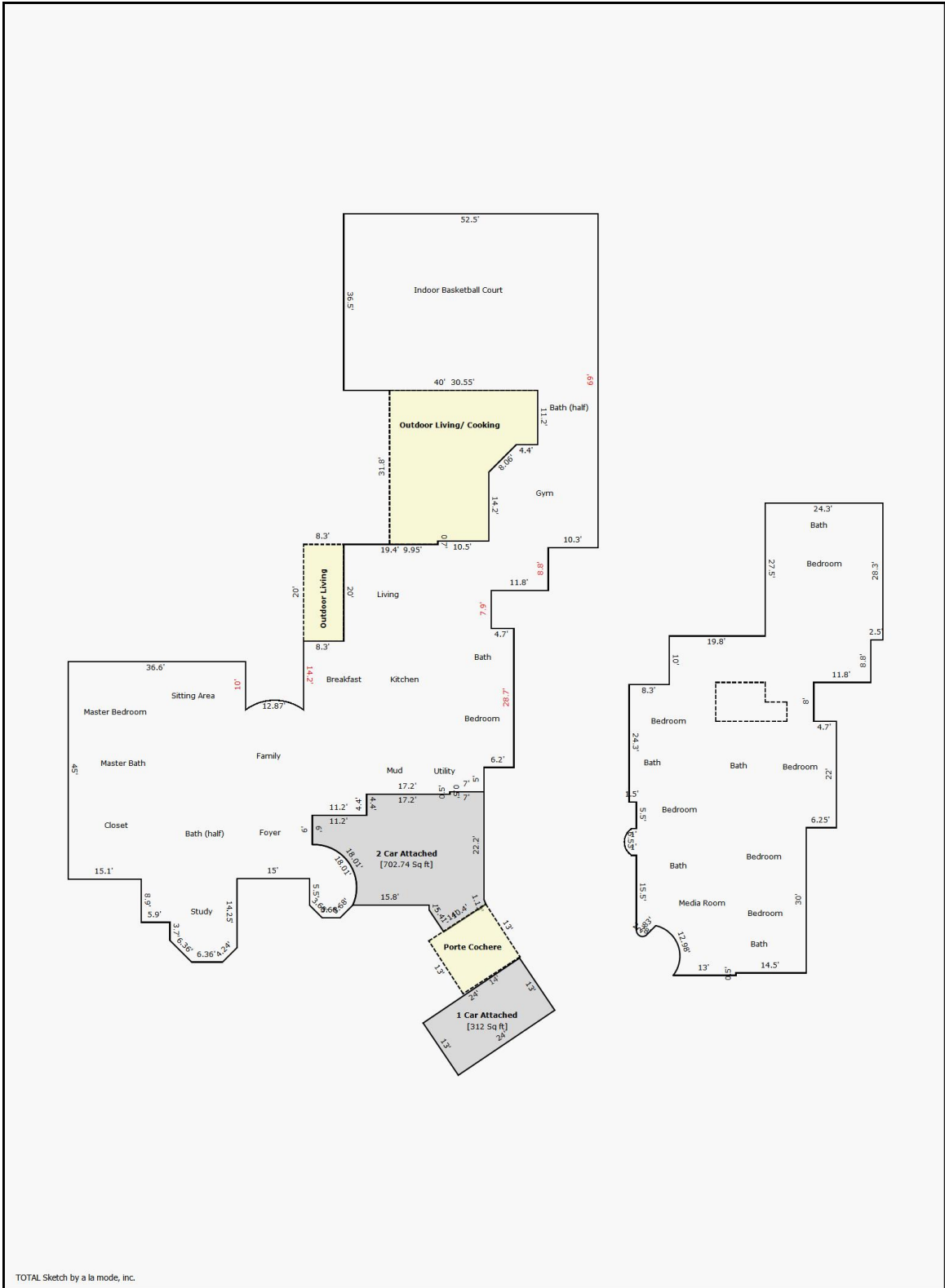

TOTAL Sketch by a la mode, inc.

Building Sketch (Page - 2) 21-002758-02-01

Borrower	Eric Werner			
Property Address	1609 Noble Way			
City	Flower Mound	County	Denton	State TX Zip Code 75022
Lender/Client	First United Bank			

TOTAL Sketch by a la mode, inc.

Area Calculations Summary

Living Area	Calculation Details																																																																																																													
First Floor	7139.32 Sq ft	<table style="width: 100%; border: none;"> <tr><td>52.5 × 36.5</td><td>=</td><td>1916.25</td></tr> <tr><td>12.5 × 11.2</td><td>=</td><td>140</td></tr> <tr><td>21.3 × 10.3</td><td>=</td><td>219.39</td></tr> <tr><td>45 × 15.1</td><td>=</td><td>679.5</td></tr> <tr><td>30.1 × 6.6</td><td>=</td><td>198.66</td></tr> <tr><td>53.9 × 5.9</td><td>=</td><td>318.01</td></tr> <tr><td>24.9 × 5.2</td><td>=</td><td>129.48</td></tr> <tr><td>0.5 × 5.2 × 5.2</td><td>=</td><td>13.52</td></tr> <tr><td>28.7 × 4.7</td><td>=</td><td>134.89</td></tr> <tr><td>57.6 × 4.5</td><td>=</td><td>259.2</td></tr> <tr><td>0.5 × 4.5 × 4.5</td><td>=</td><td>10.12</td></tr> <tr><td>62.1 × 6.36</td><td>=</td><td>394.96</td></tr> <tr><td>59.11 × 2.99</td><td>=</td><td>176.6</td></tr> <tr><td>0.5 × 2.99 × 2.99</td><td>=</td><td>4.46</td></tr> <tr><td>44.85 × 1.75</td><td>=</td><td>78.59</td></tr> <tr><td>34.85 × 12</td><td>=</td><td>418.17</td></tr> <tr><td>49.05 × 1.25</td><td>=</td><td>61.19</td></tr> <tr><td>54.55 × 0.55</td><td>=</td><td>30.13</td></tr> <tr><td>0.5 × 0.55 × 0.55</td><td>=</td><td>0.15</td></tr> <tr><td>11.2 × 4.4</td><td>=</td><td>49.28</td></tr> <tr><td>31.6 × 6.5</td><td>=</td><td>205.4</td></tr> <tr><td>51.6 × 19.4</td><td>=</td><td>1001.04</td></tr> <tr><td>2.5 × 0.5</td><td>=</td><td>1.25</td></tr> <tr><td>9.5 × 5</td><td>=</td><td>47.5</td></tr> <tr><td>11 × 46.8</td><td>=</td><td>514.8</td></tr> <tr><td>0.5 × 14.2</td><td>=</td><td>7.1</td></tr> <tr><td>0.5 × 0.5 × 0.5</td><td>=</td><td>0.12</td></tr> <tr><td>2.9 × 2.6</td><td>=</td><td>7.54</td></tr> <tr><td>0.5 × 2.6 × 2.6</td><td>=</td><td>3.39</td></tr> <tr><td>0.5 × 2.6 × 2.6</td><td>=</td><td>3.39</td></tr> <tr><td>8.1 × 3.68</td><td>=</td><td>29.78</td></tr> <tr><td>0.5 × 3.68 × 3.68</td><td>=</td><td>6.76</td></tr> <tr><td>0.5 × 11.78 × 2.98</td><td>=</td><td>17.57</td></tr> <tr><td>0.5 × 14.26 × 0.01</td><td>=</td><td>0.09</td></tr> <tr><td>Arc</td><td>=</td><td>44.68</td></tr> <tr><td>Arc</td><td>=</td><td>16.35</td></tr> </table>	52.5 × 36.5	=	1916.25	12.5 × 11.2	=	140	21.3 × 10.3	=	219.39	45 × 15.1	=	679.5	30.1 × 6.6	=	198.66	53.9 × 5.9	=	318.01	24.9 × 5.2	=	129.48	0.5 × 5.2 × 5.2	=	13.52	28.7 × 4.7	=	134.89	57.6 × 4.5	=	259.2	0.5 × 4.5 × 4.5	=	10.12	62.1 × 6.36	=	394.96	59.11 × 2.99	=	176.6	0.5 × 2.99 × 2.99	=	4.46	44.85 × 1.75	=	78.59	34.85 × 12	=	418.17	49.05 × 1.25	=	61.19	54.55 × 0.55	=	30.13	0.5 × 0.55 × 0.55	=	0.15	11.2 × 4.4	=	49.28	31.6 × 6.5	=	205.4	51.6 × 19.4	=	1001.04	2.5 × 0.5	=	1.25	9.5 × 5	=	47.5	11 × 46.8	=	514.8	0.5 × 14.2	=	7.1	0.5 × 0.5 × 0.5	=	0.12	2.9 × 2.6	=	7.54	0.5 × 2.6 × 2.6	=	3.39	0.5 × 2.6 × 2.6	=	3.39	8.1 × 3.68	=	29.78	0.5 × 3.68 × 3.68	=	6.76	0.5 × 11.78 × 2.98	=	17.57	0.5 × 14.26 × 0.01	=	0.09	Arc	=	44.68	Arc	=	16.35
52.5 × 36.5	=	1916.25																																																																																																												
12.5 × 11.2	=	140																																																																																																												
21.3 × 10.3	=	219.39																																																																																																												
45 × 15.1	=	679.5																																																																																																												
30.1 × 6.6	=	198.66																																																																																																												
53.9 × 5.9	=	318.01																																																																																																												
24.9 × 5.2	=	129.48																																																																																																												
0.5 × 5.2 × 5.2	=	13.52																																																																																																												
28.7 × 4.7	=	134.89																																																																																																												
57.6 × 4.5	=	259.2																																																																																																												
0.5 × 4.5 × 4.5	=	10.12																																																																																																												
62.1 × 6.36	=	394.96																																																																																																												
59.11 × 2.99	=	176.6																																																																																																												
0.5 × 2.99 × 2.99	=	4.46																																																																																																												
44.85 × 1.75	=	78.59																																																																																																												
34.85 × 12	=	418.17																																																																																																												
49.05 × 1.25	=	61.19																																																																																																												
54.55 × 0.55	=	30.13																																																																																																												
0.5 × 0.55 × 0.55	=	0.15																																																																																																												
11.2 × 4.4	=	49.28																																																																																																												
31.6 × 6.5	=	205.4																																																																																																												
51.6 × 19.4	=	1001.04																																																																																																												
2.5 × 0.5	=	1.25																																																																																																												
9.5 × 5	=	47.5																																																																																																												
11 × 46.8	=	514.8																																																																																																												
0.5 × 14.2	=	7.1																																																																																																												
0.5 × 0.5 × 0.5	=	0.12																																																																																																												
2.9 × 2.6	=	7.54																																																																																																												
0.5 × 2.6 × 2.6	=	3.39																																																																																																												
0.5 × 2.6 × 2.6	=	3.39																																																																																																												
8.1 × 3.68	=	29.78																																																																																																												
0.5 × 3.68 × 3.68	=	6.76																																																																																																												
0.5 × 11.78 × 2.98	=	17.57																																																																																																												
0.5 × 14.26 × 0.01	=	0.09																																																																																																												
Arc	=	44.68																																																																																																												
Arc	=	16.35																																																																																																												
Second Floor	3301.41 Sq ft	<table style="width: 100%; border: none;"> <tr><td>5.5 × 1</td><td>=</td><td>5.5</td></tr> <tr><td>24.3 × 27.5</td><td>=</td><td>668.25</td></tr> <tr><td>0.8 × 2.5</td><td>=</td><td>2</td></tr> <tr><td>9.6 × 11.8</td><td>=</td><td>113.28</td></tr> <tr><td>29.8 × 10</td><td>=</td><td>298</td></tr> <tr><td>22 × 4.7</td><td>=</td><td>103.4</td></tr> <tr><td>38.1 × 24.3</td><td>=</td><td>925.83</td></tr> <tr><td>5.3 × 1.55</td><td>=</td><td>8.22</td></tr> <tr><td>35.05 × 25.5</td><td>=</td><td>893.78</td></tr> <tr><td>9.8 × 14.5</td><td>=</td><td>142.1</td></tr> <tr><td>10.3 × 13</td><td>=</td><td>133.9</td></tr> <tr><td>0.5 × 10.3 × 3.55</td><td>=</td><td>18.28</td></tr> <tr><td>1 × 2</td><td>=</td><td>2</td></tr> <tr><td>0.5 × 2 × 1</td><td>=</td><td>1</td></tr> <tr><td>0.5 × 2 × 2</td><td>=</td><td>2</td></tr> <tr><td>Arc</td><td>=</td><td>5.81</td></tr> <tr><td>Arc</td><td>=</td><td>1.12</td></tr> <tr><td>Negative Arc</td><td>=</td><td>23.06</td></tr> </table>	5.5 × 1	=	5.5	24.3 × 27.5	=	668.25	0.8 × 2.5	=	2	9.6 × 11.8	=	113.28	29.8 × 10	=	298	22 × 4.7	=	103.4	38.1 × 24.3	=	925.83	5.3 × 1.55	=	8.22	35.05 × 25.5	=	893.78	9.8 × 14.5	=	142.1	10.3 × 13	=	133.9	0.5 × 10.3 × 3.55	=	18.28	1 × 2	=	2	0.5 × 2 × 1	=	1	0.5 × 2 × 2	=	2	Arc	=	5.81	Arc	=	1.12	Negative Arc	=	23.06																																																						
5.5 × 1	=	5.5																																																																																																												
24.3 × 27.5	=	668.25																																																																																																												
0.8 × 2.5	=	2																																																																																																												
9.6 × 11.8	=	113.28																																																																																																												
29.8 × 10	=	298																																																																																																												
22 × 4.7	=	103.4																																																																																																												
38.1 × 24.3	=	925.83																																																																																																												
5.3 × 1.55	=	8.22																																																																																																												
35.05 × 25.5	=	893.78																																																																																																												
9.8 × 14.5	=	142.1																																																																																																												
10.3 × 13	=	133.9																																																																																																												
0.5 × 10.3 × 3.55	=	18.28																																																																																																												
1 × 2	=	2																																																																																																												
0.5 × 2 × 1	=	1																																																																																																												
0.5 × 2 × 2	=	2																																																																																																												
Arc	=	5.81																																																																																																												
Arc	=	1.12																																																																																																												
Negative Arc	=	23.06																																																																																																												
Total Living Area (Rounded):	10441 Sq ft																																																																																																													
Non-living Area																																																																																																														
1 Car Attached	312 Sq ft	<table style="width: 100%; border: none;"> <tr><td>13 × 24</td><td>=</td><td>312</td></tr> </table>	13 × 24	=	312																																																																																																									
13 × 24	=	312																																																																																																												
Outdoor Living	166 Sq ft	<table style="width: 100%; border: none;"> <tr><td>8.3 × 20</td><td>=</td><td>166</td></tr> </table>	8.3 × 20	=	166																																																																																																									
8.3 × 20	=	166																																																																																																												
Outdoor Living/ Cooking	772.4 Sq ft	<table style="width: 100%; border: none;"> <tr><td>30.55 × 11.2</td><td>=</td><td>342.19</td></tr> <tr><td>0.5 × 5.7 × 5.7</td><td>=</td><td>16.24</td></tr> <tr><td>20.45 × 5.7</td><td>=</td><td>116.58</td></tr> <tr><td>20.45 × 14.2</td><td>=</td><td>290.42</td></tr> <tr><td>9.95 × 0.7</td><td>=</td><td>6.97</td></tr> </table>	30.55 × 11.2	=	342.19	0.5 × 5.7 × 5.7	=	16.24	20.45 × 5.7	=	116.58	20.45 × 14.2	=	290.42	9.95 × 0.7	=	6.97																																																																																													
30.55 × 11.2	=	342.19																																																																																																												
0.5 × 5.7 × 5.7	=	16.24																																																																																																												
20.45 × 5.7	=	116.58																																																																																																												
20.45 × 14.2	=	290.42																																																																																																												
9.95 × 0.7	=	6.97																																																																																																												
2 Car Attached	702.74 Sq ft	<table style="width: 100%; border: none;"> <tr><td>0.5 × 1.33 × 0.43</td><td>=</td><td>0.28</td></tr> <tr><td>0.5 × 4.59 × 7</td><td>=</td><td>16.05</td></tr> <tr><td>23.53 × 7</td><td>=</td><td>164.69</td></tr> <tr><td>0.5 × 0.83 × 1.27</td><td>=</td><td>0.53</td></tr> <tr><td>27.61 × 1.27</td><td>=</td><td>35.14</td></tr> <tr><td>0.5 × 3 × 4.5</td><td>=</td><td>6.75</td></tr> <tr><td>23.95 × 3</td><td>=</td><td>71.84</td></tr> <tr><td>22.95 × 12.93</td><td>=</td><td>296.65</td></tr> <tr><td>18.55 × 2.87</td><td>=</td><td>53.28</td></tr> <tr><td>0.5 × 8.33 × 12.55</td><td>=</td><td>52.24</td></tr> <tr><td>6 × 8.33</td><td>=</td><td>49.97</td></tr> <tr><td>Negative Arc</td><td>=</td><td>44.68</td></tr> </table>	0.5 × 1.33 × 0.43	=	0.28	0.5 × 4.59 × 7	=	16.05	23.53 × 7	=	164.69	0.5 × 0.83 × 1.27	=	0.53	27.61 × 1.27	=	35.14	0.5 × 3 × 4.5	=	6.75	23.95 × 3	=	71.84	22.95 × 12.93	=	296.65	18.55 × 2.87	=	53.28	0.5 × 8.33 × 12.55	=	52.24	6 × 8.33	=	49.97	Negative Arc	=	44.68																																																																								
0.5 × 1.33 × 0.43	=	0.28																																																																																																												
0.5 × 4.59 × 7	=	16.05																																																																																																												
23.53 × 7	=	164.69																																																																																																												
0.5 × 0.83 × 1.27	=	0.53																																																																																																												
27.61 × 1.27	=	35.14																																																																																																												
0.5 × 3 × 4.5	=	6.75																																																																																																												
23.95 × 3	=	71.84																																																																																																												
22.95 × 12.93	=	296.65																																																																																																												
18.55 × 2.87	=	53.28																																																																																																												
0.5 × 8.33 × 12.55	=	52.24																																																																																																												
6 × 8.33	=	49.97																																																																																																												
Negative Arc	=	44.68																																																																																																												
Porte Cochere	182 Sq ft	<table style="width: 100%; border: none;"> <tr><td>14 × 13</td><td>=</td><td>182</td></tr> </table>	14 × 13	=	182																																																																																																									
14 × 13	=	182																																																																																																												

Building Sketch (Page - 3) 21-002758-02-01

Borrower	Eric Werner				
Property Address	1609 Noble Way				
City	Flower Mound	County	Denton	State	TX Zip Code 75022
Lender/Client	First United Bank				

TOTAL Sketch by a la mode, inc.

Area Calculations Summary

Non-living Area		
Stairs	99.8 Sq ft	$4 \times 4.45 = 17.8$ $8 \times 10.25 = 82$