

B.M. 'X' Base of concrete post
Assumed elev. 100.0'
Water elev. 98.1'

VILLAGE OF TWIN LAKES

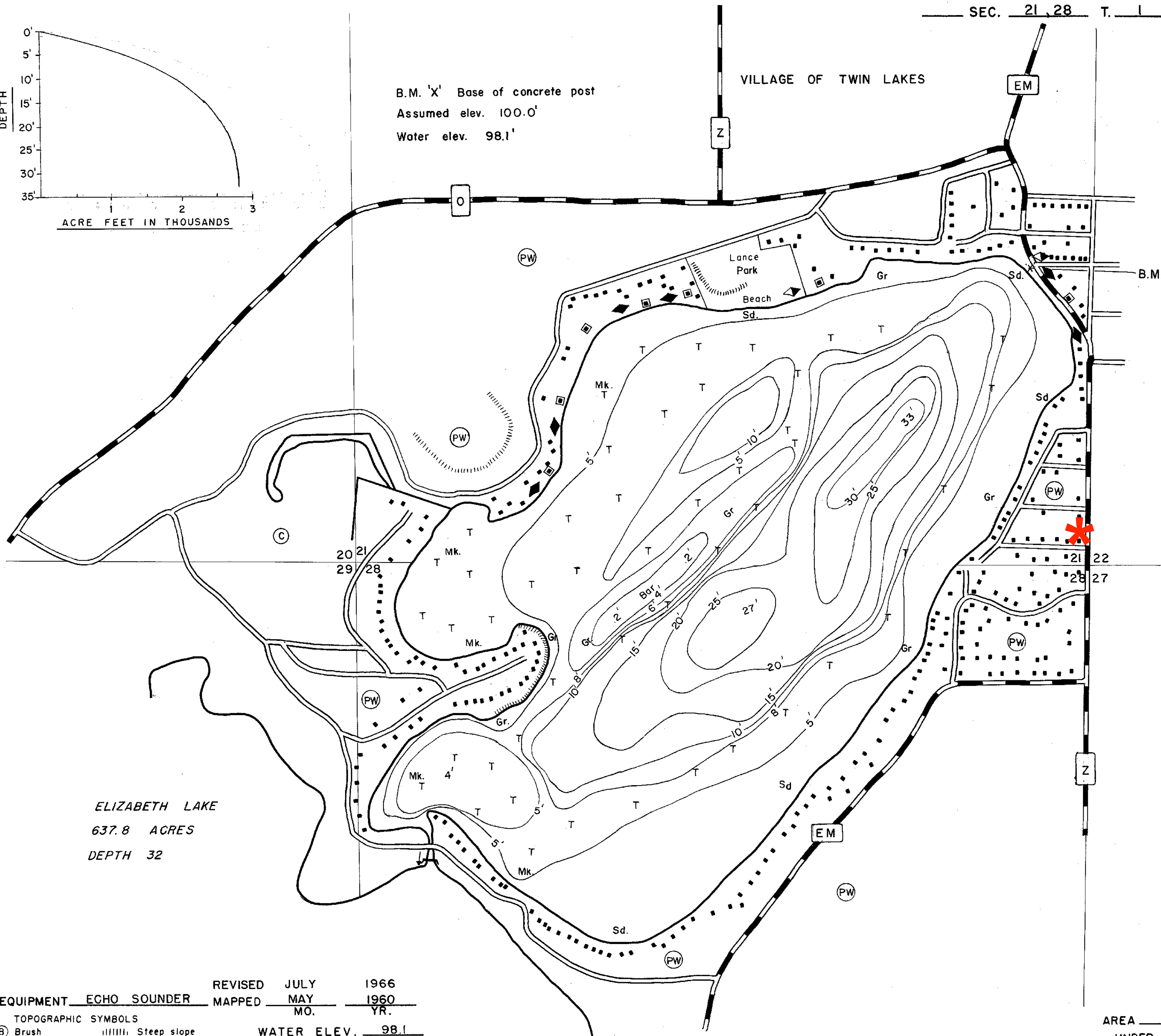

ELIZABETH LAKE
637.8 ACRES
DEPTH 32

EQUIPMENT ECHO SOUNDER MAPPED REVISIED JULY 1966
MAY 1960
MO. YR.

TOPOGRAPHIC SYMBOLS		LAKE BOTTOM SYMBOLS	
(B) Brush	Steep slope	P. Peat	Gr. Gravel
(PW) Partially wooded	~ Indefinite shoreline	Mk. Muck	R. Rubble
(W) Wooded	Marsh	C. Clay	Br. Bedrock
(C) Cleared	o Spring	M. Marl	T Submergent vegetation
(P) Pastured	~ Intermittent stream	Sd. Sand	↓ Emergent vegetation
(A) Agricultural	~ Permanent inlet	St. Silt	≡ Floating vegetation
B.M. Bench Mark	~ Permanent outlet		
■ Dwelling	⌋ Dam		
⊠ Resort			

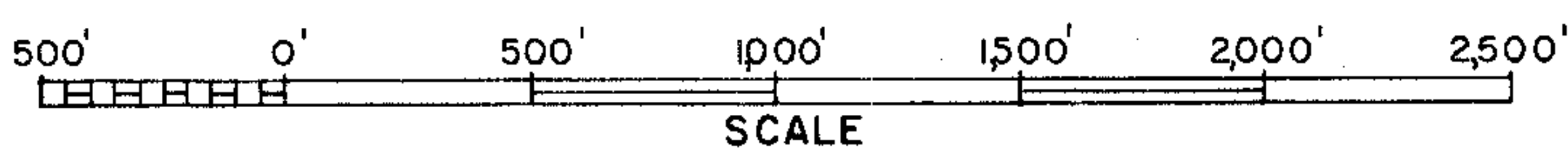

◇ Access ◆ Access with Parking ◆ Boat Livery
Field work by: F. Paulin Drawn by: C. Holt

SPECIES OF FISH		
	Abundant	Rare
Muskie		
N. Pike		X
Walleye		X
L.M. Bass	X	
S.M. Bass		X
Panfish	X	
Trout		

AREA 310.0 ACRES
UNDER 3FT. 20 %
OVER 20FT. 12.2 %
VOLUME 2,798.1 ACRE FT.
TOTAL ALK. 177 P.P.M.
SHORELINE 3.5 MILES
MAX. DEPTH 33 FEET

Source: Wisconsin Department of Natural Resources 608-266-2621
Lake Mary (Marie Lake, North Twin Lake) – Kenosha County, Wisconsin DNR Lake Map
Date - Jul 1966 - Historical Lake Map - Not for Navigation
A Public Document - Please Identify the Source when using it.